

**Supplemental Addendum**

File No. K0059877

Borrower	N/A				
Property Address	1503 Cherokee Blvd				
City	Knoxville	County	Knox	State	TN Zip Code 37919
Lender/Client	Rachael Wedekind				

**Measurements of 1503 Cherokee Blvd**

**Main Level 3090 sf**  
**2nd Level 648 sf**  
**2nd Level 447 sf**  
**Total Finished 4185 square feet**

**Accessory Dwelling Unit 473 sf (above garage)**  
**Garage 629 sf**  
**Unfinished Bathroom 2nd Level 211 sf**

The Square Footage-Method for Calculating: ANSI® Z765-2021 (American National Standards Institute®) Measuring Standard for calculating gross living area (GLA), and non-GLA areas of the subject property, was utilized in creating the sketch for this measurement report.



Signature \_\_\_\_\_  
 Name Charles Skalet  
 Date Signed 03/26/2024  
 State Certification # CR-2399 State TN  
 Or State License # \_\_\_\_\_ State \_\_\_\_\_

Signature \_\_\_\_\_  
 Name \_\_\_\_\_  
 Date Signed \_\_\_\_\_  
 State Certification # \_\_\_\_\_ State \_\_\_\_\_  
 Or State License # \_\_\_\_\_ State \_\_\_\_\_

### Building Sketch (Page - 1)

Borrower	N/A				
Property Address	1503 Cherokee Blvd				
City	Knoxville	County	Knox	State	TN
Lender/Client	Rachael Wedekind	Zip Code	37919		

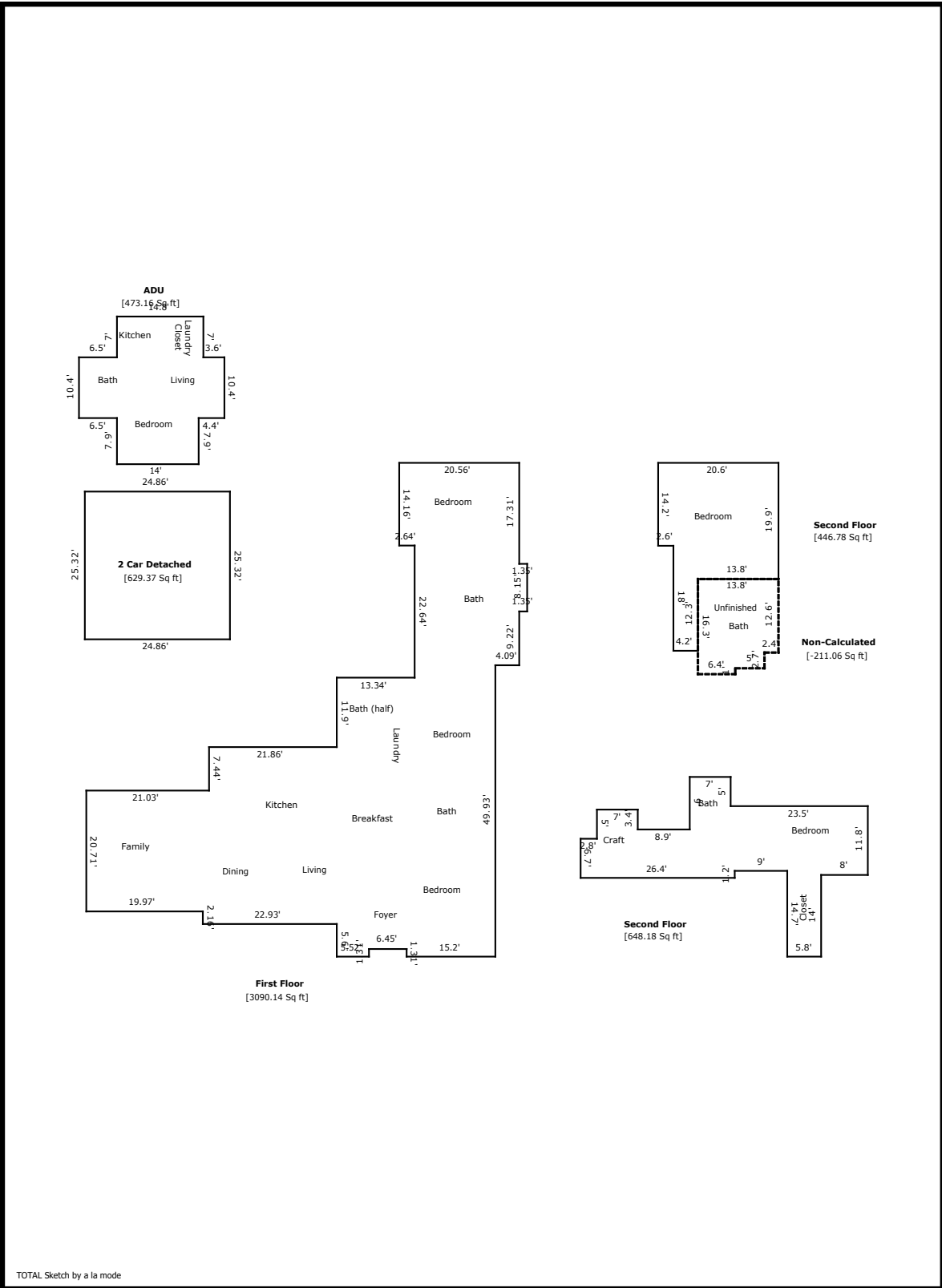

## Building Sketch (Page - 2)

Borrower	N/A				
Property Address	1503 Cherokee Blvd				
City	Knoxville	County	Knox	State	TN
				Zip Code	37919
Lender/Client	Rachael Wedekind				

TOTAL Sketch by a la mode

### Area Calculations Summary

Living Area	Calculation Details	
First Floor	3090.14 Sq ft	$8.15 \times 1.35 = 11.02$ $34.68 \times 4.1 = 142.03$ $84.61 \times 13.82 = 1169.69$ $47.81 \times 1.37 = 65.59$ $46.5 \times 6.45 = 299.98$ $47.81 \times 5.52 = 263.8$ $30.31 \times 21.86 = 662.71$ $22.87 \times 1.06 = 24.31$ $20.71 \times 19.97 = 413.6$ $14.16 \times 2.64 = 37.41$
Second Floor	446.78 Sq ft	$19.9 \times 13.8 = 274.62$ $6.8 \times 14.2 = 96.56$ $4.2 \times 18 = 75.6$
Second Floor	648.18 Sq ft	$7 \times 5 = 35$ $11.8 \times 8 = 94.4$ $6.7 \times 2.8 = 18.76$ $11.7 \times 7 = 81.9$ $8.3 \times 8.9 = 73.87$ $12.3 \times 7.7 = 94.71$ $11.1 \times 9 = 99.9$ $5.8 \times 25.8 = 149.64$
<b>Total Living Area (Rounded):</b>	<b>4185 Sq ft</b>	
<b>Non-living Area</b>		
2 Car Detached	629.37 Sq ft	$24.86 \times 25.32 = 629.37$
ADU	473.16 Sq ft	$14.8 \times 7 = 103.6$ $14 \times 7.9 = 110.6$ $10.4 \times 24.9 = 258.96$

## Subject Photo Page

Borrower	N/A				
Property Address	1503 Cherokee Blvd				
City	Knoxville	County	Knox	State	TN
				Zip Code	37919
Lender/Client	Rachael Wedekind				



### Subject Front

1503 Cherokee Blvd  
 Sales Price  
 Gross Living Area 4,185  
 Total Rooms 10  
 Total Bedrooms 5  
 Total Bathrooms 3.1  
 Location  
 View  
 Site  
 Quality  
 Age 75

### Subject Rear



### Subject Street