

INVOICE

FROM:

Advanced Appraisal Services
 PO Box 11373
 Knoxville, TN 37939-1373

Telephone Number: (865) 588-4008 Fax Number:

TO:

Jade Kloss

E-Mail:
 Telephone Number: Fax Number:
 Alternate Number:

INVOICE NUMBER

0058970

DATES

Invoice Date: 10/18/2023
 Due Date:

REFERENCE

Internal Order #: 0058970
 Lender Case #:
 Client File #:
 FHA/VA Case #:
 Main File # on form: 0058970
 Other File # on form:
 Federal Tax ID: 30-0830665
 Employer ID:

DESCRIPTION

Lender: N/A Client: Jade Kloss
 Purchaser/Borrower: N/A
 Property Address: 3629 Taliluna Ave
 City: Knoxville
 County: Knox State: TN Zip: 37919
 Legal Description: Talahi Block L Lot 17

FEES

AMOUNT

Exterior Measurement	75.00
SUBTOTAL	75.00

PAYMENTS

AMOUNT

Check #:	Date:	Description:	
Check #:	Date:	Description:	
Check #:	Date:	Description:	
SUBTOTAL			
TOTAL DUE			\$ 75.00

Supplemental Addendum

File No. 0058970

Borrower	N/A		
Property Address	3629 Taliluna Ave		
City	Knoxville	County	Knox
Lender/Client	Jade Kloss	State	TN
		Zip Code	37919

Measurements of 3629 Taliluna Ave

1st Floor	2062 sq ft
Total Gross Living Area	2062 sq ft
Finished Basement	912 sq ft
Unfinished Basement	199 sq ft

The Square Footage-Method for Calculating: ANSI® Z765-2021 (American National Standards Institute®) Measuring Standard for calculating gross living area (GLA), and non-GLA areas of the subject property, was utilized in creating the sketch for this measurement report.

Signature _____
Name Charles Skalet
Date Signed _____
State Certification # CR-2399 State TN
Or State License # _____ State _____

Signature _____
Name _____
Date Signed _____
State Certification # _____ State _____
Or State License # _____ State _____

Subject Photo Page

Borrower	N/A						
Property Address	3629 Taililuna Ave						
City	Knoxville	County	Knox	State	TN	Zip Code	37919
Lender/Client	Jade Kloss						



Subject Front

3629 Taililuna Ave

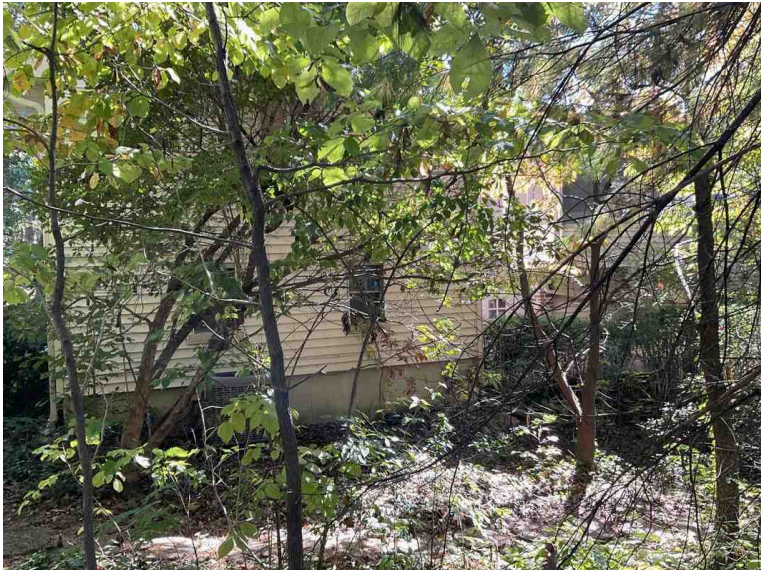

Subject Rear



Subject Street

Building Sketch

Borrower	N/A			
Property Address	3629 Taliluna Ave			
City	Knoxville	County Knox	State TN	Zip Code 37919
Lender/Client	Jade Kloss			

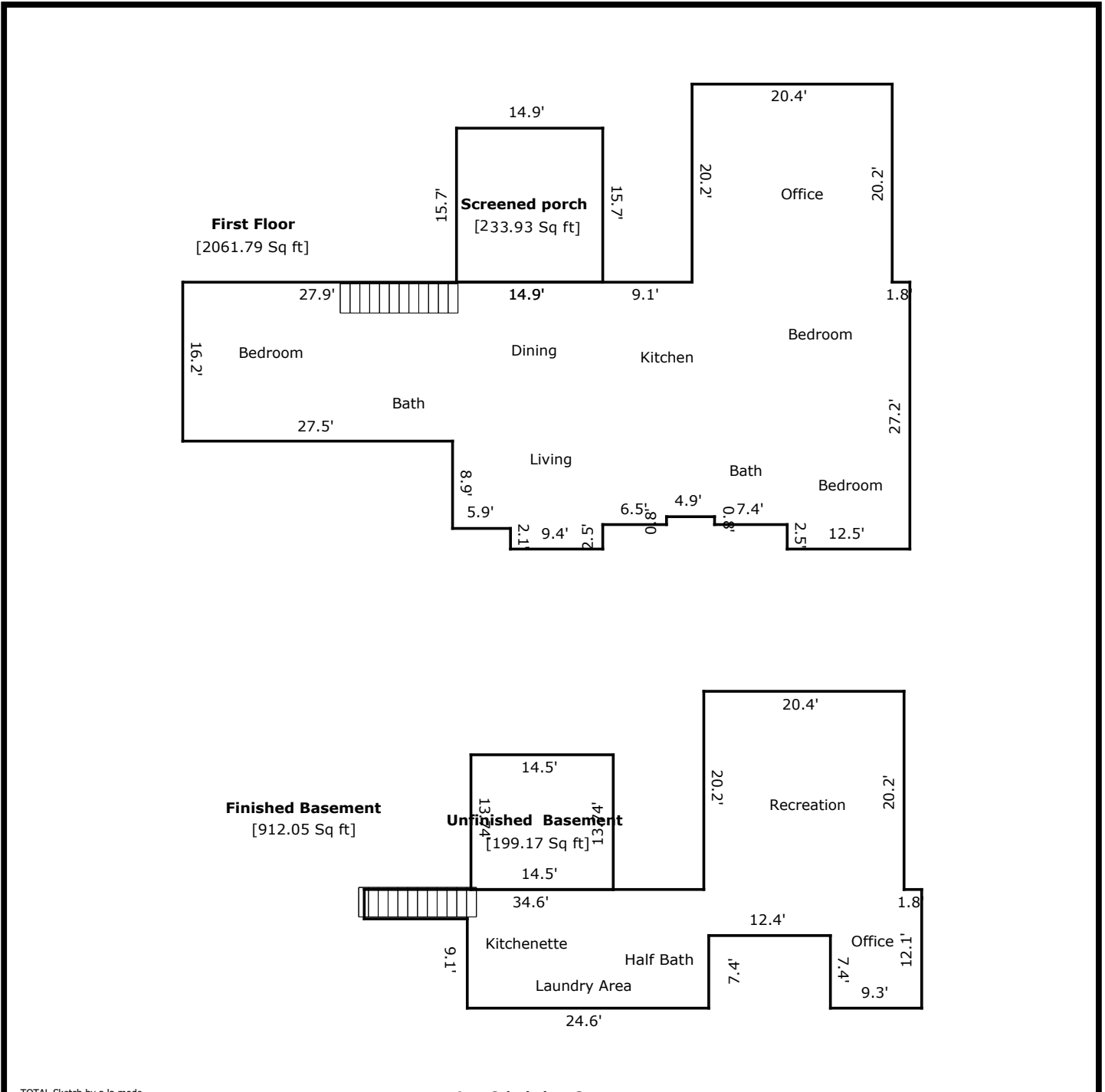

TOTAL Sketch by a la mode

Area Calculations Summary

Living Area	Calculation Details	
First Floor	2061.79 Sq ft	20.4 × 20.2 = 412.08 16.2 × 27.5 = 445.5 46.6 × 23.9 = 1113.74 3.3 × 12.5 = 41.25 0.8 × 7.4 = 5.92 9.4 × 2.1 = 19.74 0.8 × 6.5 = 5.2 1.2 × 15.3 = 18.36
Total Living Area (Rounded):	2062 Sq ft	
Non-living Area		
Screened porch	233.93 Sq ft	15.7 × 14.9 = 233.93
Unfinished Basement	199.17 Sq ft	14.5 × 13.74 = 199.17
Finished Basement	912.05 Sq ft	20.4 × 20.2 = 412.08 12.1 × 9.3 = 112.53 4.7 × 12.4 = 58.28 12.1 × 24.6 = 297.66 3 × 10.5 = 31.5