

# INVOICE

**FROM:**

Advanced Appraisal Services  
 Advanced Appraisal Services  
 PO Box 11373  
 Knoxville, TN 37939-1373

Telephone Number: (865) 588-4008

Fax Number:

**TO:**

The Holli McCray Group

Knoxville, TN

E-Mail: verdeaux@kw.com

Telephone Number: (865) 851-0181

Fax Number:

Alternate Number:

**INVOICE NUMBER**

0057160

**DATES**

Invoice Date: 01/12/2023

Due Date: 01/11/2023

**REFERENCE**

Internal Order #: 0057160

Lender Case #:

Client File #:

FHA/VA Case #:

Main File # on form: 0057160

Other File # on form: 0057160

Federal Tax ID: 62-1867763

Employer ID:

**DESCRIPTION**

<b>Lender:</b> The Holli McCray Group	<b>Client:</b> The Holli McCray Group
<b>Purchaser/Borrower:</b> The Holli McCray Group	
<b>Property Address:</b> 7953 Pelleaux	
<b>City:</b> Knoxville	
<b>County:</b> Knox	<b>State:</b> TN <b>Zip:</b> 37932
<b>Legal Description:</b>	

**FEES**

**AMOUNT**

Measurement interior	75.00 0.00
<b>SUBTOTAL</b>	75.00

**PAYMENTS**

**AMOUNT**

<b>Check #:</b>	<b>Date:</b>	<b>Description:</b>	
<b>Check #:</b>	<b>Date:</b>	<b>Description:</b>	
<b>Check #:</b>	<b>Date:</b>	<b>Description:</b>	
<b>SUBTOTAL</b>			0

**TOTAL DUE** \$ 75.00

# Supplemental Addendum

File No. 0057160

Borrower	The Holli McCray Group						
Property Address	7953 Pelleaux						
City	Knoxville	County	Knox	State	TN	Zip Code	37932
Lender/Client	The Holli McCray Group						

**7953 Pelleaux- 1953 sq ft**

**1st Level- 1646 sq ft**

**Living 19 x 16**

**Main Bed 14 x 12**

**Main Bath 9 x 7**

**Bed 2 12 x 10**

**Bed 3 12 x 10**

**Bath 8 x 7**

**Kitchen 20 x 12**

**Dining 13 x 8**

**Pantry 12 x 5**

**Laundry 8 x 7**

**2nd Level- 307 sq ft**

**Bonus 23 x 12**

Signature \_\_\_\_\_  
Name Jeremy Skalet  
Date Signed \_\_\_\_\_  
State Certification # 3215 State TN  
Or State License # \_\_\_\_\_ State \_\_\_\_\_

Signature \_\_\_\_\_  
Name \_\_\_\_\_  
Date Signed \_\_\_\_\_  
State Certification # \_\_\_\_\_ State \_\_\_\_\_  
Or State License # \_\_\_\_\_ State \_\_\_\_\_

## Subject Photo Page

Borrower	The Holli McCray Group						
Property Address	7953 Pelleaux						
City	Knoxville	County	Knox	State	TN	Zip Code	37932
Lender/Client	The Holli McCray Group						



### Subject Front

7953 Pelleaux

1,953



### Subject Rear

### Subject Street

## Building Sketch

Borrower	The Holli McCray Group			
Property Address	7953 Pelleaux			
City	Knoxville	County	Knox	State TN      Zip Code 37932
Lender/Client	The Holli McCray Group			

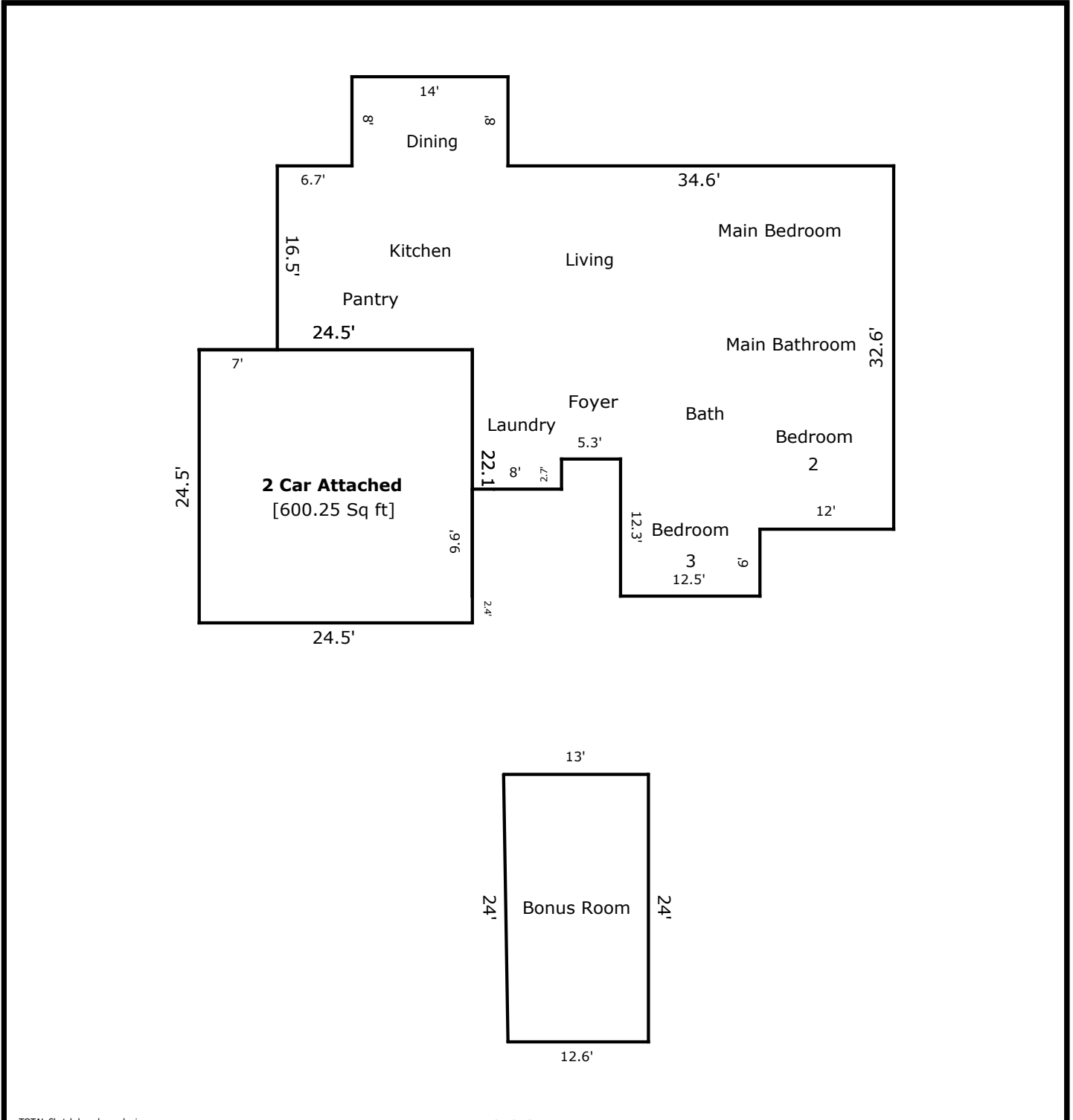

TOTAL Sketch by a la mode, inc.

### Area Calculations Summary

Living Area	Area	Calculation Details
First Floor	1645.84 Sq ft	$14 \times 8 = 112$ $16.5 \times 17.5 = 288.75$ $37.8 \times 26.3 = 994.14$ $12.3 \times 12.5 = 153.75$ $6.3 \times 12 = 75.6$ $2.7 \times 8 = 21.6$
Second Floor	307.2 Sq ft	$24 \times 12.6 = 302.4$ $0.5 \times 24 \times 0.4 = 4.8$
<b>Total Living Area (Rounded):</b>	<b>1953 Sq ft</b>	
<b>Non-living Area</b>		
2 Car Attached	600.25 Sq ft	$24.5 \times 24.5 = 600.25$