

INVOICE

FROM:

Advanced Appraisal Services
 Advanced Appraisal Services
 PO Box 11373
 Knoxville, TN 37939-1373

Telephone Number: (865) 588-4008

Fax Number:

TO:

Mike Barlow

E-Mail:

Telephone Number:

Fax Number:

Alternate Number:

INVOICE NUMBER

0057082

DATES

Invoice Date: 12/30/2022

Due Date: 12/30/2022

REFERENCE

Internal Order #: 0057082

Lender Case #:

Client File #:

FHA/VA Case #:

Main File # on form: 0057082

Other File # on form: 0057082

Federal Tax ID: 62-1867763

Employer ID:

DESCRIPTION

Lender: Mike Barlow

Client: Mike Barlow

Purchaser/Borrower: Mike Barlow

Property Address: 6912 Deane Hill

City: Knoxville

County: Knox

State: TN

Zip: 37919

Legal Description:

FEES

AMOUNT

Measurement
Interior

75.00
0.00

SUBTOTAL 75.00

PAYMENTS

AMOUNT

Check #: Date: Description:
 Check #: Date: Description:
 Check #: Date: Description:

SUBTOTAL 0

TOTAL DUE \$ 75.00

Subject Photo Page

Borrower	Mike Barlow						
Property Address	6912 Deane Hill						
City	Knoxville	County	Knox	State	TN	Zip Code	37919
Lender/Client	Mike Barlow						



Subject Front

6912 Deane Hill
Sales Price
Gross Living Area
Total Rooms
Total Bedrooms
Total Bathrooms
Location
View
Site
Quality
Age



Subject Rear

Supplemental Addendum

File No. 0057082

Borrower	Mike Barlow		
Property Address	6912 Deane Hill		
City	Knoxville	County	Knox
		State	TN
		Zip Code	37919
Lender/Client	Mike Barlow		

6912 Deane Hill Dr- 1839 sq ft

1st Level- 1249 sq ft

Basement- 590 sq ft

Garage- 512 sq ft

Signature _____
Name Jeremy Skalet
Date Signed _____
State Certification # 3215 State TN
Or State License # _____ State _____

Signature _____
Name _____
Date Signed _____
State Certification # _____ State _____
Or State License # _____ State _____

Building Sketch

Borrower	Mike Barlow			
Property Address	6912 Deane Hill			
City	Knoxville	County Knox	State TN	Zip Code 37919
Lender/Client	Mike Barlow			

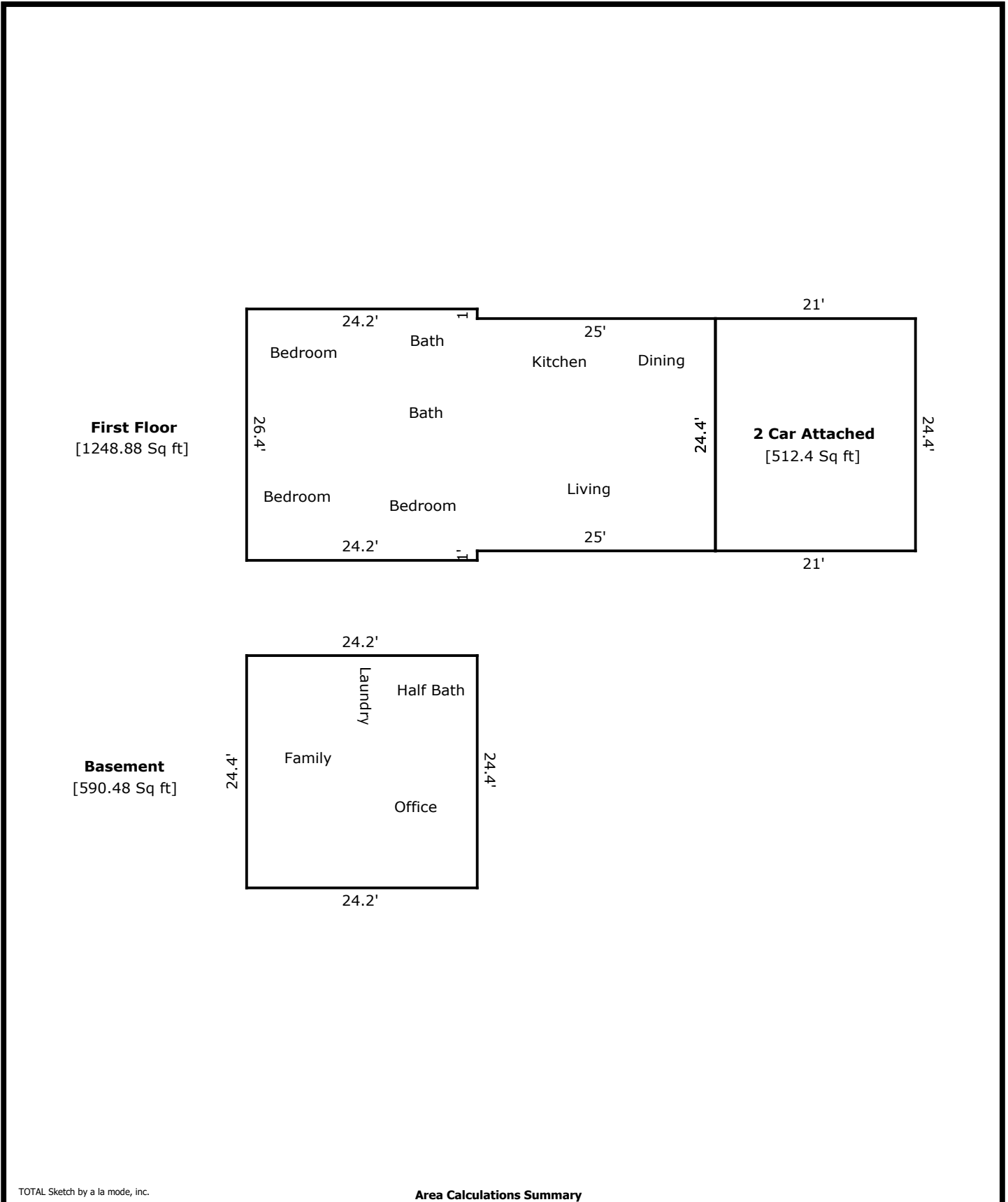

TOTAL Sketch by a la mode, inc.

Area Calculations Summary

Living Area	Calculation Details	
First Floor	1248.88 Sq ft	26.4 × 24.2 = 638.88 25 × 24.4 = 610
Basement	590.48 Sq ft	24.2 × 24.4 = 590.48
Total Living Area (Rounded):	1839 Sq ft	
Non-living Area		
2 Car Attached	512.4 Sq ft	21 × 24.4 = 512.4