

INVOICE

FROM:

Advanced Appraisal Services
 Advanced Appraisal Services
 PO Box 11373
 Knoxville, TN 37939-1373

Telephone Number: (865) 588-4008

Fax Number:

TO:

Gary Harwell
 140 Major Reynolds Place
 Knoxville, TN

E-Mail: gary.harwell@coldwellbanker.com

Telephone Number: (865) 851-0181

Fax Number:

Alternate Number:

INVOICE NUMBER

0057120

DATES

Invoice Date: 01/05/2023

Due Date: 01/05/2023

REFERENCE

Internal Order #: 0057120

Lender Case #:

Client File #:

FHA/VA Case #:

Main File # on form: 0057120

Other File # on form: 0057120

Federal Tax ID: 62-1867763

Employer ID:

DESCRIPTION

Lender: Gary Harwell	Client: Gary Harwell
Purchaser/Borrower: Gary Harwell	
Property Address: 6700 Ridgerock	
City: Knoxville	
County:	State: TN Zip: 37909
Legal Description:	

FEES

AMOUNT

Measurement	75.00
Interior Dimensions	25.00

SUBTOTAL 100.00

PAYMENTS

AMOUNT

Check #:	Date:	Description:
Check #:	Date:	Description:
Check #:	Date:	Description:

SUBTOTAL 0

TOTAL DUE \$ 100.00

Supplemental Addendum

File No. 0057120

Borrower	Gary Harwell				
Property Address	6700 Ridgerock				
City	Knoxville	County	State	TN	Zip Code 37909
Lender/Client	Gary Harwell				

6700 Ridgerock- 1714 sq ft

- Kitchen 14 x 14**
- Living/Dining 27 x 13**
- Laundry 8 x 7**
- Bed 2 13 x 11**
- Bath 2 10 x 8**
- Main Bed 17 x 14**
- Main Bath 17 x 10**
- Main Closet 12 x 10**

Signature _____
Name Jeremy Skalet
Date Signed _____
State Certification # 3215 State TN
Or State License # _____ State _____

Signature _____
Name _____
Date Signed _____
State Certification # _____ State _____
Or State License # _____ State _____

Subject Photo Page

Borrower	Gary Harwell				
Property Address	6700 Ridgerock				
City	Knoxville	County	State	TN	Zip Code 37909
Lender/Client	Gary Harwell				



Subject Front

6700 Ridgerock



Subject Rear

Subject Street

Building Sketch

Borrower	Gary Harwell			
Property Address	6700 Ridgerock			
City	Knoxville	County	State	TN
Lender/Client	Gary Harwell			
			Zip Code	37909

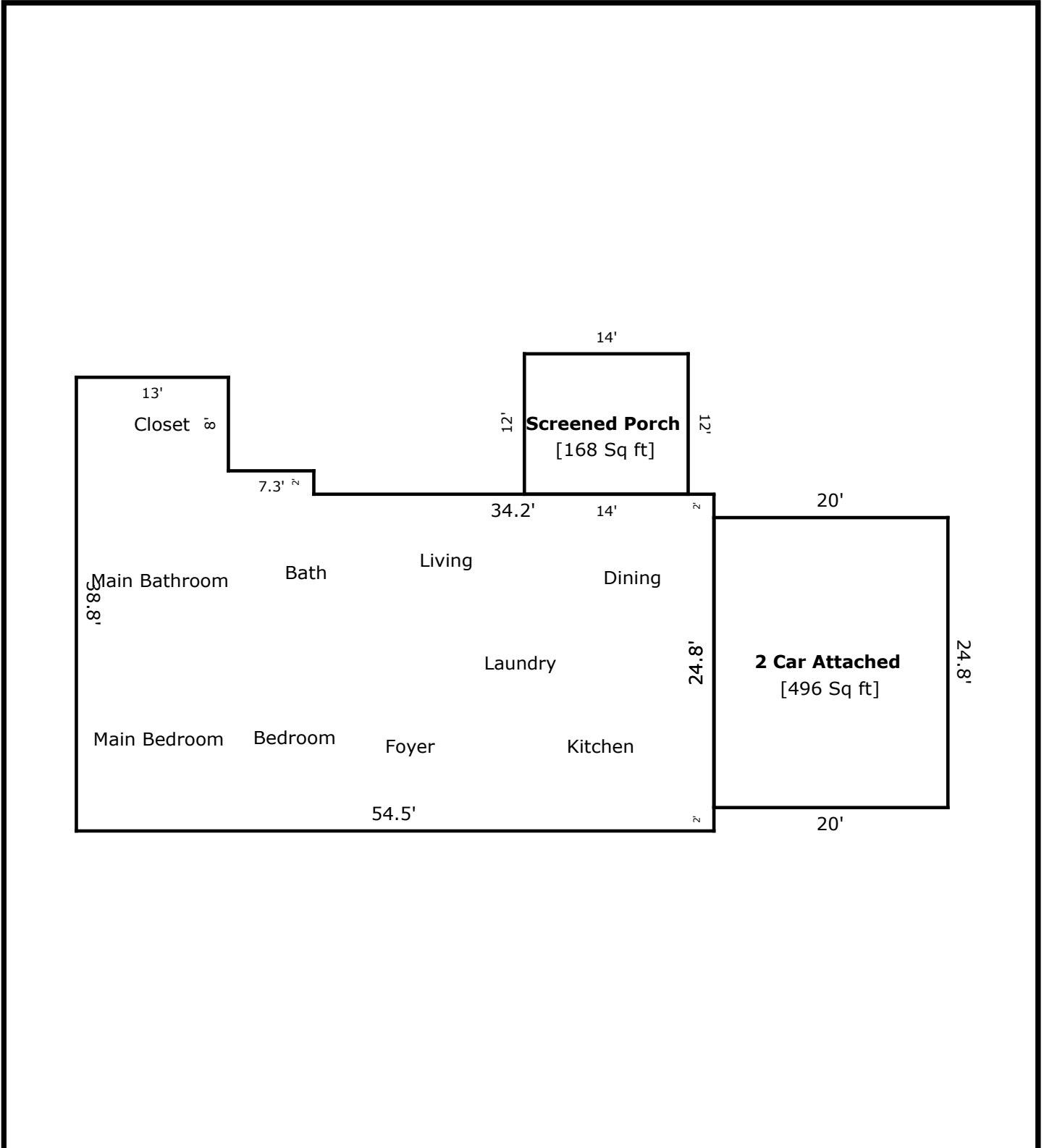

TOTAL Sketch by a la mode, inc.

Area Calculations Summary

Living Area	Calculation Details	
First Floor	1714.2 Sq ft	28.8 × 34.2 = 984.96 20.3 × 30.8 = 625.24 13 × 8 = 104
Total Living Area (Rounded):	1714 Sq ft	
Non-living Area		
Screened Porch	168 Sq ft	14 × 12 = 168
2 Car Attached	496 Sq ft	20 × 24.8 = 496