

Supplemental Addendum

File No. 0056699

Borrower	Ryan R Miller				
Property Address	1932 Stony Point Rd				
City	Knoxville	County	Knox	State	TN
				Zip Code	37914
Lender/Client					

Measurements of 1932 Stony Point Rd

1st Floor **1727 square feet**
Finished Basement **1301 square feet**
Total Finished **3028 square feet**

Unfinished Basement **402 square feet**

The Square Footage-Method for Calculating: ANSI® Z765-2021 (American National Standards Institute®) Measuring Standard for calculating gross living area (GLA), and non-GLA areas of the subject property, was utilized in creating the sketch for this measurement report.

Signature 
Name Charles Skalet
Date Signed 10/25/2022
State Certification # CR-2399 State TN
Or State License # _____ State _____

Signature _____
Name _____
Date Signed _____
State Certification # _____ State _____
Or State License # _____ State _____

Subject Photo Page

Borrower	Ryan R Miller				
Property Address	1932 Stony Point Rd				
City	Knoxville	County	Knox	State	TN
Lender/Client				Zip Code	37914



Subject Front

- Sales Price
- Gross Living Area
- Total Rooms
- Total Bedrooms
- Total Bathrooms
- Location
- View
- Site
- Quality
- Age



Subject Rear



Subject Garage

Building Sketch

Borrower	Ryan R Miller			
Property Address	1932 Stony Point Rd			
City	Knoxville	County	Knox	State TN Zip Code 37914
Lender/Client				

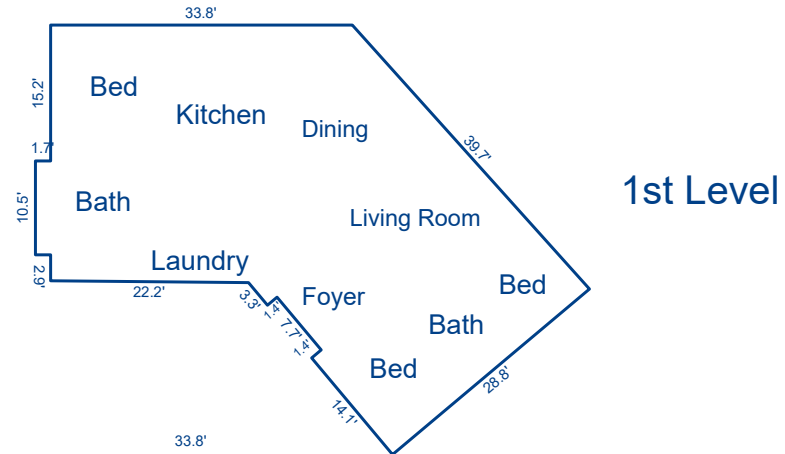
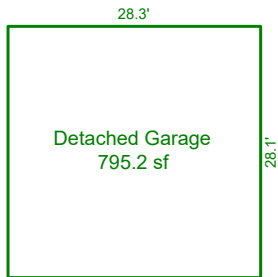

1st Level

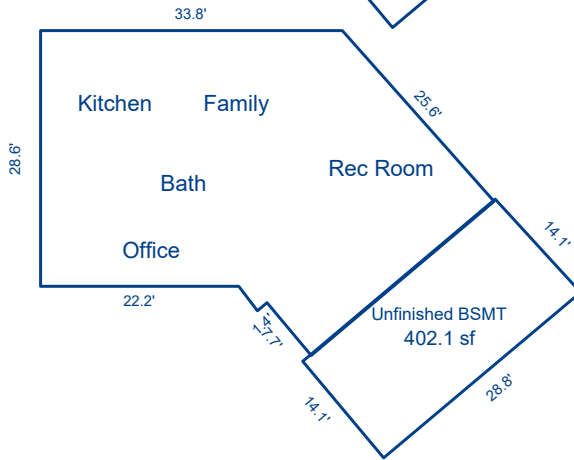

Basement

Sketch by Apex Sketch

AREA CALCULATIONS SUMMARY						AREA CALCULATIONS BREAKDOWN				
Code	Description	Factor	Net Size	Perimeter	Net Totals	Name	Base x	Height x	Width =	Area
GLA1	First Floor	1.0	1726.7	184.4	1726.7	First Floor		10.5 x	1.7 =	17.8
BSMT	Unfinished BSMT	1.0	402.1	85.2			0.5 x	33.8 x	0.3 =	5.3
	Finished BSMT	1.0	1301.4	149.5	1703.5			28.6 x	22.2 =	634.1
GAR	Detached Garag	1.0	795.2	112.8	795.2		0.5 x	32.6 x	16.8 =	273.4
								21.4 x	17.9 =	384.2
							0.5 x	7.0 x	3.5 =	12.2
							0.5 x	19.3 x	9.5 =	92.3
							0.5 x	1.8 x	0.9 =	0.8
								2.1 x	1.4 =	2.9
								14.7 x	7.0 =	103.3
							0.5 x	21.4 x	10.7 =	114.5
							0.5 x	15.8 x	7.9 =	62.2
							0.5 x	28.6 x	0.3 =	3.8
								14.1 x	1.4 =	19.7
	Net LIVABLE	cnt	1 (rounded)		1,727	14 total items			(rounded)	1,727