



**Supplemental Addendum**

File No. 0056383

Borrower	The Holli McCray Group			
Property Address	911 E Inskip			
City	Knoxville	County	State	TN Zip Code 37918
Lender/Client	The Holli McCray Group			

**911 E Inskip- 2174**

- Living 19 x 13**
- Dining 12 x 12**
- Sun Room 11 x 6**
- Kitchen 17 x 11**
- Bed 2 13 x 12**
- Bed 3 13 x 12**
- Bath 2 13 x 8**
- Laundry 8 x 6**
- Bath 3 8 x 5**
- Family 19 x 12**
- Main Bed 19 x 11**
- Main Bath 8 x 5**

Signature \_\_\_\_\_  
Name Jeremy Skalet  
Date Signed \_\_\_\_\_  
State Certification # 3215 State TN  
Or State License # \_\_\_\_\_ State \_\_\_\_\_

Signature \_\_\_\_\_  
Name \_\_\_\_\_  
Date Signed \_\_\_\_\_  
State Certification # \_\_\_\_\_ State \_\_\_\_\_  
Or State License # \_\_\_\_\_ State \_\_\_\_\_

## Subject Photo Page

Borrower	The Holli McCray Group				
Property Address	911 E Inskip				
City	Knoxville	County	State	TN	Zip Code 37918
Lender/Client	The Holli McCray Group				



### Subject Front

911 E Inskip  
Sales Price  
Gross Living Area 2,175  
Total Rooms  
Total Bedrooms  
Total Bathrooms  
Location  
View  
Site  
Quality  
Age



### Subject Rear

### Subject Street

## Building Sketch

Borrower	The Holli McCray Group			
Property Address	911 E Inskip			
City	Knoxville	County	State	TN      Zip Code 37918
Lender/Client	The Holli McCray Group			

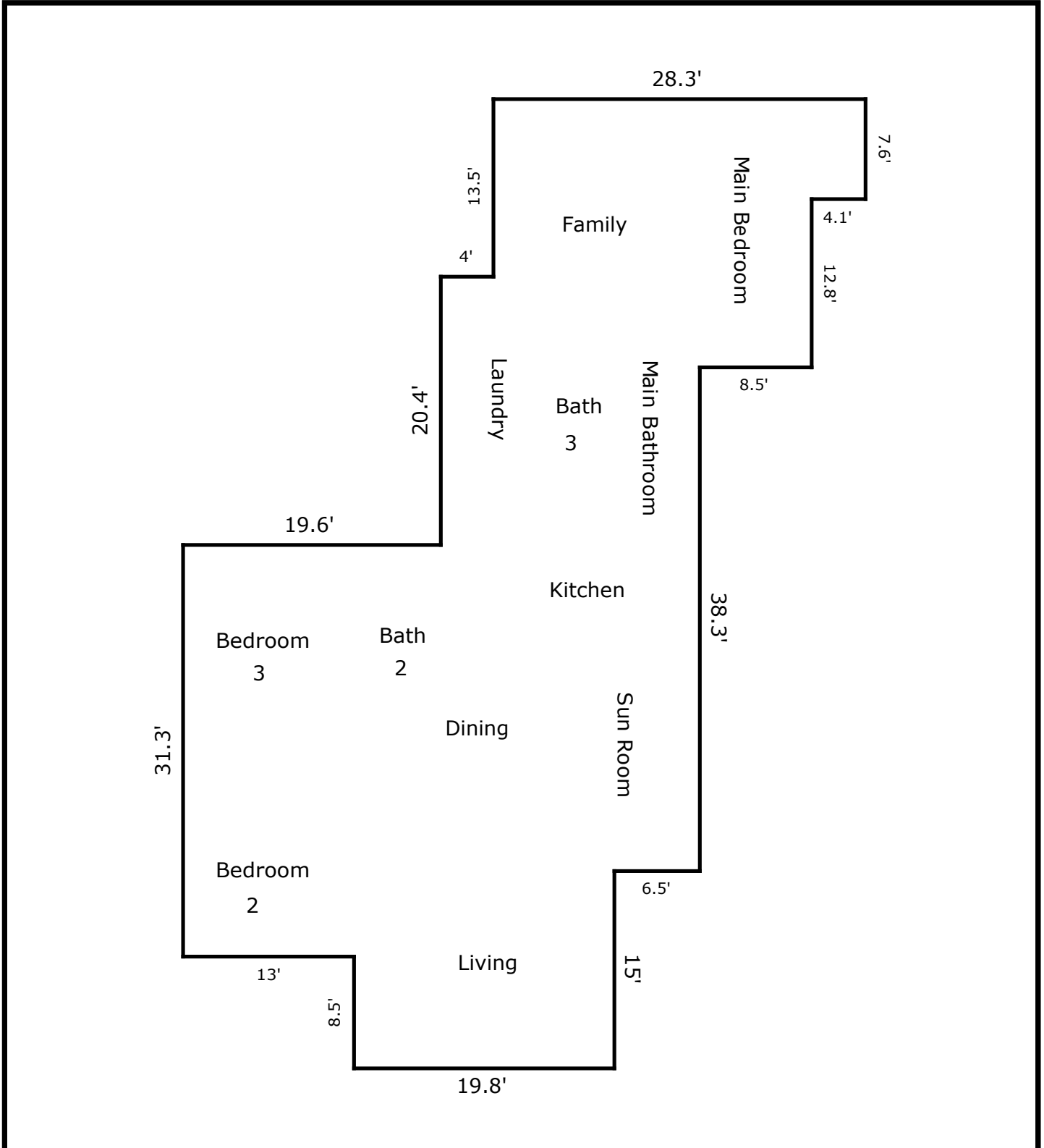

TOTAL Sketch by a la mode, inc.

### Area Calculations Summary

Living Area	Calculation Details	
First Floor	2174.53 Sq ft	7.6 × 4.1 = 31.16
		24.2 × 13.5 = 326.7
		6.9 × 8.5 = 58.65
		19.7 × 20.4 = 401.88
		39.3 × 24.8 = 974.64
		15 × 19.8 = 297
		13 × 6.5 = 84.5
<b>Total Living Area (Rounded):</b>	<b>2175 Sq ft</b>	