

INVOICE

FROM:

Advanced Appraisal Services
 Advanced Appraisal Services
 PO Box 11373
 Knoxville, TN 37939-1373

Telephone Number: (865) 588-4008 Fax Number:

TO:

The Holli McCray Group

Knoxville, TN

E-Mail: verdeaux@kw.com

Telephone Number: (865) 851-0181 Fax Number:

Alternate Number:

INVOICE NUMBER

0056446

DATES

Invoice Date: 09/15/2022

Due Date: 09/15/2022

REFERENCE

Internal Order #: 0056446

Lender Case #:

Client File #:

FHA/VA Case #:

Main File # on form: 0056446

Other File # on form: 0056446

Federal Tax ID: 62-1867763

Employer ID:

DESCRIPTION

Lender: The Holli McCray Group	Client: The Holli McCray Group
Purchaser/Borrower: The Holli McCray Group	
Property Address: 1353 Misty Mead Dr	
City: Sevierville	
County: Knox	State: TN Zip: 37876
Legal Description:	

FEES

AMOUNT

Measurement	75.00
interior	0.00

SUBTOTAL 75.00

PAYMENTS

AMOUNT

Check #:	Date:	Description:	
Check #:	Date:	Description:	
Check #:	Date:	Description:	

SUBTOTAL 0

TOTAL DUE \$ 75.00

Supplemental Addendum

File No. 0056446

Borrower	The Holli McCray Group						
Property Address	1353 Misty Mead Dr						
City	Sevierville	County	Knox	State	TN	Zip Code	37876
Lender/Client	The Holli McCray Group						

1353 Misty Mead Dr- 1706 sq ft

Living 25 x 16
Dining 11 x 9
Kitchen 15 x 11
Laundry 6 x 5
Main Bed 15 x 14
Main Bath 12 x 5
Bed 2 13 x 13
Bath 9 x 5
Bed 3 13 x 13

Signature _____
Name Jeremy Skalet
Date Signed _____
State Certification # 3215 State TN
Or State License # _____ State _____

Signature _____
Name _____
Date Signed _____
State Certification # _____ State _____
Or State License # _____ State _____

Building Sketch

Borrower	The Holli McCray Group				
Property Address	1353 Misty Mead Dr				
City	Sevierville	County	Knox	State	TN
Lender/Client	The Holli McCray Group				
				Zip Code	37876

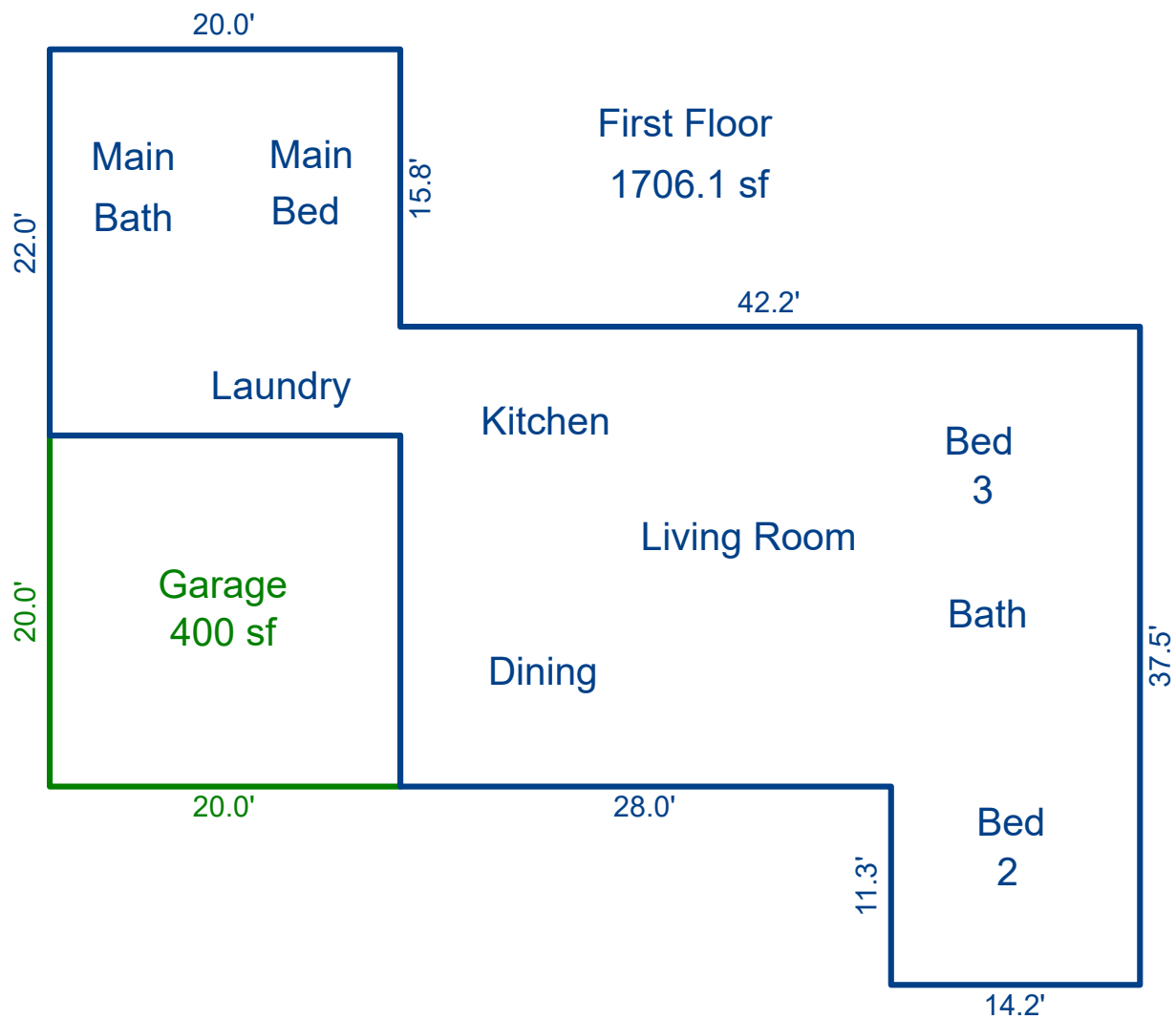

Sketch by Apex Sketch

AREA CALCULATIONS SUMMARY						AREA CALCULATIONS BREAKDOWN				
Code	Description	Factor	Net Size	Perimeter	Net Totals	Name	Base x	Height x	Width =	Area
GLA1	First Floor	1.0	1706.1	231.0	1706.1	First Floor		37.5 x	14.2 =	532.5
GAR	Garage	1.0	400.0	80.0	400.0			28.0 x	26.2 =	733.6
								22.0 x	20.0 =	440.0
	Net LIVABLE	cnt	1 (rounded)		1,706	3 total items			(rounded)	1,706