

INVOICE

FROM:

Advanced Appraisal Services
 Advanced Appraisal Services
 PO Box 11373
 Knoxville, TN 37939-1373

Telephone Number: (865) 588-4008

Fax Number:

TO:

The Holli McCray Group

Knoxville, TN

E-Mail: verdeaux@kw.com

Telephone Number: (865) 851-0181

Fax Number:

Alternate Number:

INVOICE NUMBER

0056277

DATES

Invoice Date: 08/23/2022

Due Date: 08/23/2022

REFERENCE

Internal Order #: 0056277

Lender Case #:

Client File #:

FHA/VA Case #:

Main File # on form: 0056277

Other File # on form: 0056277

Federal Tax ID: 62-1867763

Employer ID:

DESCRIPTION

Lender: The Holli McCray Group **Client:** The Holli McCray Group
Purchaser/Borrower: The Holli McCray Group
Property Address: 3515 Plumwood
City: Knoxville
County: Knox **State:** TN **Zip:** 37932
Legal Description:

FEES

AMOUNT

Measurement	75.00
interior	0.00

SUBTOTAL 75.00

PAYMENTS

AMOUNT

Check #:	Date:	Description:	
Check #:	Date:	Description:	
Check #:	Date:	Description:	

SUBTOTAL 0

TOTAL DUE \$ 75.00

Supplemental Addendum

File No. 0056277

Borrower	The Holli McCray Group		
Property Address	3515 Plumwood		
City	Knoxville	County	Knox
		State	TN
		Zip Code	37932
Lender/Client	The Holli McCray Group		

3515 Plumwood- 2742 sq ft

1st Level- 2075 sq ft

- Living 25 x 22**
- Kitchen 20 x 12**
- Dining 20 x 13**
- Bath 2 10 x 7**
- Bed 2 11 x 9**
- Bed 3 14 x 11**
- Sun Room 21 x 12**
- Bed 4 13 x 10**
- Half Bath 4 x 4**

Basement- 667 sq ft

- Main Bed 21 x 12**
- Main Bath 11 x 9**
- Closet/Office 12 x 11**

Signature _____
Name Jeremy Skalet
Date Signed _____
State Certification # 3215 State TN
Or State License # _____ State _____

Signature _____
Name _____
Date Signed _____
State Certification # _____ State _____
Or State License # _____ State _____

Subject Photo Page

Borrower	The Holli McCray Group						
Property Address	3515 Plumwood						
City	Knoxville	County	Knox	State	TN	Zip Code	37932
Lender/Client	The Holli McCray Group						



Subject Front

3515 Plumwood



Subject Rear

Subject Street

Building Sketch

Borrower	The Holli McCray Group			
Property Address	3515 Plumwood			
City	Knoxville	County Knox	State TN	Zip Code 37932
Lender/Client	The Holli McCray Group			

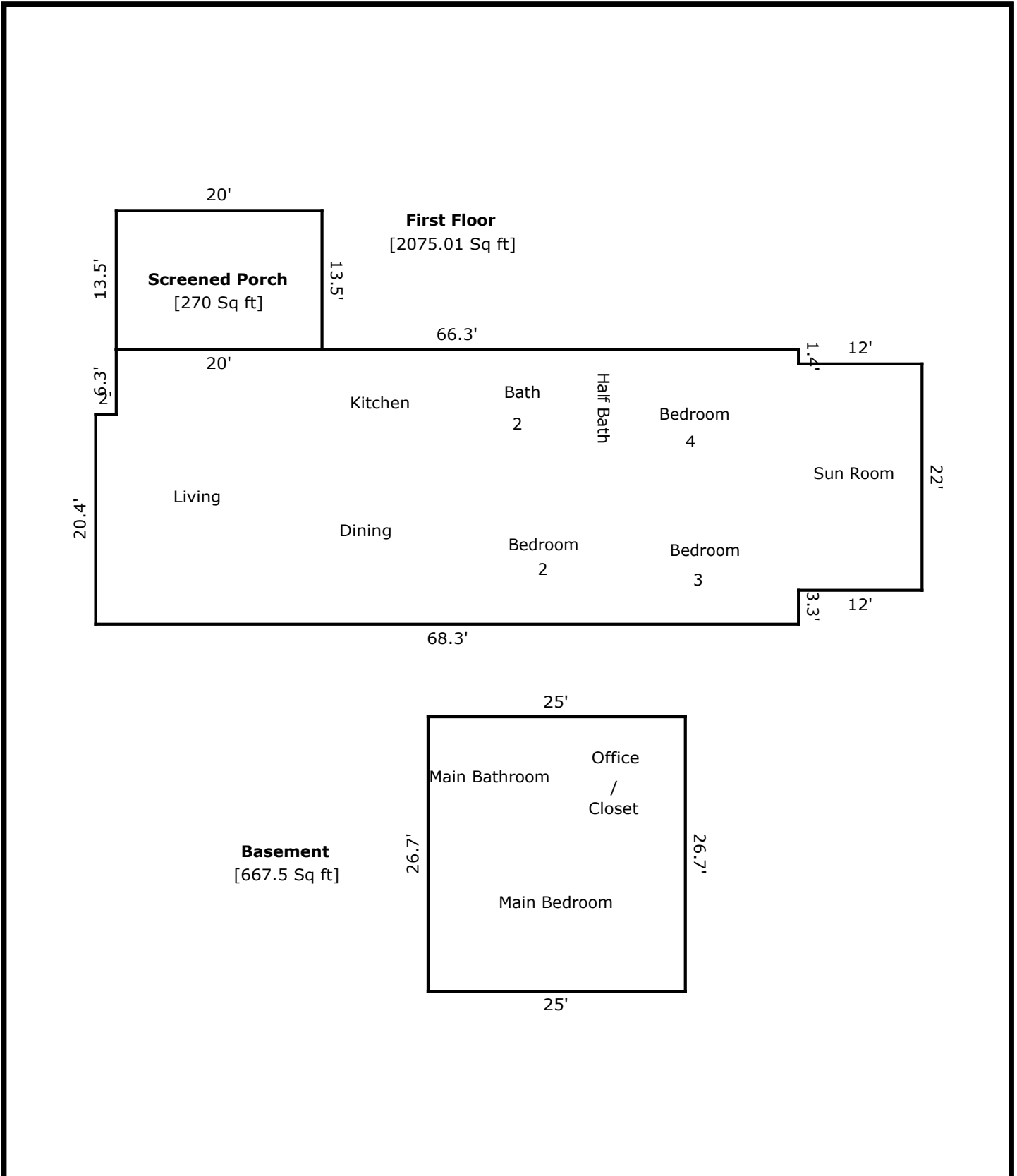

TOTAL Sketch by a la mode, inc.

Area Calculations Summary

Living Area	Calculation Details	
First Floor	2075.01 Sq ft	22 × 12 = 264 26.7 × 66.3 = 1770.21 2 × 20.4 = 40.8
Basement	667.5 Sq ft	26.7 × 25 = 667.5
Total Living Area (Rounded):	2743 Sq ft	
Non-living Area		
Screened Porch	270 Sq ft	20 × 13.5 = 270