

### Supplemental Addendum

File No. 0056261

Borrower					
Property Address 1623 Mystic St					
City	Knoxville	County	Knox	State	TN
Lender/Client				Zip Code	37922

**Measurements of 1623 Mystic St**

**1st Floor**                      **1747 sq ft**  
**2nd Floor**                      **393 sq ft**  
**Total**                            **2140 sq ft**

The Square Footage-Method for Calculating: ANSI® Z765-2021 (American National Standards Institute®) Measuring Standard for calculating gross living area (GLA), and non-GLA areas of the subject property, was utilized in creating the sketch for this measurement report.

Interior Room Measurements

First Floor

Dining                            12 x 11  
Kitchen                            11 x 16.5  
Living                              18 x 16  
Bed                                 13.5 x 12  
Bath                                8.5 x 5  
Laundry                            9 x 6  
Primary Bed                      14.5 x 13.5  
Primary Bath                      12.5 x 8.5 x irr  
Primary Sitting                    16 x 14

Second Floor

Bonus                              17.5 x 16.5 x irr

Signature \_\_\_\_\_  
Name Charles Skalet  
Date Signed \_\_\_\_\_  
State Certification # CR-2399                      State TN  
Or State License # \_\_\_\_\_                      State \_\_\_\_\_

Signature \_\_\_\_\_  
Name \_\_\_\_\_  
Date Signed \_\_\_\_\_  
State Certification # \_\_\_\_\_                      State \_\_\_\_\_  
Or State License # \_\_\_\_\_                      State \_\_\_\_\_

### Building Sketch

Borrower				
Property Address 1623 Mystic St				
City	Knoxville	County	Knox	State TN Zip Code 37922
Lender/Client				

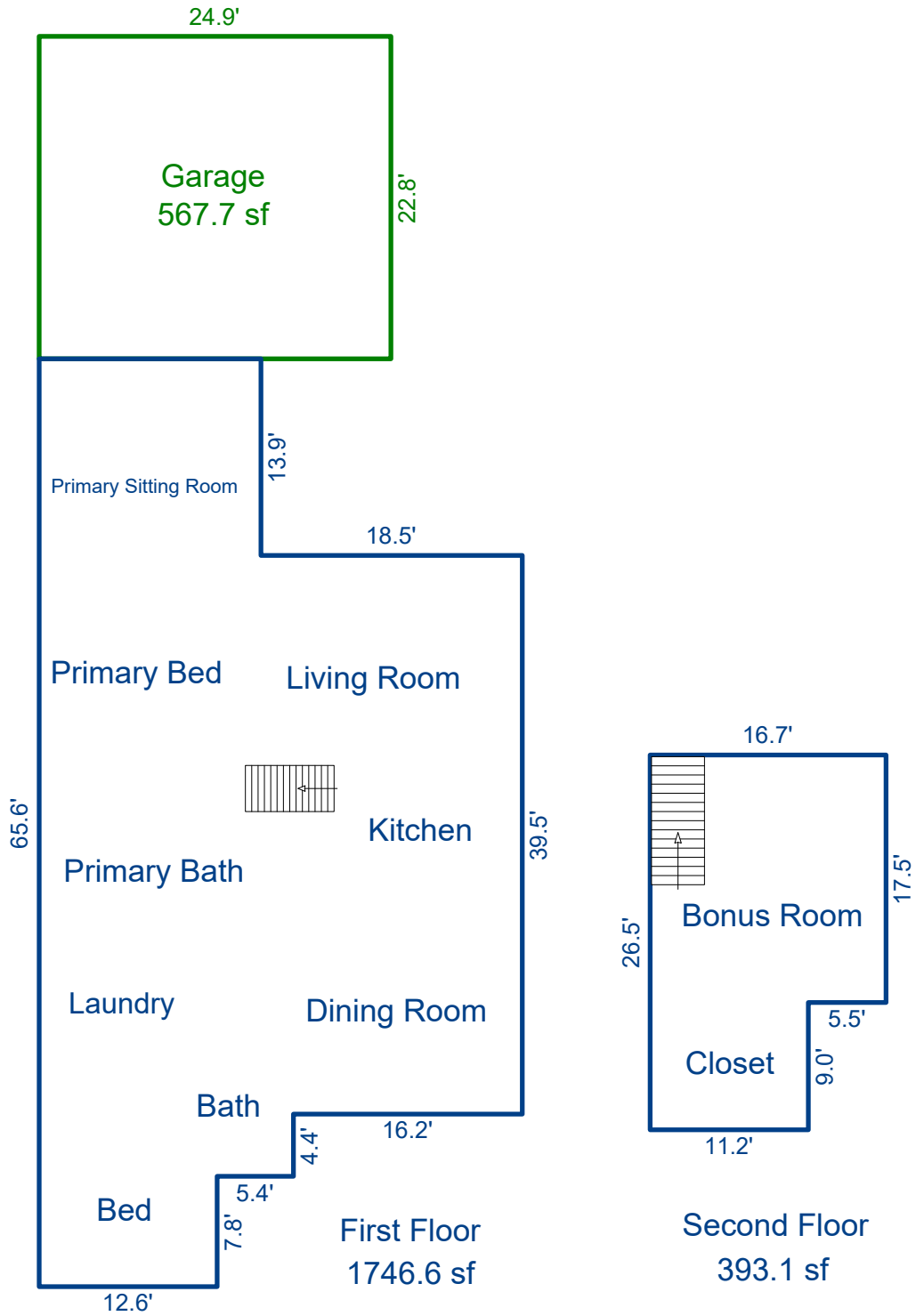

Sketch by Apex Sketch

AREA CALCULATIONS SUMMARY						AREA CALCULATIONS BREAKDOWN				
Code	Description	Factor	Net Size	Perimeter	Net Totals	Name	Base x	Height x	Width =	Area
GLA1	First Floor	1.0	1746.6	199.6	1746.6	First Floor	43.9 x	18.0 =		790.2
GLA2	Second Floor	1.0	393.1	86.4	393.1		39.5 x	16.2 =		639.9
GAR	Garage	1.0	567.7	95.4	567.7		12.6 x	7.8 =		98.3
							15.7 x	13.9 =		218.2
						Second Floor	26.5 x	11.2 =		296.8
							17.5 x	5.5 =		96.2
	Net LIVABLE	cnt	2 (rounded)		2,140	6 total items			(rounded)	2,140

### Subject Photo Page

Borrower					
Property Address 1623 Mystic St					
City Knoxville		County Knox		State TN	Zip Code 37922
Lender/Client					



#### Subject Front

- Sales Price
- Gross Living Area
- Total Rooms
- Total Bedrooms
- Total Bathrooms
- Location
- View
- Site
- Quality
- Age

#### Subject Rear



#### Subject Street