



## Subject Photo Page

Borrower	Martha Riordan						
Property Address	1348 Wenlock						
City	Knoxville	County	Knox	State	TN	Zip Code	37932
Lender/Client	Martha Riordan						



### Subject Front

1348 Wenlock  
Sales Price  
Gross Living Area  
Total Rooms  
Total Bedrooms  
Total Bathrooms  
Location  
View  
Site  
Quality  
Age



### Subject Rear

### Subject Street

# Supplemental Addendum

File No.

Borrower	Martha Riordan						
Property Address	1348 Wenlock						
City	Knoxville	County	Knox	State	TN	Zip Code	37932
Lender/Client	Martha Riordan						

**1348 Wenlock- 2157 sq ft**

**1st Level- 1120 sq ft**

- Office 13 x 12
- Dining 12 x 11
- Half Bath 6 x 3
- Kitchen 11 x 10
- Breakfast 8 x 6
- Living 16 x 13
- Laundry 6 x 5

**2nd Level- 1037 sq ft**

- Main Bed 17 x 13
- Main Bath 13 x 6
- Bed 2 12 x 11
- Bed 3 12 x 11
- Bed 4 12 x 11
- Bath 9 x 5

Signature \_\_\_\_\_  
Name Jeremy Skalet  
Date Signed \_\_\_\_\_  
State Certification # 3215 State TN  
Or State License # \_\_\_\_\_ State \_\_\_\_\_

Signature \_\_\_\_\_  
Name \_\_\_\_\_  
Date Signed \_\_\_\_\_  
State Certification # \_\_\_\_\_ State \_\_\_\_\_  
Or State License # \_\_\_\_\_ State \_\_\_\_\_

## Building Sketch

Borrower	Martha Riordan			
Property Address	1348 Wenlock			
City	Knoxville	County Knox	State TN	Zip Code 37932
Lender/Client	Martha Riordan			

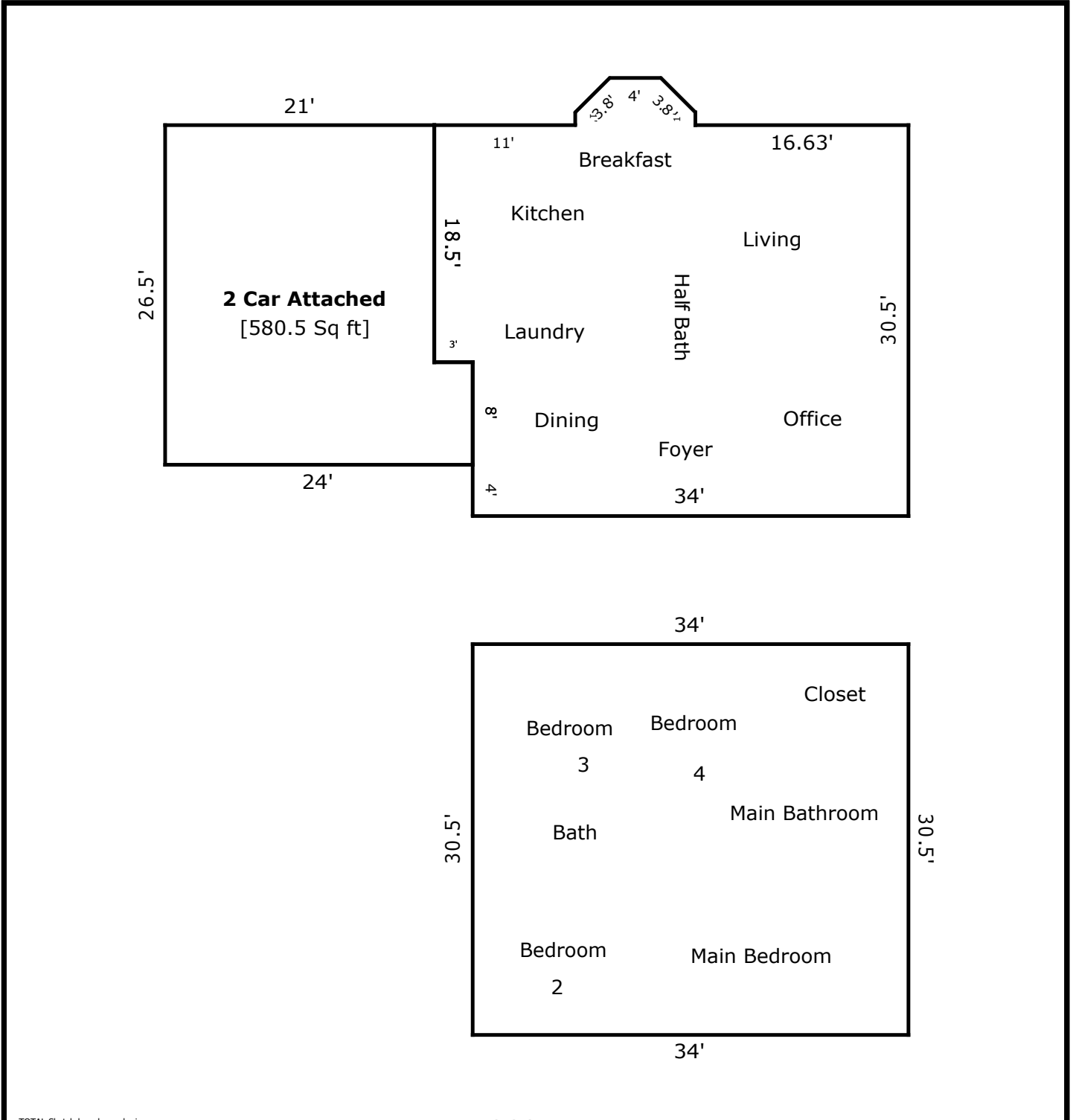

TOTAL Sketch by a la mode, inc.

### Area Calculations Summary

Living Area	Calculation Details	
First Floor	1119.84 Sq ft	$34 \times 12 = 408$ $37 \times 18.5 = 684.5$ $9.37 \times 1 = 9.37$ $0.5 \times 2.69 \times 2.69 = 3.61$ $0.5 \times 2.69 \times 2.69 = 3.61$ $4 \times 2.69 = 10.75$
Second Floor	1037 Sq ft	$34 \times 30.5 = 1037$
<b>Total Living Area (Rounded):</b>	<b>2157 Sq ft</b>	
<b>Non-living Area</b>		
2 Car Attached	580.5 Sq ft	$21 \times 18.5 = 388.5$ $8 \times 24 = 192$