

Supplemental Addendum

File No. 0055979

Borrower	Jacquie Litton				
Property Address	8309 Mecklenburg				
City	Knoxville	County	State	TN	Zip Code 37932
Lender/Client	Jacquie Litton				

8309 Mecklenburg- 3545 sq ft

1st Level- 1225 sq ft

2nd Level- 1299 sq ft

Basement- 1022 sq ft

Signature _____
Name Jeremy Skalet
Date Signed _____
State Certification # 3215 State TN
Or State License # _____ State _____

Signature _____
Name _____
Date Signed _____
State Certification # _____ State _____
Or State License # _____ State _____

Subject Photo Page

Borrower	Jacquie Litton				
Property Address	8309 Mecklenburg				
City	Knoxville	County	State	TN	Zip Code 37932
Lender/Client	Jacquie Litton				



Subject Front

8309 Mecklenburg



Subject Rear

Subject Street

Building Sketch

Borrower	Jacquie Litton			
Property Address	8309 Mecklenburg			
City	Knoxville	County	State	TN
Zip Code	37932			
Lender/Client	Jacquie Litton			

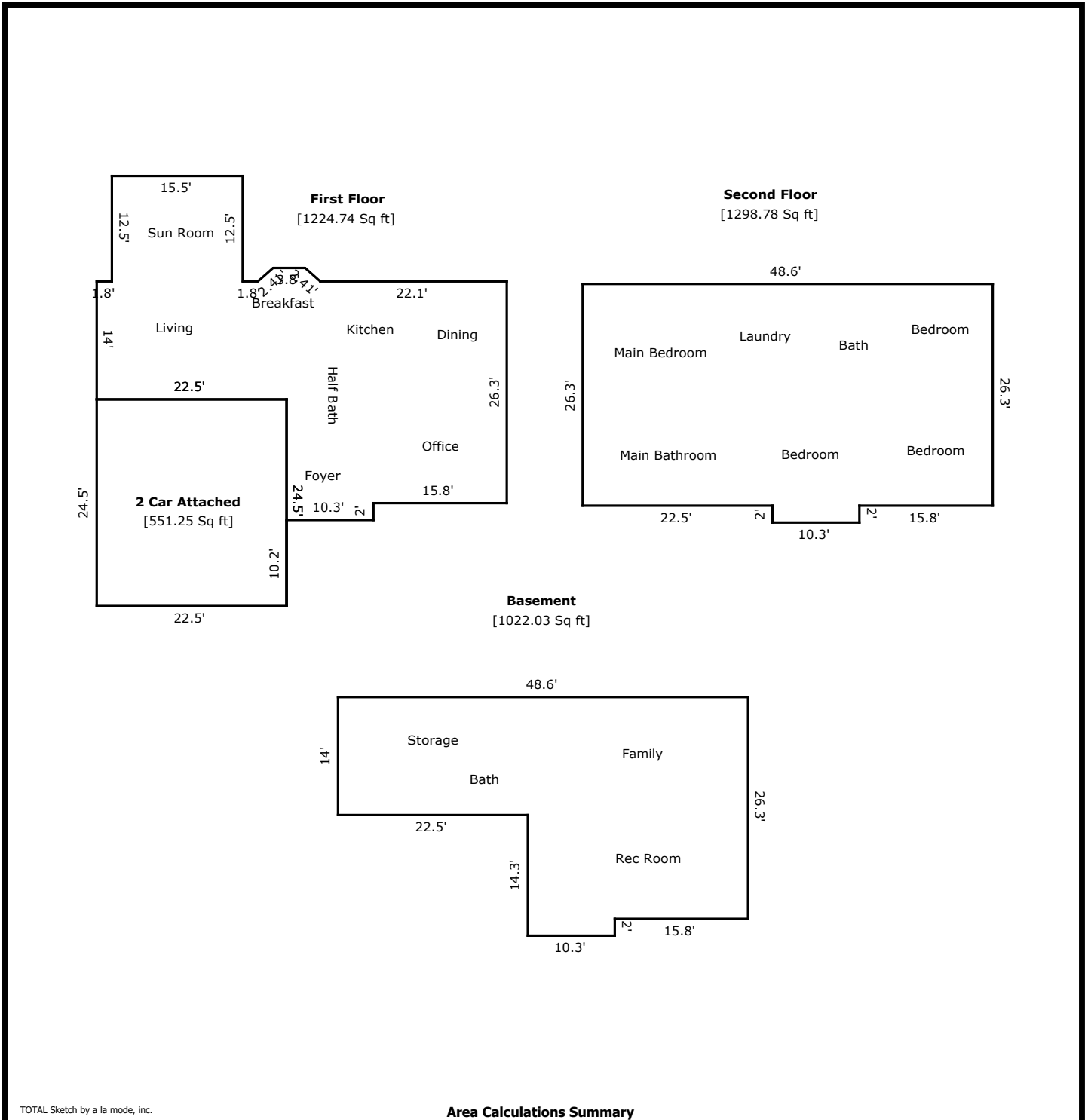

TOTAL Sketch by a la mode, inc.

Area Calculations Summary

Living Area	Calculation Details		
First Floor	1224.74 Sq ft		$0.5 \times 1.8 \times 1.6 = 1.44$ $0.5 \times 1.6 \times 1.8 = 1.44$ $3.8 \times 1.6 = 6.08$ $15.5 \times 12.5 = 193.75$ $14 \times 22.5 = 315$ $26.1 \times 26.3 = 686.43$ $2 \times 10.3 = 20.6$
Second Floor	1298.78 Sq ft		$10.3 \times 2 = 20.6$ $48.6 \times 26.3 = 1278.18$
Basement	1022.03 Sq ft		$26.3 \times 15.8 = 415.54$ $10.3 \times 14.3 = 147.29$ $14 \times 32.8 = 459.2$
Total Living Area (Rounded):	3546 Sq ft		
Non-living Area			
2 Car Attached	551.25 Sq ft		$24.5 \times 22.5 = 551.25$