

Supplemental Addendum

File No.

Borrower	Joyce Tapscott			
Property Address	8614 Belle Mina			
City	Knoxville	County	State	TN Zip Code 37932
Lender/Client	Joyce Tapscott			

8614 Belle Mina- 2769 sq ft

1st Level- 1581 sq ft

Living 20 x 15
Dining 12 x 10
Kitchen 14 x 12
Breakfast 11 x 9
Main Bed 16 x 14
Main Bath 12 x 10
Laundry 7 x 6
Half Bath 6 x 5

2nd Level- 1188 sq ft

Bed 2 13 x 12
Bed 3 12 x 11
Bath 11 x 5
Loft 17 x 14
Bonus 26 x 14

Signature _____
Name Charles Skalet
Date Signed _____
State Certification # CR-2399 State TN
Or State License # _____ State _____

Signature _____
Name _____
Date Signed _____
State Certification # _____ State _____
Or State License # _____ State _____

Subject Photo Page

Borrower	Joyce Tapscott				
Property Address	8614 Belle Mina				
City	Knoxville	County	State	TN	Zip Code 37932
Lender/Client	Joyce Tapscott				



Subject Front

8614 Belle Mina
Sales Price
Gross Living Area
Total Rooms
Total Bedrooms
Total Bathrooms
Location
View
Site
Quality
Age



Subject Rear

Subject Street

Building Sketch

Borrower	Joyce Tapscott			
Property Address	8614 Belle Mina			
City	Knoxville	County	State	TN
Zip Code	37932			
Lender/Client	Joyce Tapscott			

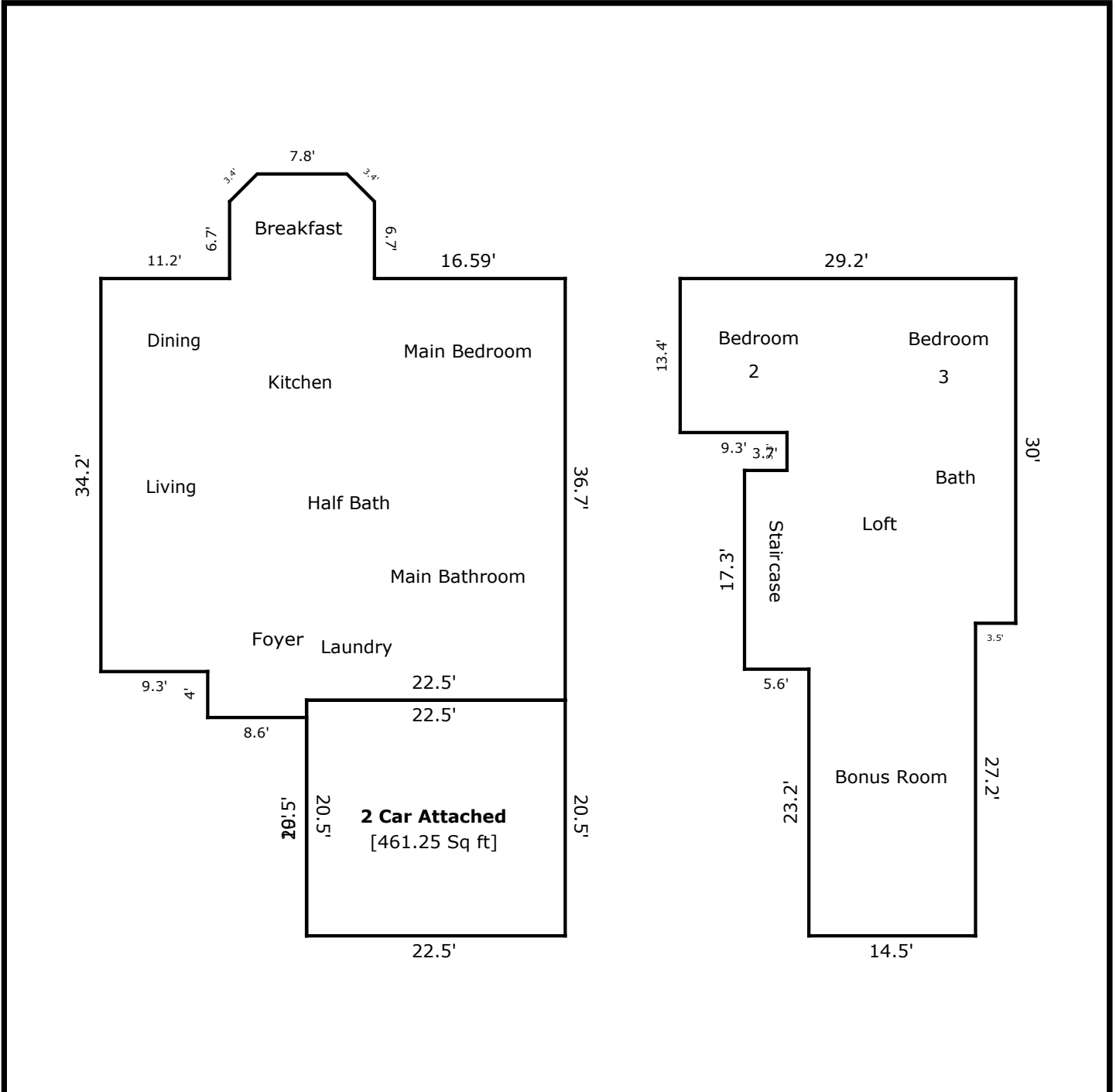

TOTAL Sketch by a la mode, inc.

Area Calculations Summary

Living Area	Calculation Details	
First Floor	1581.34 Sq ft	$0.5 \times 2.4 \times 2.4 = 2.89$ $0.5 \times 2.4 \times 2.4 = 2.89$ $7.8 \times 2.4 = 18.75$ $12.61 \times 6.7 = 84.48$ $40.4 \times 34.2 = 1381.68$ $31.1 \times 2.5 = 77.75$ $8.6 \times 1.5 = 12.9$
Second Floor	1187.63 Sq ft	$13.4 \times 9.3 = 124.62$ $19.9 \times 16.7 = 332.33$ $14.5 \times 23.2 = 336.4$ $17.3 \times 20.1 = 347.73$ $13.3 \times 3.5 = 46.55$
Total Living Area (Rounded):	2769 Sq ft	
Non-living Area		
2 Car Attached	461.25 Sq ft	$22.5 \times 20.5 = 461.25$