

# INVOICE

**FROM:**

Advanced Appraisal Services  
 Advanced Appraisal Services  
 PO Box 11373  
 Knoxville, TN 37939-1373

Telephone Number: (865) 588-4008

Fax Number:

**TO:**

The Holli McCray Group

Knoxville, TN

E-Mail: verdeaux@kw.com

Telephone Number: (865) 851-0181

Fax Number:

Alternate Number:

**INVOICE NUMBER**

0055672

**DATES**

Invoice Date: 06/07/2022

Due Date: 06/07/2022

**REFERENCE**

Internal Order #: 0055672

Lender Case #:

Client File #:

FHA/VA Case #:

Main File # on form: 0055672

Other File # on form: 0055672

Federal Tax ID: 62-1867763

Employer ID:

**DESCRIPTION**

<b>Lender:</b> The Holli McCray Group	<b>Client:</b> The Holli McCray Group
<b>Purchaser/Borrower:</b> The Holli McCray Group	
<b>Property Address:</b> 4833 Smithwood	
<b>City:</b> Knoxville	
<b>County:</b> Knox	<b>State:</b> TN <b>Zip:</b> 37932
<b>Legal Description:</b> Lot 3 Topside Place	

**FEES**

**AMOUNT**

Measurement	75.00
interior	0.00

**SUBTOTAL** 75.00

**PAYMENTS**

**AMOUNT**

<b>Check #:</b>	<b>Date:</b>	<b>Description:</b>	
Check #:	Date:	Description:	
Check #:	Date:	Description:	

**SUBTOTAL** 0

**TOTAL DUE** \$ 75.00

# Supplemental Addendum

File No. 0055672

Borrower	The Holli McCray Group						
Property Address	4833 Smithwood						
City	Knoxville	County	Knox	State	TN	Zip Code	37932
Lender/Client	The Holli McCray Group						

**4833 Smithwood- 2931 sq ft**

**1st Level- 1667 sq ft**

- Living 22 x 15
- Dining 14 x 12
- Kitchen 14 x 9
- Laundry 10 x 7
- Half Bath 5 x 3
- Bed 1 13 x 13
- Bath 1 12 x 5
- Bed 2 12 x 9
- Bed 3 13 x 11

**Basement- 1264 sq ft**

- Family 29 x 15
- Bath 2 8 x 5
- Office 1 13 x 12
- Bed 4 12 x 10
- Bed 5 9 x 8
- Bath 3 8 x 5
- Office 2 13 x 9

Signature \_\_\_\_\_  
Name Jeremy Skalet  
Date Signed \_\_\_\_\_  
State Certification # 3215 State TN  
Or State License # \_\_\_\_\_ State \_\_\_\_\_

Signature \_\_\_\_\_  
Name \_\_\_\_\_  
Date Signed \_\_\_\_\_  
State Certification # \_\_\_\_\_ State \_\_\_\_\_  
Or State License # \_\_\_\_\_ State \_\_\_\_\_

## Subject Photo Page

Borrower	The Holli McCray Group						
Property Address	4833 Smithwood						
City	Knoxville	County	Knox	State	TN	Zip Code	37932
Lender/Client	The Holli McCray Group						



### Subject Front

4833 Smithwood

2,931



### Subject Rear



### Subject Garage

## Building Sketch

Borrower	The Holli McCray Group				
Property Address	4833 Smithwood				
City	Knoxville	County	Knox	State	TN
Lender/Client	The Holli McCray Group				
				Zip Code	37932

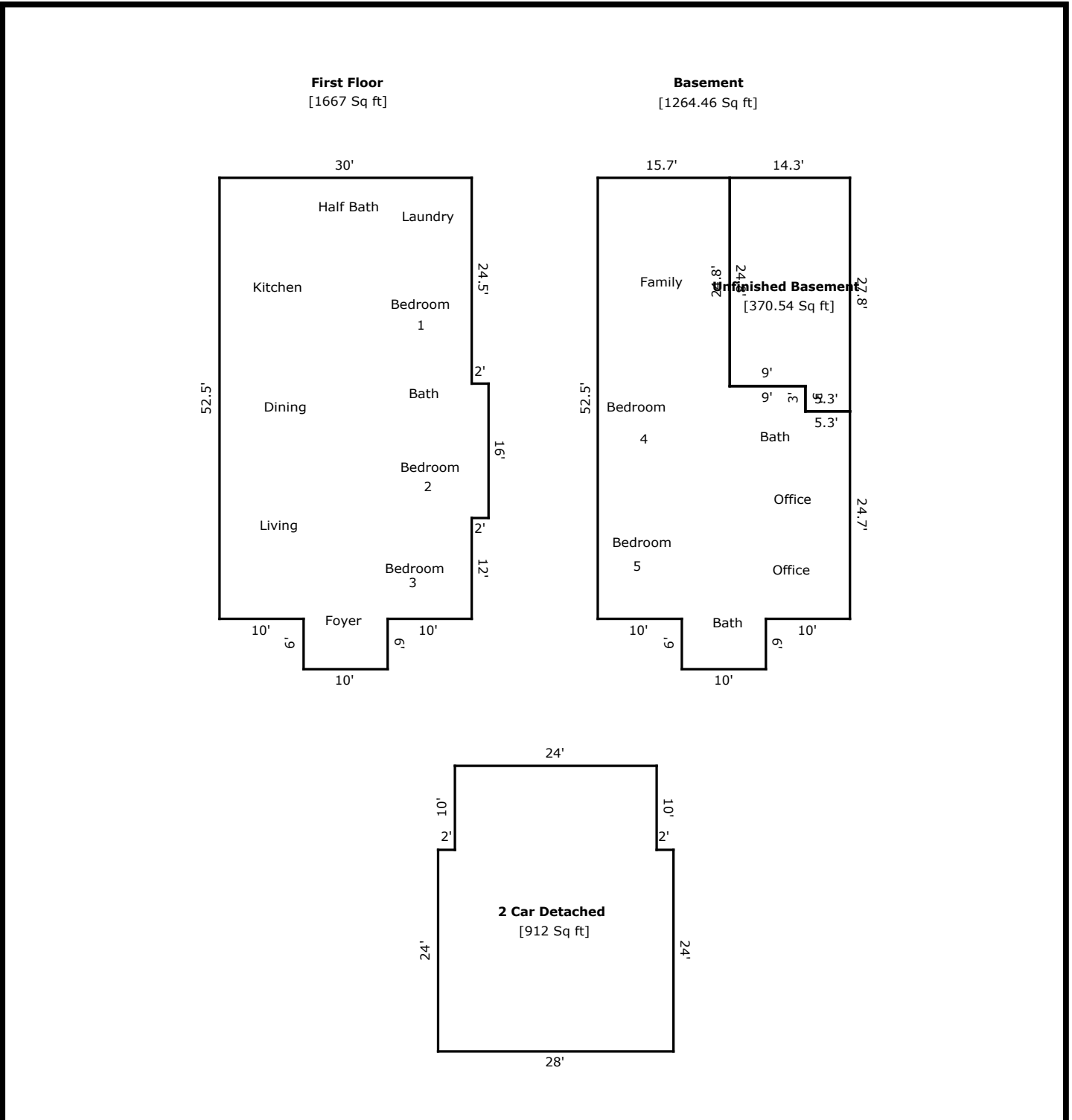

TOTAL Sketch by a la mode, inc.

### Area Calculations Summary

Living Area	Calculation Details	
First Floor	1667 Sq ft	$16 \times 2 = 32$ $10 \times 6 = 60$ $52.5 \times 30 = 1575$
Basement	1264.46 Sq ft	$10 \times 6 = 60$ $30 \times 24.7 = 741$ $15.7 \times 24.8 = 389.36$ $3 \times 24.7 = 74.1$
<b>Total Living Area (Rounded):</b>	<b>2931 Sq ft</b>	
<b>Non-living Area</b>		
Unfinished Basement	370.54 Sq ft	$14.3 \times 24.8 = 354.64$ $3 \times 5.3 = 15.9$
2 Car Detached	912 Sq ft	$24 \times 10 = 240$ $24 \times 28 = 672$