

# INVOICE

**FROM:**

Advanced Appraisal Services  
 Advanced Appraisal Services  
 PO Box 11373  
 Knoxville, TN 37939-1373

Telephone Number: (865) 588-4008 Fax Number:

**TO:**

Joyce Tapscott

E-Mail:

Telephone Number: (865) 388-2222 Fax Number:  
 Alternate Number:

**INVOICE NUMBER**

0055485

**DATES**

Invoice Date: 05/16/2022  
 Due Date: 05/16/2022

**REFERENCE**

Internal Order #: 0055485  
 Lender Case #:  
 Client File #:  
 FHA/VA Case #:  
 Main File # on form:  
 Other File # on form:  
 Federal Tax ID: 62-1867763  
 Employer ID:

**DESCRIPTION**

Lender: Joyce Tapscott Client: Joyce Tapscott  
 Purchaser/Borrower: Joyce Tapscott  
 Property Address: 10026 McCormick  
 City: Knoxville State: TN Zip: 37932  
 County:  
 Legal Description:

**FEES**

**AMOUNT**

Measurement	75.00
Interior Dimensions	25.00
<b>SUBTOTAL</b>	100.00

**PAYMENTS**

**AMOUNT**

Check #:	Date:	Description:	
Check #:	Date:	Description:	
Check #:	Date:	Description:	
<b>SUBTOTAL</b>			0

**TOTAL DUE** \$ 100.00

# Supplemental Addendum

File No.

Borrower	Joyce Tapscott		
Property Address	10026 McCormick		
City	Knoxville	County	State TN Zip Code 37932
Lender/Client	Joyce Tapscott		

## 10026 McCormick- 2078 sq ft

- Laundry/Pantry 8 x 5
- Kitchen 12 x 11
- Breakfast 9 x 7
- Dining 16 x 11
- Bed 2 14 x 12
- Bath 2 7 x 5
- Living 22 x 18
- Bed 3 13 x 9
- Main Bed 19 x 15
- Main Closet 14 x 12
- Man Bath 11 x 9

Signature \_\_\_\_\_  
Name Jeremy Skalet  
Date Signed \_\_\_\_\_  
State Certification # 3215 State TN  
Or State License # \_\_\_\_\_ State \_\_\_\_\_

Signature \_\_\_\_\_  
Name \_\_\_\_\_  
Date Signed \_\_\_\_\_  
State Certification # \_\_\_\_\_ State \_\_\_\_\_  
Or State License # \_\_\_\_\_ State \_\_\_\_\_

## Subject Photo Page

Borrower	Joyce Tapscott				
Property Address	10026 McCormick				
City	Knoxville	County	State	TN	Zip Code 37932
Lender/Client	Joyce Tapscott				



### Subject Front

10026 McCormick  
Sales Price  
Gross Living Area  
Total Rooms  
Total Bedrooms  
Total Bathrooms  
Location  
View  
Site  
Quality  
Age

### Subject Rear

### Subject Street

## Building Sketch

Borrower	Joyce Tapscott			
Property Address	10026 McCormick			
City	Knoxville	County	State	TN
Zip Code	37932			
Lender/Client	Joyce Tapscott			

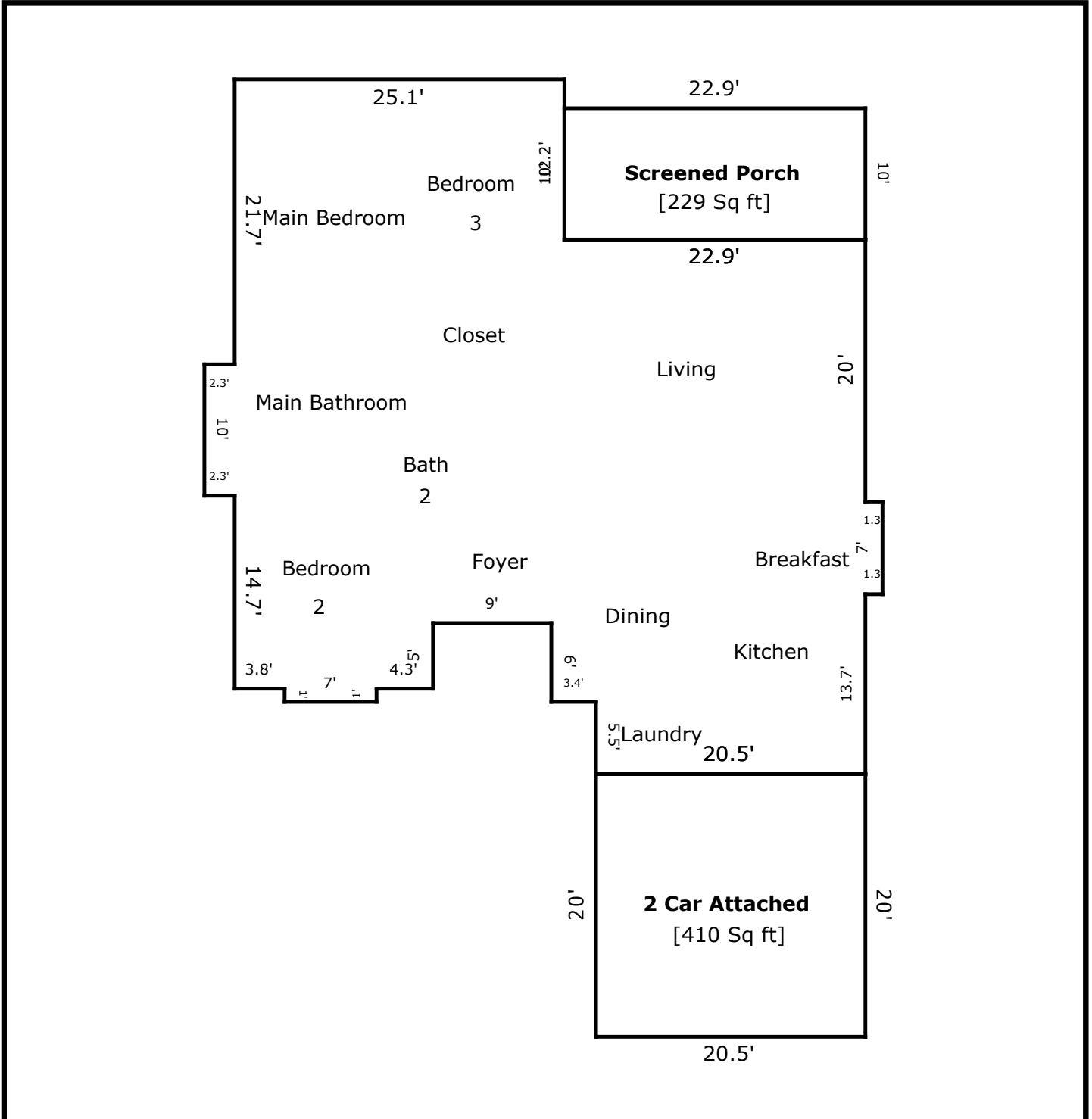

TOTAL Sketch by a la mode, inc.

### Area Calculations Summary

Living Area	First Floor	2078.57 Sq ft	Calculation Details
			7 × 1.3 = 9.1
			10 × 2.3 = 23
			7 × 1 = 7
			40.7 × 20.5 = 834.35
			3.4 × 6 = 20.4
			25.1 × 12.2 = 306.22
			27.5 × 29.2 = 803
			5 × 15.1 = 75.5
<b>Total Living Area (Rounded):</b>		<b>2079 Sq ft</b>	
<b>Non-living Area</b>			
Screened Porch		229 Sq ft	10 × 22.9 = 229
2 Car Attached		410 Sq ft	20 × 20.5 = 410