

Supplemental Addendum

File No.

Borrower	Sharon Bailey			
Property Address	9129 Grey Pointe			
City	Knoxville	County	State	TN Zip Code 37932
Lender/Client	Sharon Bailey			

9129 Grey Pointe- 6841 sq ft

1st Level- 3811 sq ft

- Living 17 x 14
- Dining 18 x 15
- Bar 7 x 7
- Gathering 15 x 11
- Breakfast 12 x 10
- Kitchen 18 x 14
- Pantry 9 x 6
- Laundry 12 x 9
- Great Room 23 x 22
- Main Bed 20 x 16
- Main Bath 26 x 16
- Half Bath 8 x 7

2nd Level- 3030 sq ft

- Bonus/Bed 25 x 14
- Bath 2 8 x 5
- Theater 31 x 17
- Sitting 19 x 13
- Bed 3 18 x 15
- Bath 3 8 x 7
- Bed 4 18 x 15
- Bath 4 8 x 7

Signature _____
Name Jeremy Skalet
Date Signed _____
State Certification # 3215 State TN
Or State License # _____ State _____

Signature _____
Name _____
Date Signed _____
State Certification # _____ State _____
Or State License # _____ State _____

Subject Photo Page

Borrower	Sharon Bailey				
Property Address	9129 Grey Pointe				
City	Knoxville	County	State	TN	Zip Code 37932
Lender/Client	Sharon Bailey				



Subject Front

9129 Grey Pointe
Sales Price
Gross Living Area 6,841
Total Rooms
Total Bedrooms
Total Bathrooms
Location
View
Site
Quality
Age



Subject Rear

Subject Street

Building Sketch

Borrower	Sharon Bailey			
Property Address	9129 Grey Pointe			
City	Knoxville	County	State	TN
Lender/Client	Sharon Bailey			
			Zip Code	37932

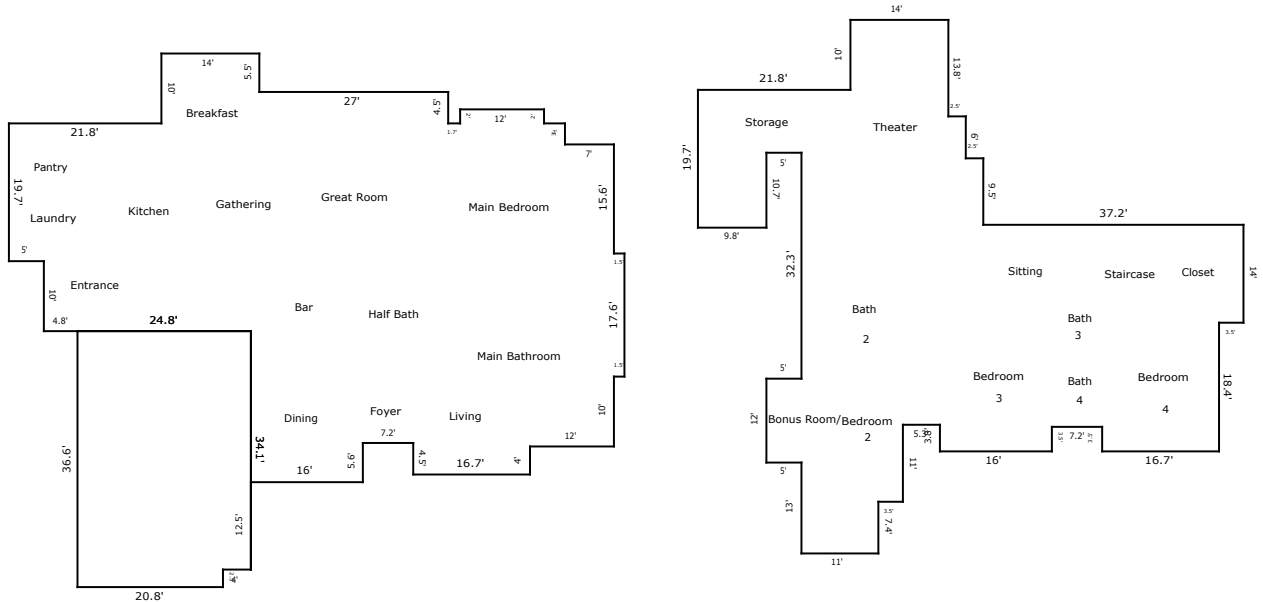

TOTAL Sketch by a la mode, inc.

Area Calculations Summary

Living Area	
First Floor	3811.1 Sq ft
Second Floor	3029.6 Sq ft
Total Living Area (Rounded):	6841 Sq ft
Non-living Area	
3 Car Attached	897.68 Sq ft