

Supplemental Addendum

File No.

Borrower	Judy Teasley						
Property Address	8002 Ball Camp Pike						
City	Knoxville	County	Knox	State	TN	Zip Code	37932
Lender/Client	Judy Teasley						

8002 Ball Camp pike - 2038 sq ft

1st Level- 1312 sq ft

Dining 12 x 10
Kitchen 20 x 11
Half Bath 6 x 4
Living 19 x 19
Office 12 x 9

2nd Level- 726 sq ft

Bed 15 x 29
Closet 8 x 6
Bath 11 x 6

Unfinished Area- 285 sq ft

Signature _____
Name Jeremy Skalet
Date Signed _____
State Certification # 3215 State TN
Or State License # _____ State _____

Signature _____
Name _____
Date Signed _____
State Certification # _____ State _____
Or State License # _____ State _____

Subject Photo Page

Borrower	Judy Teasley						
Property Address	8002 Ball Camp Pike						
City	Knoxville	County	Knox	State	TN	Zip Code	37932
Lender/Client	Judy Teasley						



Subject Front

8002 Ball Camp Pike
Sales Price
Gross Living Area
Total Rooms
Total Bedrooms
Total Bathrooms
Location
View
Site
Quality
Age



Subject Rear

Subject Street

Building Sketch

Borrower	Judy Teasley			
Property Address	8002 Ball Camp Pike			
City	Knoxville	County Knox	State TN	Zip Code 37932
Lender/Client	Judy Teasley			

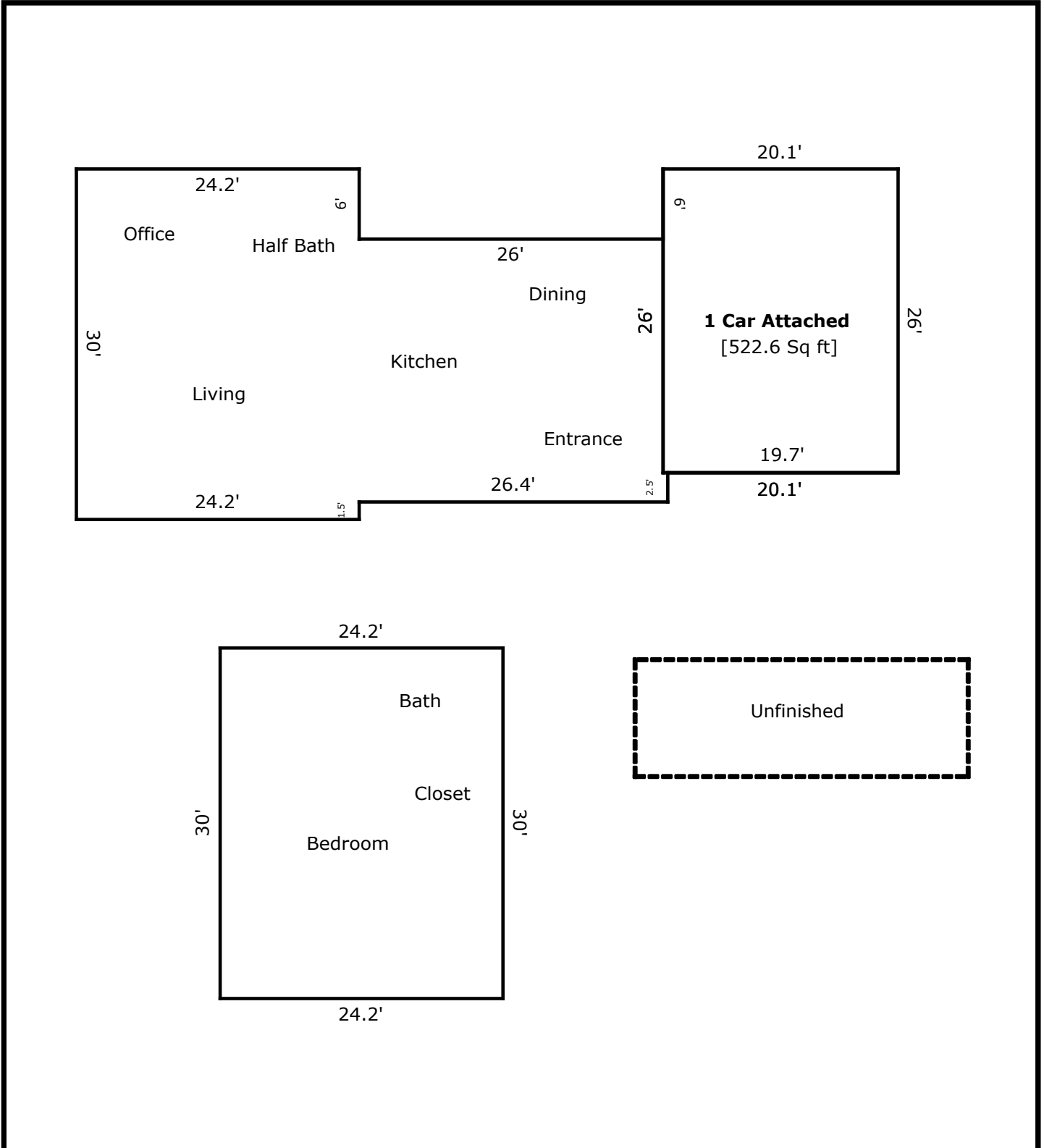

TOTAL Sketch by a la mode, inc.

Area Calculations Summary

Living Area	Calculation Details	
First Floor	1312 Sq ft	$30 \times 24.2 = 726$ $22.5 \times 26 = 585$ $0.4 \times 2.5 = 1$
Second Floor	726 Sq ft	$30 \times 24.2 = 726$
Total Living Area (Rounded):	2038 Sq ft	
Non-living Area		
1 Car Attached	522.6 Sq ft	$26 \times 20.1 = 522.6$