

Subject Photo Page

Borrower	Judy Teasley						
Property Address	135 Kimerson Ct						
City	Lenoir City	County	Knox	State	TN	Zip Code	37932
Lender/Client	Judy Teasley						



Subject Front

135 Kimerson Ct
Sales Price
Gross Living Area
Total Rooms
Total Bedrooms
Total Bathrooms
Location
View
Site
Quality
Age



Subject Rear

Subject Street

Building Sketch

Borrower	Judy Teasley			
Property Address	135 Kimerson Ct			
City	Lenoir City	County Knox	State TN	Zip Code 37932
Lender/Client	Judy Teasley			

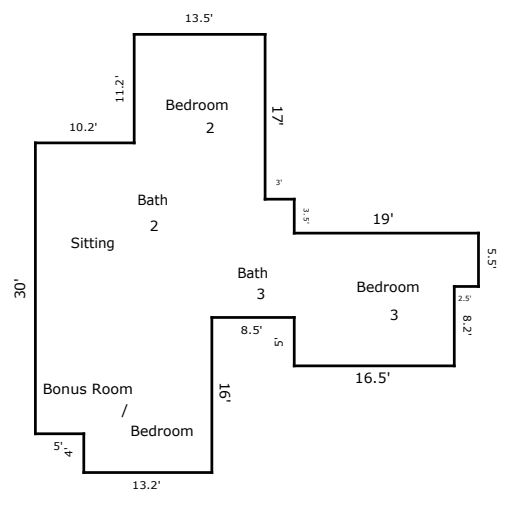
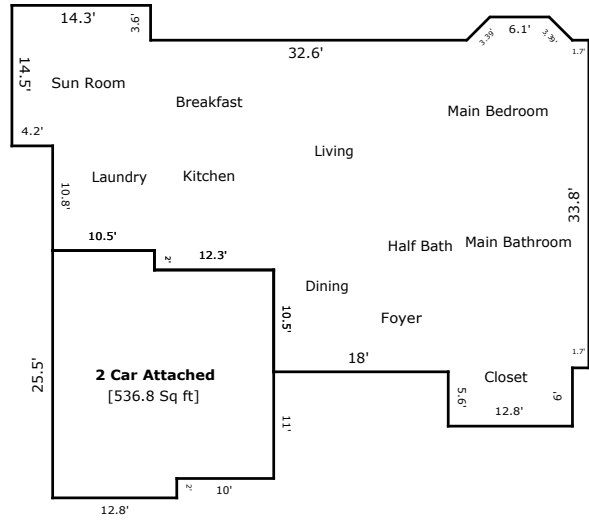

TOTAL Sketch by a la mode, inc.

Area Calculations Summary

Living Area	Calculation Details	
First Floor	1819.52 Sq ft	
		0.5 × 2.4 × 2.4 = 2.88
		0.5 × 2.4 × 2.4 = 2.88
		6.1 × 2.4 = 14.64
		14.5 × 4.2 = 60.9
		25.3 × 10.1 = 255.53
		45.2 × 21.7 = 980.84
		2 × 12.3 = 24.6
		12.5 × 18 = 225
		14.5 × 12.1 = 175.45
		6 × 12.8 = 76.8
Second Floor	1125.4 Sq ft	
		13.5 × 11.2 = 151.2
		5.5 × 2.5 = 13.75
		13.7 × 16.5 = 226.05
		13.2 × 4 = 52.8
		18.2 × 12 = 218.4
		18 × 23.7 = 426.6
		3 × 12.2 = 36.6
Total Living Area (Rounded):	2945 Sq ft	
Non-living Area		
2 Car Attached	536.8 Sq ft	
		21.5 × 10 = 215
		12.8 × 23.5 = 300.8
		2 × 10.5 = 21

Supplemental Addendum

File No.

Borrower	Judy Teasley		
Property Address	135 Kimerson Ct		
City	Lenoir City	County	Knox
		State	TN
		Zip Code	37932
Lender/Client	Judy Teasley		

135 Kimmerson Ct- 2945 sq ft

1st Level- 1820 sq ft

Dining 12 x 12
Living 19 x 16
Half Bath 5 x 5
Main Bed 19 x 13
Main Bath 16 x 9
Kitchen/Breakfast 22 x 13
Sun Room 13 x 13
Laundry 8 x 5

2nd Level- 1125 sq ft

Bonus 15 x 11
Sitting 16 x 10
Bath 2 11 x 5
Bed 2 13 x 13
Bed 3 13 x 13
Bath 3 9 x 5

Signature _____
Name Jeremy Skalet
Date Signed _____
State Certification # 3215 State TN
Or State License # _____ State _____

Signature _____
Name _____
Date Signed _____
State Certification # _____ State _____
Or State License # _____ State _____