

Supplemental Addendum

File No. 0055335

Borrower				
Property Address 1212 Ryan Pl				
City	Knoxville	County	Knox	State TN Zip Code 37919
Lender/Client Rachael Wedekind				

Measurements for 1212 Ryan Place

Main Level	1486 sq ft
Second Floor	1346 sq ft
Total	2832 sq ft

The Square Footage-Method for Calculating: ANSI® Z765-2021 (American National Standards Institute®) Measuring Standard for calculating gross living area (GLA), and non-GLA areas of the subject property, was utilized in creating the sketch for this measurement report.

Interior Measurements

1st Level

Living	15 x 19
Dining	14.5 x 13.5
1/2 Bath	6 x 5
Family	23 x 14.5
Kitchen	15 x 14.5
Laundry	10 x 6

2nd Level

M Bed	19x14
M Bath	10.5 x6.5 xirr
Bed	12 x 13.5
Bed	12 x 15
Bath	5 x 10.5
Bed	15 x 11

Signature 
 Name Charles Skalet
 Date Signed 05/03/2022
 State Certification # CR-2399 State TN
 Or State License # _____ State _____

Signature _____
 Name _____
 Date Signed _____
 State Certification # _____ State _____
 Or State License # _____ State _____

Subject Photo Page

Borrower				
Property Address	1212 Ryan Pl			
City	Knoxville	County	Knox	State TN Zip Code 37919
Lender/Client	Rachael Wedekind			



Subject Front



Subject Street

Building Sketch

Borrower				
Property Address 1212 Ryan Pl				
City	Knoxville	County	Knox	State TN Zip Code 37919
Lender/Client	Rachael Wedekind			

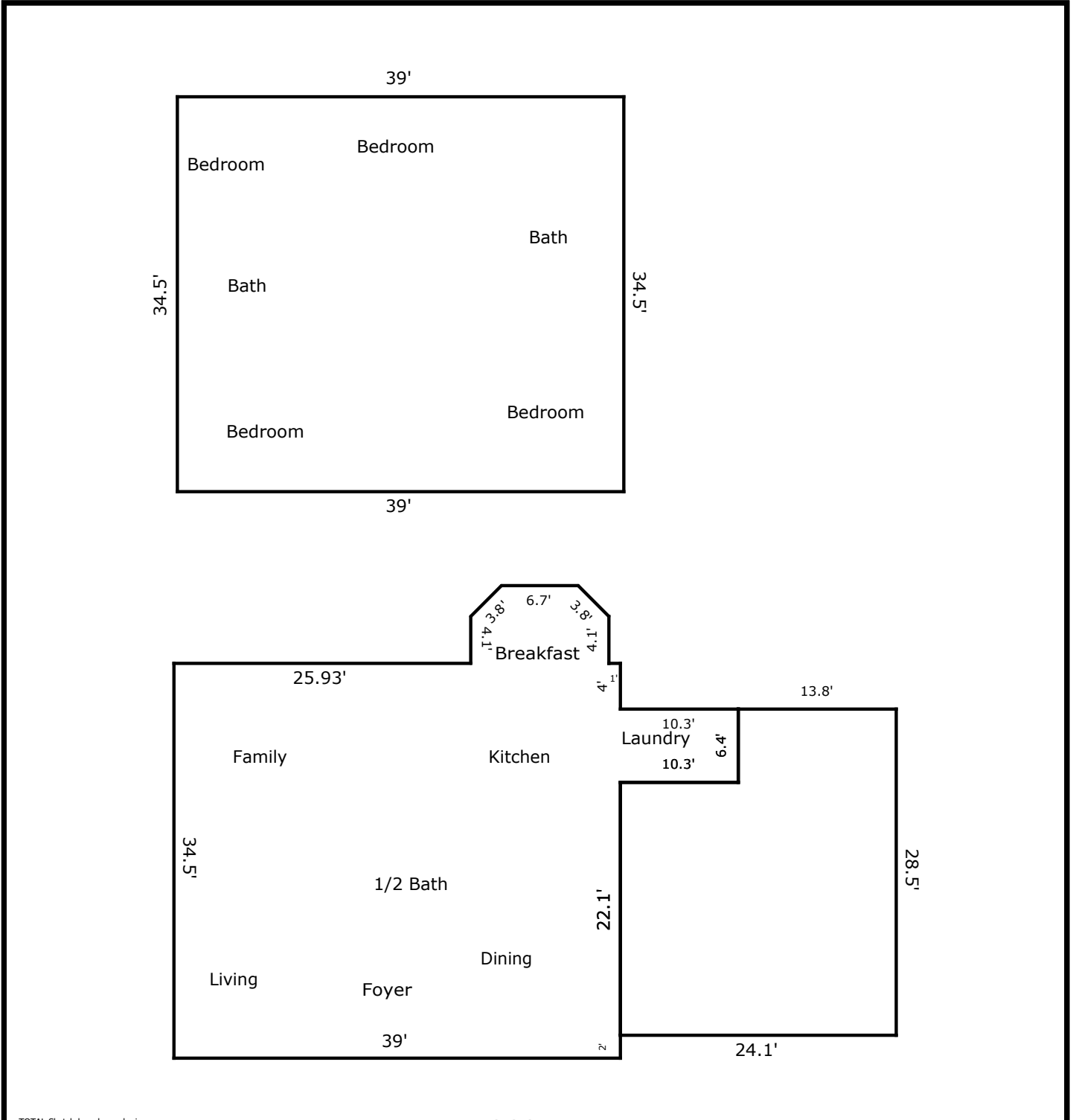

TOTAL Sketch by a la mode, inc.

Area Calculations Summary

Living Area	Calculation Details		
First Floor	1486.15 Sq ft	6.4 × 10.3	= 65.92
		39 × 34.5	= 1345.5
		12.07 × 4.1	= 49.5
		6.7 × 2.69	= 18
		0.5 × 2.69 × 2.69	= 3.61
		0.5 × 2.69 × 2.69	= 3.61
Second Floor	1345.5 Sq ft	39 × 34.5	= 1345.5
Total Living Area (Rounded):	2832 Sq ft		
Non-living Area			
2 Car Attached	620.93 Sq ft	24.1 × 22.1	= 532.61
		6.4 × 13.8	= 88.32