

**Supplemental Addendum**

File No. 0054745

Borrower					
Property Address 2232 Fallen Oaks Dr					
City	Knoxville	County	Knox	State	TN
Zip Code		37932			
Lender/Client Michael Gooch					

**Measurements for 2232 Fallen Oaks Dr**

1st Level- 2166 square feet  
 2nd Level 1296 square feet  
Basement/Down 1894 square feet

**Total 5356 square feet**

**Interior Rooms**

**1st Level**

Dining 12 x 12  
 Living 18.5 x 12  
 Laundry 10.5 x 9.5  
 Eat in Kitchen 27 x 12  
 Bath 12 x 9  
 1/2 Bath 5.5 x 5  
 Bed 16 x 15.5  
 Sunroom 23 x 16

**2nd Level**

Bonus Room 27 x 12  
 Bed 17.5 x 12  
 Bath 11.5 x 9.5 x irr  
 Bed 17.5 x 15

**Basement**

Rec Room 23 x 16  
 Bar 11 x 9 x irr  
 Media Area 24 x 11.5  
 Card Area 11 x 15.5  
 Office 14.5 x 11  
 Bed 16.5 x 11.5  
 Bath 9.5 x 5

Signature   
 Name Charles Skalet  
 Date Signed 02/23/2022  
 State Certification # CR-2399 State TN  
 Or State License # \_\_\_\_\_ State \_\_\_\_\_

Signature \_\_\_\_\_  
 Name \_\_\_\_\_  
 Date Signed \_\_\_\_\_  
 State Certification # \_\_\_\_\_ State \_\_\_\_\_  
 Or State License # \_\_\_\_\_ State \_\_\_\_\_

## Subject Photo Page

Borrower				
Property Address	2232 Fallen Oaks Dr			
City	Knoxville	County	Knox	State TN      Zip Code 37932
Lender/Client	Michael Gooch			



### Subject Front

- Sales Price
- Gross Living Area
- Total Rooms
- Total Bedrooms
- Total Bathrooms
- Location
- View
- Site
- Quality
- Age

### Subject Rear



### Subject Street

# Building Sketch

Borrower				
Property Address	2232 Fallen Oaks Dr			
City	Knoxville	County	Knox	State TN Zip Code 37932
Lender/Client	Michael Gooch			

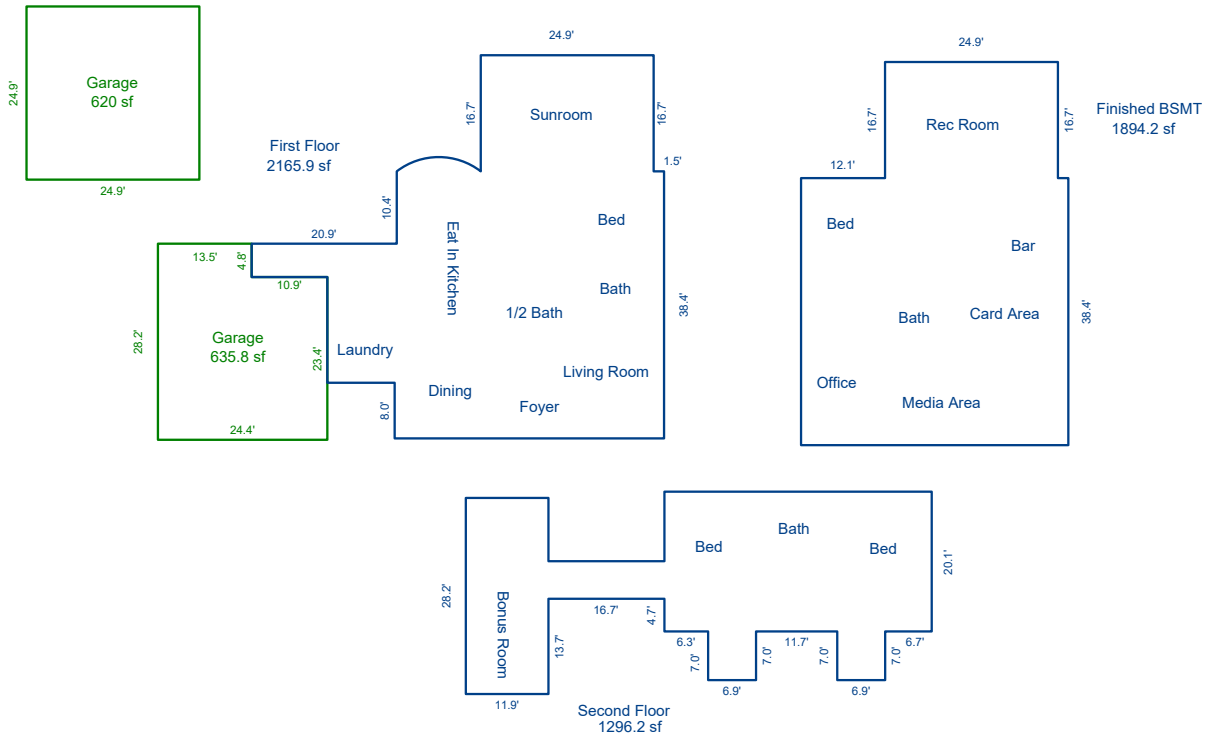

Sketch by Apex Sketch

AREA CALCULATIONS SUMMARY						AREA CALCULATIONS BREAKDOWN					
Code	Description	Factor	Net Size	Perimeter	Net Totals	Name	Base x	Height x	Width =	Area	
GLA1	First Floor	1.0	2165.9	229.9	2165.9	First Floor	24.9 x	16.7 x	=	415.8	
GLA2	Second Floor	1.0	1296.2	248.0	1296.2		59.4 x	4.8 x	=	285.1	
BSMT	Finished BSMT	1.0	1894.2	187.2	1894.2	Garage	48.5 x	15.2 x	=	737.2	
GAR	Garage	1.0	620.0	99.6	620.0		38.5 x	10.4 x	=	400.4	
	Garage	1.0	635.8	105.2	635.8	Second Floor	38.8 x	8.0 x	=	310.4	
							Curve	12.1 @	75°	=	16.9
								7.0 x	6.9 x	=	48.3
								7.0 x	6.9 x	=	48.3
								38.5 x	20.1 x	=	773.9
								16.7 x	5.4 x	=	90.2
								28.2 x	11.9 x	=	335.6
	Net LIVABLE	cnt	2	(rounded)	3,462		11 total items			(rounded)	3,462