

Supplemental Addendum

File No. 0054035

Borrower				
Property Address	9309 Sway Branch Ln			
City	Knoxville	County	Knox	State TN Zip Code 37922
Lender/Client	Brooke Dill			

Measurements of 9309 Sway Branch Ln

Main-SqFt **1303**
2nd- Sq Ft **1569**

Total **2872 square feet**

Signature 
 Name Charles Skalet
 Date Signed 11/30/2021
 State Certification # CR-2399 State TN
 Or State License # _____ State _____

Signature _____
 Name _____
 Date Signed _____
 State Certification # _____ State _____
 Or State License # _____ State _____

Building Sketch

Borrower				
Property Address	9309 Sway Branch Ln			
City	Knoxville	County	Knox	State TN Zip Code 37922
Lender/Client	Brooke Dill			

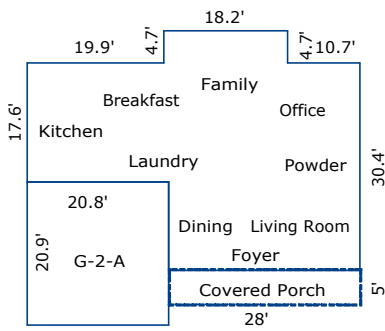

First Floor

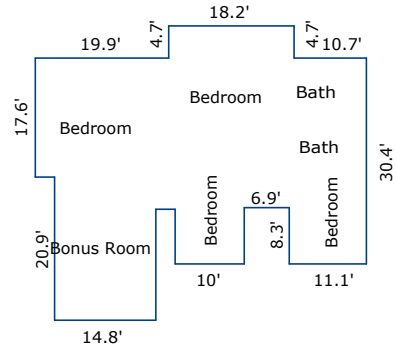

Second Floor

Comments:

AREA CALCULATIONS SUMMARY			
Code	Description	Net Size	Net Totals
GLA1	First Floor	1302.8	
	Second Floor	1569.3	2872.1
P/P	Covered Porch	140.0	140.0
GAR	Garage	434.7	434.7
Net LIVABLE Area		(rounded)	2872

LIVING AREA BREAKDOWN		
	Breakdown	Subtotals
First Floor		
	4.7 x 18.2	85.5
	17.6 x 48.8	858.9
	12.8 x 28.0	358.4
Second Floor		
	4.7 x 18.2	85.5
	22.4 x 27.8	622.7
	8.0 x 10.0	80.0
	14.8 x 16.1	238.3
	18.0 x 22.1	397.8
	3.0 x 17.6	52.8
	8.3 x 11.1	92.1
10 Items	(rounded)	2872