

Supplemental Addendum

File No. 0053898

Borrower	Joyce Tapscott		
Property Address	1600 Agawela		
City	Knoxville	County	State TN Zip Code 37919
Lender/Client	Joyce Tapscott		

1600 Agawela- 4235 sq ft

1st Level- 2100 sq ft

Laundry 10 x 6
Breakfast 13 x 10
Kitchen 13 x 12
Dining 14 x 13
Living 15 x 13
Family 18 x 16
Half Bath 5 x 5
Master Bed 17 x 14
Master Bath 18 x 11

2nd Level- 2135 sq ft

Bonus 25 x 16
Bath 2 10 x 8
Bed 2 15 x 12
Bed 3 13 x 13
Bed 4 14 x 13
Bath 3 13 x 5
Bed 5 13 x 14
Bath 4 9 x 5

Signature _____
Name Jeremy Skalet
Date Signed _____
State Certification # 3215 State TN
Or State License # _____ State _____

Signature _____
Name _____
Date Signed _____
State Certification # _____ State _____
Or State License # _____ State _____

Subject Photo Page

Borrower	Joyce Tapscott				
Property Address	1600 Agawela				
City	Knoxville	County	State	TN	Zip Code 37919
Lender/Client	Joyce Tapscott				



Subject Front

1600 Agawela
Sales Price
Gross Living Area
Total Rooms
Total Bedrooms
Total Bathrooms
Location
View
Site
Quality
Age



Subject Rear

Subject Street

Building Sketch

Borrower	Joyce Tapscott		
Property Address	1600 Agawela		
City	Knoxville	County	State TN Zip Code 37919
Lender/Client	Joyce Tapscott		

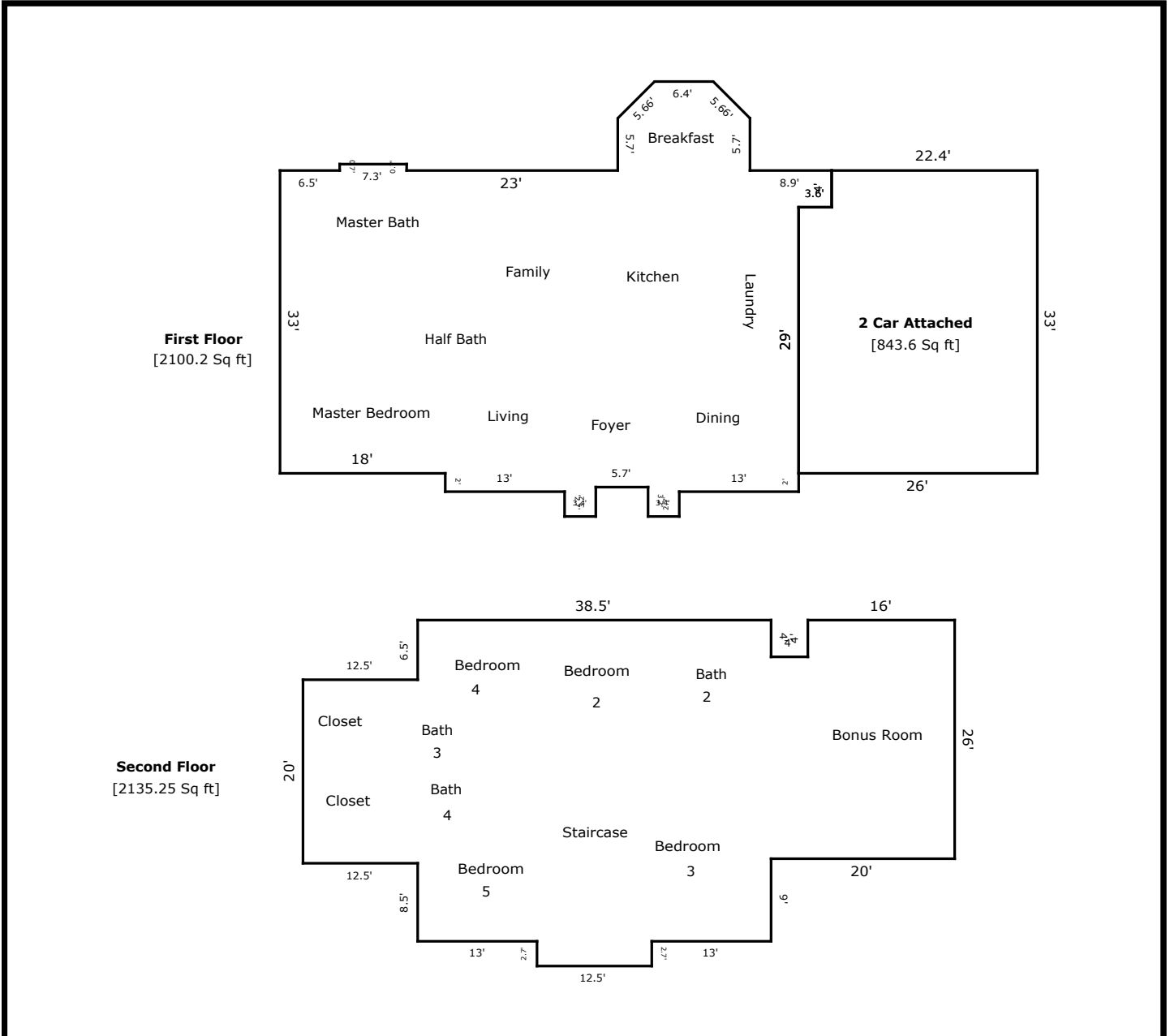

TOTAL Sketch by a la mode, inc.

Area Calculations Summary

Living Area	Area	Calculation Details
First Floor	2100.2 Sq ft	$7.3 \times 0.7 = 5.11$ $0.5 \times 4 \times 4 = 8$ $0.5 \times 4 \times 4 = 8$ $6.4 \times 4 = 25.6$ $14.4 \times 5.7 = 82.08$ $60.1 \times 4 = 240.4$ $56.5 \times 29 = 1638.5$ $38.5 \times 1.5 = 57.75$ $16.4 \times 0.5 = 8.2$ $3.4 \times 2.7 = 9.18$ $16.4 \times 0.5 = 8.2$ $3.4 \times 2.7 = 9.18$
Second Floor	2135.25 Sq ft	$12.5 \times 2.7 = 33.75$ $20 \times 12.5 = 250$ $35 \times 38.5 = 1347.5$ $20 \times 22 = 440$ $4 \times 16 = 64$
Total Living Area (Rounded):	4235 Sq ft	
Non-living Area		
2 Car Attached	843.6 Sq ft	$26 \times 29 = 754$ $4 \times 22.4 = 89.6$