

Supplemental Addendum

File No. 0053622

Borrower	Joyce Tapscott		
Property Address	6500 Orchard		
City	Knoxville	County	State TN Zip Code 37932
Lender/Client	Joyce Tapscott		

6500 Orchard- 3786 sq ft

1st Level- 1686 sq ft

- Living 24 x 14
- Dining 14 x 12
- Office 10 x 9
- Half Bath 8 x 3
- Kitchen 12 x 9
- Gathering 25 x 20

2nd Level- 1050 sq ft

- Master Bed 20 x 14
- Master Bath 8 x 6
- Bath 2 9 x 5
- Bed 2 14 x 14
- Bed 3 13 x 10

Basement- 1050 sq ft

- Sitting 10 x 8
- Bath 5 x 4
- Rec 17 x 12
- Laundry 7 x 7

Signature _____
Name Jeremy Skalet
Date Signed _____
State Certification # 3215 State TN
Or State License # _____ State _____

Signature _____
Name _____
Date Signed _____
State Certification # _____ State _____
Or State License # _____ State _____

Subject Photo Page

Borrower	Joyce Tapscott				
Property Address	6500 Orchard				
City	Knoxville	County	State	TN	Zip Code 37932
Lender/Client	Joyce Tapscott				



Subject Front

6500 Orchard
Sales Price
Gross Living Area
Total Rooms
Total Bedrooms
Total Bathrooms
Location
View
Site
Quality
Age



Subject Rear

Subject Street

Building Sketch

Borrower	Joyce Tapscott		
Property Address	6500 Orchard		
City	Knoxville	County	State TN Zip Code 37932
Lender/Client	Joyce Tapscott		

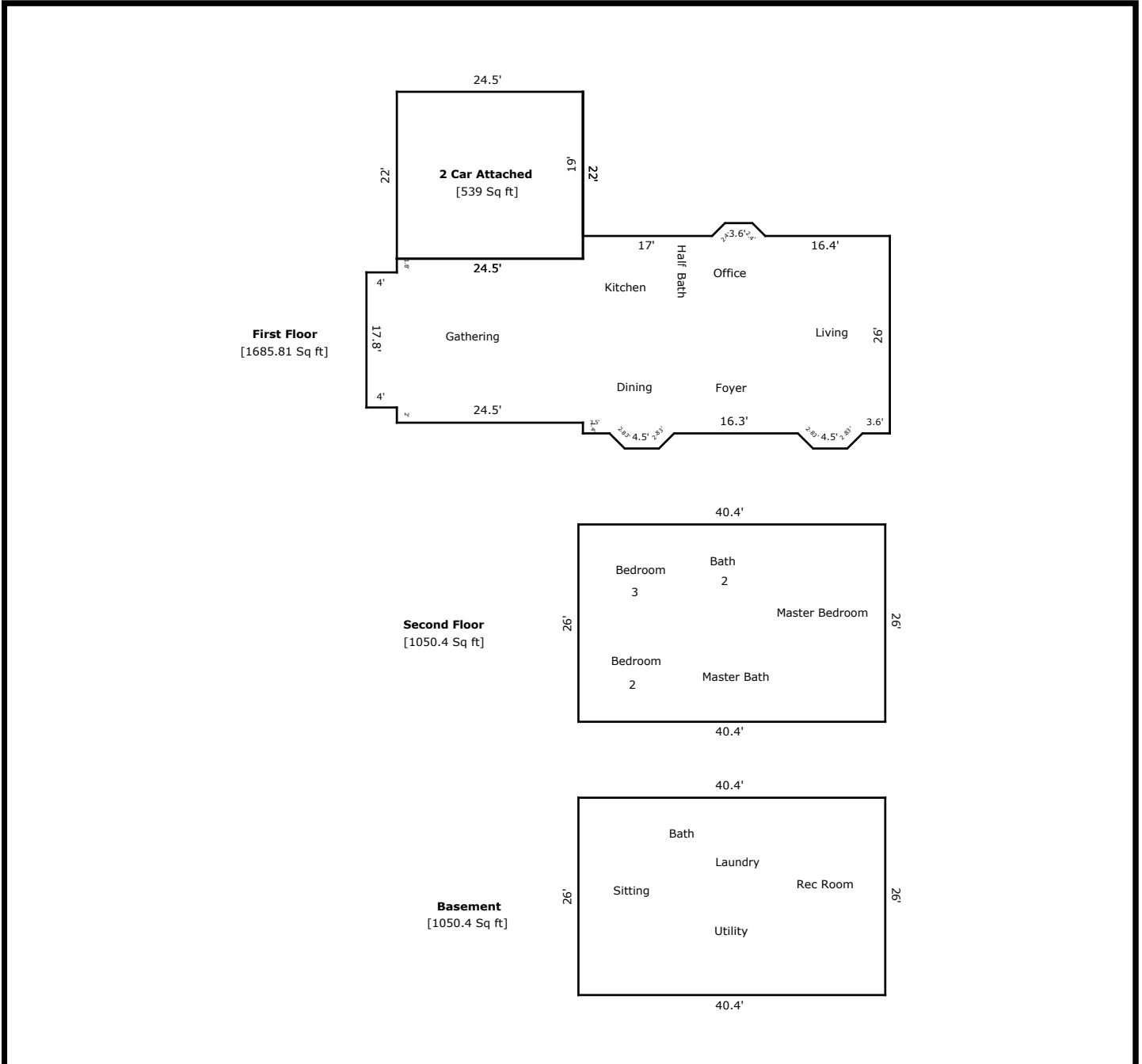

TOTAL Sketch by a la mode, inc.

Area Calculations Summary

Living Area	Calculation Details																								
First Floor	<table style="width: 100%; border-collapse: collapse;"> <tr> <td style="width: 60%;">1685.81 Sq ft</td> <td style="width: 40%;">$17.8 \times 4 = 71.2$</td> </tr> <tr> <td></td> <td>$0.5 \times 2 \times 2 = 2$</td> </tr> <tr> <td></td> <td>$0.5 \times 2 \times 2 = 2$</td> </tr> <tr> <td></td> <td>$4.5 \times 2 = 9$</td> </tr> <tr> <td></td> <td>$0.5 \times 2 \times 2 = 2$</td> </tr> <tr> <td></td> <td>$0.5 \times 2 \times 2 = 2$</td> </tr> <tr> <td></td> <td>$4.5 \times 2 = 9$</td> </tr> <tr> <td></td> <td>$0.5 \times 1.7 \times 1.7 = 1.44$</td> </tr> <tr> <td></td> <td>$0.5 \times 1.7 \times 1.7 = 1.44$</td> </tr> <tr> <td></td> <td>$3.6 \times 1.7 = 6.12$</td> </tr> <tr> <td></td> <td>$21.6 \times 24.5 = 529.2$</td> </tr> <tr> <td></td> <td>$40.4 \times 26 = 1050.4$</td> </tr> </table>	1685.81 Sq ft	$17.8 \times 4 = 71.2$		$0.5 \times 2 \times 2 = 2$		$0.5 \times 2 \times 2 = 2$		$4.5 \times 2 = 9$		$0.5 \times 2 \times 2 = 2$		$0.5 \times 2 \times 2 = 2$		$4.5 \times 2 = 9$		$0.5 \times 1.7 \times 1.7 = 1.44$		$0.5 \times 1.7 \times 1.7 = 1.44$		$3.6 \times 1.7 = 6.12$		$21.6 \times 24.5 = 529.2$		$40.4 \times 26 = 1050.4$
1685.81 Sq ft	$17.8 \times 4 = 71.2$																								
	$0.5 \times 2 \times 2 = 2$																								
	$0.5 \times 2 \times 2 = 2$																								
	$4.5 \times 2 = 9$																								
	$0.5 \times 2 \times 2 = 2$																								
	$0.5 \times 2 \times 2 = 2$																								
	$4.5 \times 2 = 9$																								
	$0.5 \times 1.7 \times 1.7 = 1.44$																								
	$0.5 \times 1.7 \times 1.7 = 1.44$																								
	$3.6 \times 1.7 = 6.12$																								
	$21.6 \times 24.5 = 529.2$																								
	$40.4 \times 26 = 1050.4$																								
Second Floor	<table style="width: 100%; border-collapse: collapse;"> <tr> <td style="width: 60%;">1050.4 Sq ft</td> <td style="width: 40%;">$40.4 \times 26 = 1050.4$</td> </tr> </table>	1050.4 Sq ft	$40.4 \times 26 = 1050.4$																						
1050.4 Sq ft	$40.4 \times 26 = 1050.4$																								
Basement	<table style="width: 100%; border-collapse: collapse;"> <tr> <td style="width: 60%;">1050.4 Sq ft</td> <td style="width: 40%;">$40.4 \times 26 = 1050.4$</td> </tr> </table>	1050.4 Sq ft	$40.4 \times 26 = 1050.4$																						
1050.4 Sq ft	$40.4 \times 26 = 1050.4$																								
Total Living Area (Rounded):	3787 Sq ft																								
Non-living Area																									
2 Car Attached	<table style="width: 100%; border-collapse: collapse;"> <tr> <td style="width: 60%;">539 Sq ft</td> <td style="width: 40%;">$24.5 \times 22 = 539$</td> </tr> </table>	539 Sq ft	$24.5 \times 22 = 539$																						
539 Sq ft	$24.5 \times 22 = 539$																								