

### Subject Photo Page

Borrower							
Property Address	3712 S View Cir						
City	Knoxville	County	Knox	State	TN	Zip Code	37920
Lender/Client	Jeremy Pearson						



**Subject Front**



**Subject Street**

**Supplemental Addendum**

File No. 0052458

Borrower							
Property Address	3712 S View Cir						
City	Knoxville	County	Knox	State	TN	Zip Code	37920
Lender/Client	Jeremy Pearson						

**Measurements for 3712 S View Circle**

<b>1st Floor</b>	<b>1839 sq ft</b>
<b>2nd Floor</b>	<b>485 sq ft</b>
<b>Unfinished Basement</b>	<b>1839 sq ft</b>
<b>Attic</b>	<b>676 sq ft</b>
<b>Garage</b>	<b>447 sq ft</b>

The above measurements are completed according to appraisal industry standards.

**Interior Room Measurements**

<b><u>1st Floor</u></b>	
Dining Room	10.5 x 11.5
Living Room	16 x 15
Bed	11 x 11
Bath	8 x 8
Bed	11 x 11
Eat in Kitchen	19 x 9
Main Bed	15 x 14
Main Bath	15 x 9
<b><u>2nd Floor</u></b>	
Bath	10 x 9
Office Loft	17.5 x 9
Bonus Room	20.5 x 12.5

### Building Sketch

Borrower				
Property Address	3712 S View Cir			
City	Knoxville	County	Knox	State TN Zip Code 37920
Lender/Client	Jeremy Pearson			

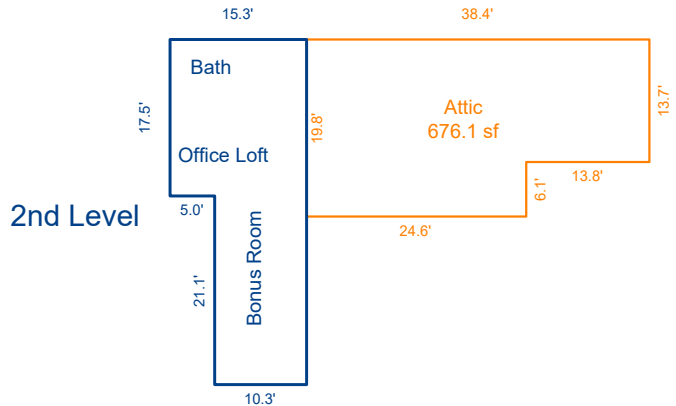
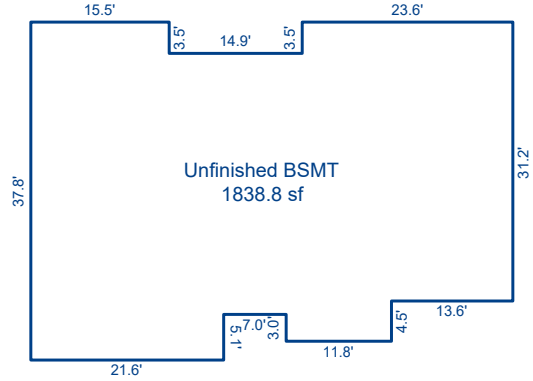
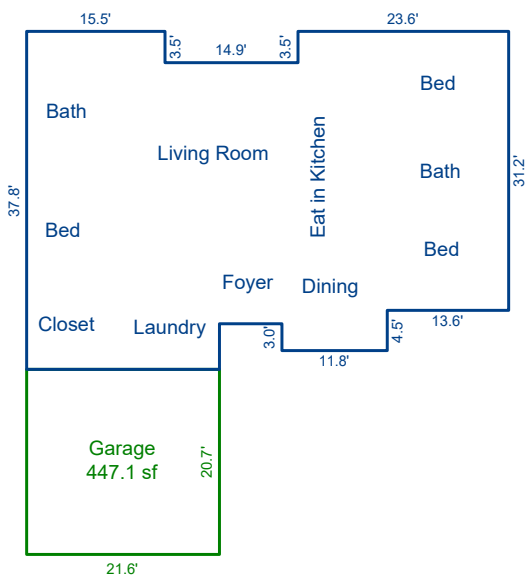

Sketch by Apex Sketch

AREA CALCULATIONS SUMMARY						AREA CALCULATIONS BREAKDOWN				
Code	Description	Factor	Net Size	Perimeter	Net Totals	Name	Base x	Height x	Width =	Area
GLA1	First Floor	1.0	1838.8	196.6	1838.8	First Floor		31.2 x	23.6 =	736.3
GLA2	Second Floor	1.0	485.1	107.8	485.1			10.0 x	4.5 =	45.0
BSMT	Unfinished BSMT	1.0	1838.8	196.6	1838.8			30.4 x	29.2 =	887.7
GAR	Garage	1.0	447.1	84.6	447.1			3.0 x	1.8 =	5.4
OTH	Attic	1.0	676.1	116.4	676.1			21.6 x	5.1 =	110.2
								15.5 x	3.5 =	54.3
						Second Floor		38.6 x	10.3 =	397.6
								17.5 x	5.0 =	87.5
	Net LIVABLE	cnt	2 (rounded)		2,324	8 total items			(rounded)	2,324