

# INVOICE

**FROM:**

Advanced Appraisal Services  
 PO Box 11373  
 Knoxville, TN 37939-1373

Telephone Number: (865) 588-4008 Fax Number:

**TO:**

Stephanie Bushore

E-Mail:  
 Telephone Number: Fax Number:  
 Alternate Number:

INVOICE NUMBER	
0052552	
DATES	
Invoice Date:	06/22/2021
Due Date:	
REFERENCE	
Internal Order #:	0052552
Lender Case #:	
Client File #:	
FHA/VA Case #:	
Main File # on form:	0052552
Other File # on form:	0052552
Federal Tax ID:	62-1867763
Employer ID:	

**DESCRIPTION**

Lender: N/A Client: Stephanie Bushore  
 Purchaser/Borrower: N/A  
 Property Address: 1312 Graycreek Ln  
 City: Knoxville  
 County: Knox State: TN Zip: 37923  
 Legal Description: Lot 9 Meadow Wind S/D

**FEES**

**AMOUNT**

measure	75.00
<b>SUBTOTAL</b>	
	75.00

**PAYMENTS**

**AMOUNT**

Check #:	Date:	Description:	
Check #:	Date:	Description:	
Check #:	Date:	Description:	
<b>SUBTOTAL</b>			0
<b>TOTAL DUE</b>			<b>\$ 75.00</b>

**Supplemental Addendum**

File No. 0052552

Borrower	N/A				
Property Address	1312 Graycreek Ln				
City	Knoxville	County	Knox	State	TN Zip Code 37923
Lender/Client	N/A				

**Measurements for 1312 Graycreek Ln**

- 1st Floor**                      **1165 square feet**
- Finished Basement**        **536 square feet**
- Unfinished Basement**      **561 square feet**

The above measurements are completed according to appraisal industry standards.

Signature \_\_\_\_\_  
 Name Charles Skalet  
 Date Signed 06/21/2021  
 State Certification # CR-2399                      State TN  
 Or State License # \_\_\_\_\_ State \_\_\_\_\_

Signature \_\_\_\_\_  
 Name \_\_\_\_\_  
 Date Signed \_\_\_\_\_  
 State Certification # \_\_\_\_\_ State \_\_\_\_\_  
 Or State License # \_\_\_\_\_ State \_\_\_\_\_

### Subject Photo Page

Borrower	N/A				
Property Address	1312 Graycreek Ln				
City	Knoxville	County	Knox	State	TN      Zip Code 37923
Lender/Client	N/A				



**Subject Front**

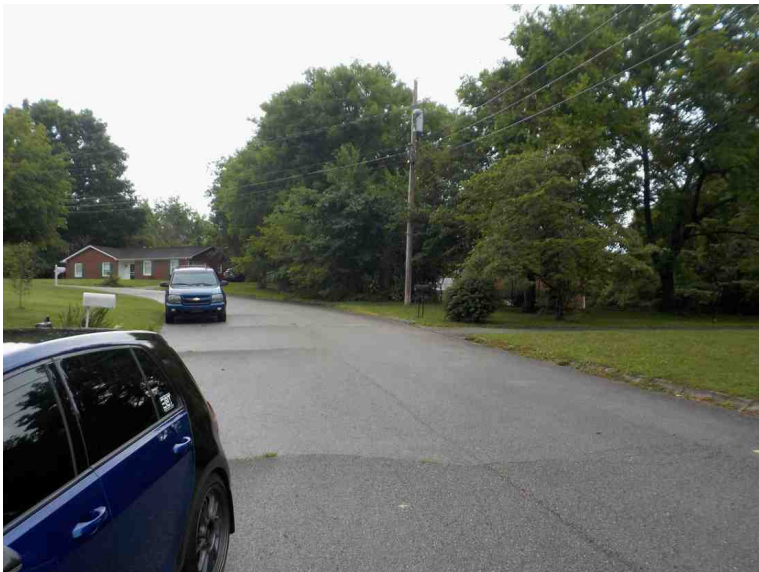

**Subject Street**

### Building Sketch

Borrower	N/A				
Property Address	1312 Graycreek Ln				
City	Knoxville	County	Knox	State	TN
Lender/Client	N/A				
				Zip Code	37923

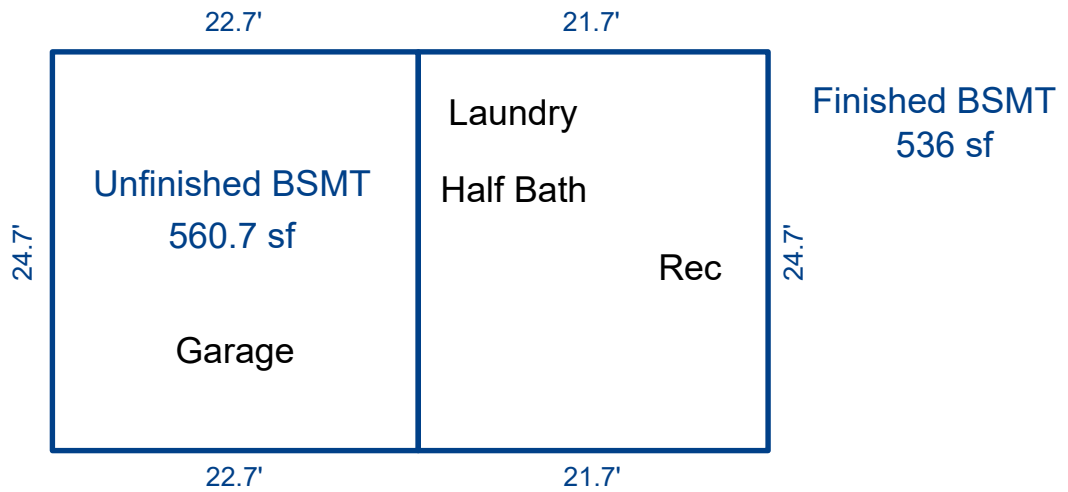
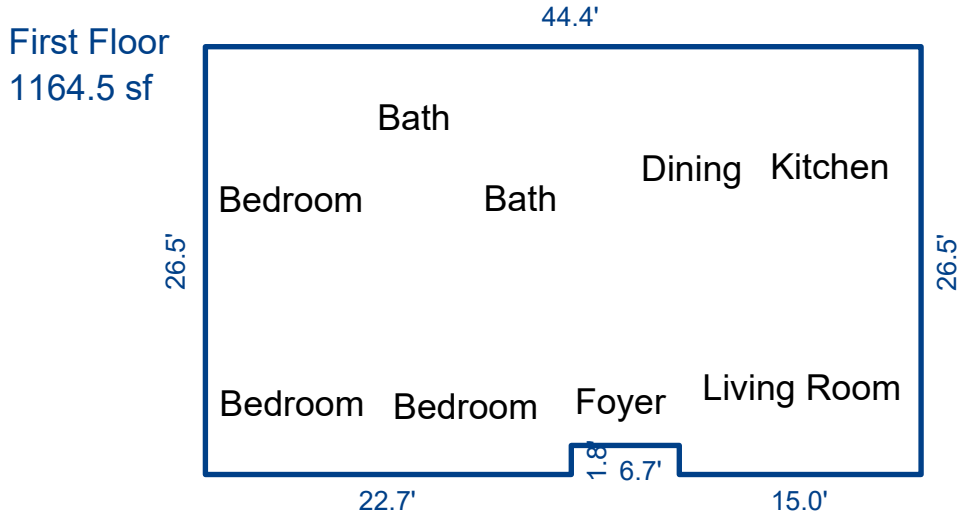

Sketch by Apex Sketch

AREA CALCULATIONS SUMMARY						AREA CALCULATIONS BREAKDOWN				
Code	Description	Factor	Net Size	Perimeter	Net Totals	Name	Base x	Height x	Width =	Area
GLA1	First Floor	1.0	1164.5	145.4	1164.5	First Floor	44.4 x	24.7 =		1096.7
BSMT	Unfinished BSMT	1.0	560.7	94.8	1096.7		15.0 x	1.8 =		27.0
	Finished BSMT	1.0	536.0	92.8			22.7 x	1.8 =		40.9
	Net LIVABLE	cnt	1 (rounded)		1,165	3 total items			(rounded)	1,165