

INVOICE

FROM:

Advanced Appraisal Services
 Advanced Appraisal Services
 PO Box 11373
 Knoxville, TN 37939-1373

Telephone Number: (865) 588-4008 Fax Number:

TO:

The Holli McCray Group

 Knoxville, TN

E-Mail: verdeaux@kw.com
 Telephone Number: (865) 851-0181 Fax Number:
 Alternate Number:

INVOICE NUMBER	
0052444	
DATES	
Invoice Date:	06/04/2021
Due Date:	06/04/2021
REFERENCE	
Internal Order #:	0052444
Lender Case #:	
Client File #:	
FHA/VA Case #:	
Main File # on form:	0052444
Other File # on form:	0052444
Federal Tax ID:	62-1867763
Employer ID:	

DESCRIPTION

Lender: The Holli McCray Group	Client: The Holli McCray Group
Purchaser/Borrower: The Holli McCray Group	
Property Address: 12601 Hartsfield	
City: Knoxville	
County: Knox	State: TN Zip: 37932
Legal Description:	

FEES

AMOUNT

measurement	75.00
Interior	0.00
SUBTOTAL	
	75.00

PAYMENTS

AMOUNT

Check #:	Date:	Description:	
Check #:	Date:	Description:	
Check #:	Date:	Description:	
SUBTOTAL			0
TOTAL DUE			\$ 75.00

Supplemental Addendum

File No. 0052444

Borrower	The Holli McCray Group		
Property Address	12601 Hartsfield		
City	Knoxville	County	Knox
		State	TN
		Zip Code	37932
Lender/Client	The Holli McCray Group		

12601 Hartsfield- 3123 sq ft

1st Level- 1628

Half Bath 7 x 3
Dining 14 x 12
Kitchen 15 x 12
Breakfast 9 x 8
Living 21 x 15
Laundry 10 x 5
Master Bed 17 x 14
Master Bath 11 x 9

2nd Level- 1495

Storage 16 x 10
Bonus 23 x 16
Bed 2 13 x 13
Bath 12 x 6
Bed 3 14 x 12
Bed 4 14 x 12

Signature _____
Name Jeremy Skalet
Date Signed _____
State Certification # 3215 State TN
Or State License # _____ State _____

Signature _____
Name _____
Date Signed _____
State Certification # _____ State _____
Or State License # _____ State _____

Subject Photo Page

Borrower	The Holli McCray Group						
Property Address	12601 Hartsfield						
City	Knoxville	County	Knox	State	TN	Zip Code	37932
Lender/Client	The Holli McCray Group						



Subject Front

12601 Hartsfield
Sales Price
Gross Living Area 3,124
Total Rooms
Total Bedrooms
Total Bathrooms
Location
View
Site
Quality
Age



Subject Rear

Subject Street

Building Sketch

Borrower	The Holli McCray Group				
Property Address	12601 Hartsfield				
City	Knoxville	County	Knox	State	TN
Lender/Client	The Holli McCray Group				
				Zip Code	37932

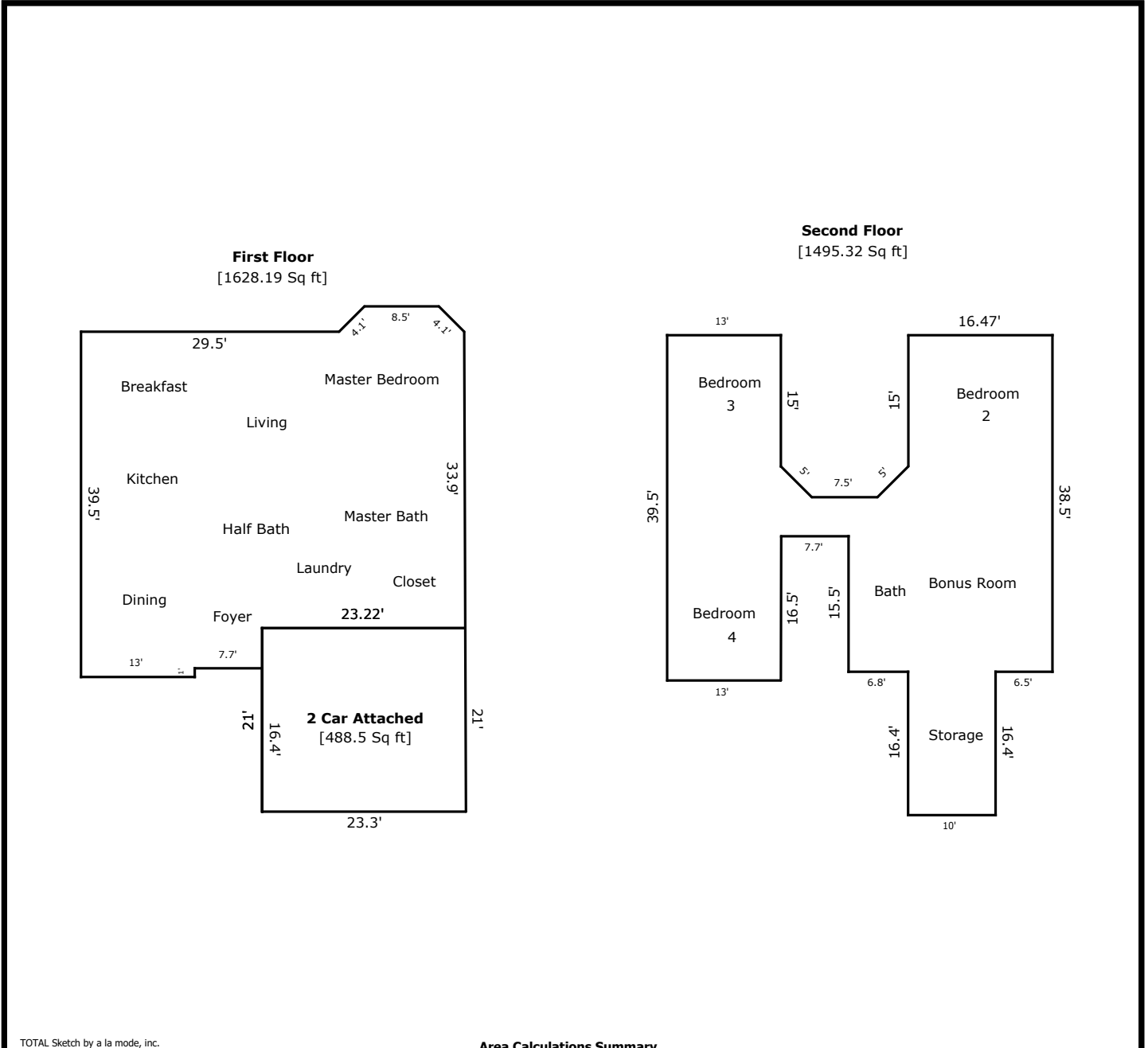

TOTAL Sketch by a la mode, inc.

Area Calculations Summary

Living Area	Area	Calculation Details
First Floor	1628.19 Sq ft	$0.5 \times 2.9 \times 2.9 = 4.2$ $0.5 \times 2.9 \times 2.9 = 4.2$ $8.5 \times 2.9 = 24.65$ $39.5 \times 13 = 513.5$ $7.7 \times 4.6 = 35.42$ $33.9 \times 30.8 = 1044.12$ $0.5 \times 33.9 \times 0.12 = 2.09$
Second Floor	1495.32 Sq ft	$39.5 \times 13 = 513.5$ $16.47 \times 15 = 247.04$ $0.5 \times 3.54 \times 3.54 = 6.25$ $16.47 \times 3.54 = 58.23$ $0.5 \times 3.54 \times 3.54 = 6.25$ $31.04 \times 4.46 = 138.58$ $0.5 \times 0.04 \times 16.5 = 0.33$ $23.3 \times 15.5 = 361.15$ $10 \times 16.4 = 164$
Total Living Area (Rounded):	3124 Sq ft	
Non-living Area		
2 Car Attached	488.5 Sq ft	$21 \times 23.22 = 487.69$ $0.5 \times 21 \times 0.08 = 0.8$