

Supplemental Addendum

File No. 0052340

Borrower					
Property Address 4115 Jomandowa Dr					
City	Knoxville	County	Knox	State	TN
Zip Code		37919			
Lender/Client Rachael Wedekind					

4115 Jomandowa Dr

Main Level 1538 sq ft

Unfinished Basement 662 sq ft

Interior Rooms

- Living 18 x 13.5**
- Dining 11 x 10**
- Kitchen 15 x 10**
- Family 17.5 x 15**
- Bedroom 14 x 12**
- Bath 10 x 9**
- Bedroom 14 x 12**
- Laundry Closet 5.5 x 3**

Signature _____
Name Charles Skalet
Date Signed 05/26/2021
State Certification # CR-2399 State TN
Or State License # _____ State _____

Signature _____
Name _____
Date Signed _____
State Certification # _____ State _____
Or State License # _____ State _____

Subject Photo Page

Borrower				
Property Address	4115 Jomandowa Dr			
City	Knoxville	County	Knox	State TN Zip Code 37919
Lender/Client	Rachael Wedekind			



Subject Front

Subject Rear



Subject Street

Building Sketch

Borrower					
Property Address 4115 Jomandowa Dr					
City	Knoxville	County	Knox	State	TN
Lender/Client Rachael Wedekind				Zip Code	37919

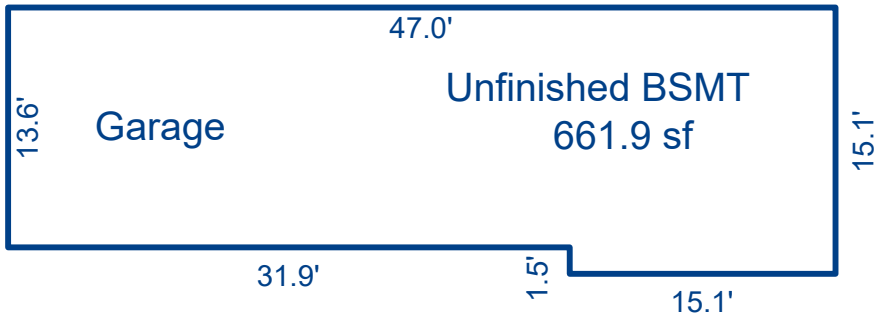
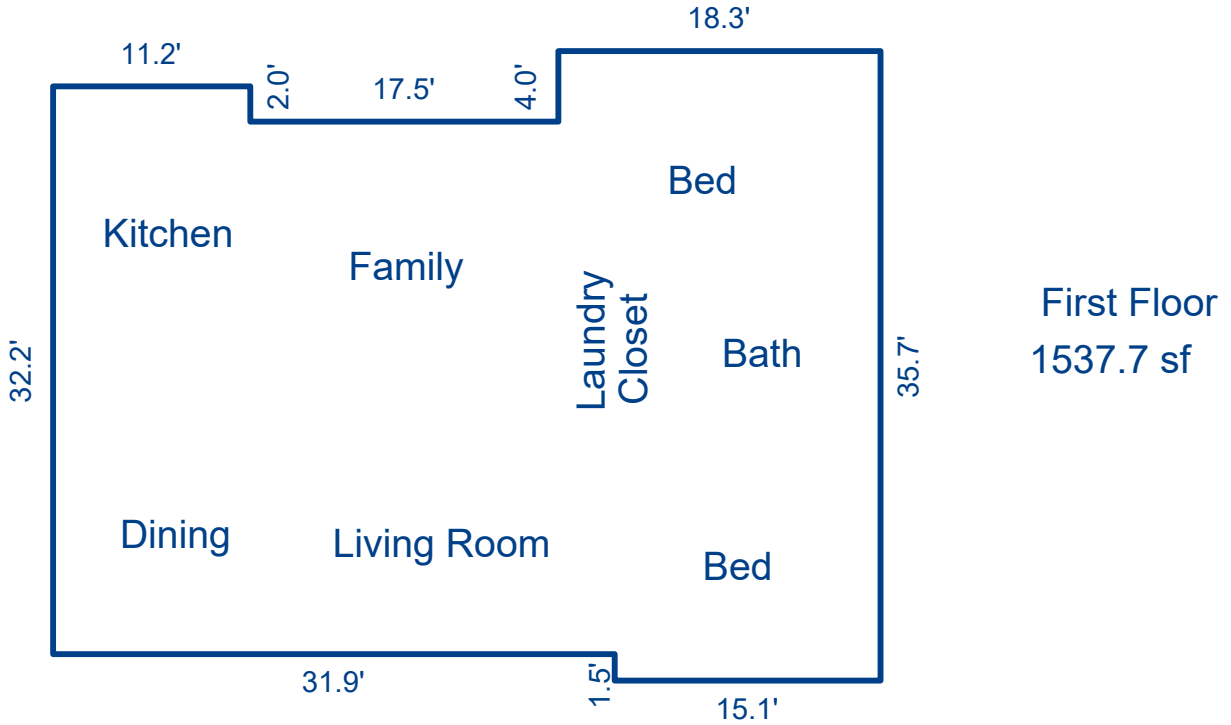

Sketch by Apex Sketch

AREA CALCULATIONS SUMMARY						AREA CALCULATIONS BREAKDOWN				
Code	Description	Factor	Net Size	Perimeter	Net Totals	Name	Base x	Height x	Width =	Area
GLA1	First Floor	1.0	1537.7	169.4	1537.7	First Floor	35.7 x	15.1 =		539.1
BSMT	Unfinished BSMT	1.0	661.9	124.2	661.9		31.9 x	30.2 =		963.4
							11.2 x	2.0 =		22.4
							4.0 x	3.2 =		12.8
	Net LIVABLE	cnt	1 (rounded)		1,538	4 total items			(rounded)	1,538