

INVOICE

FROM:

Advanced Appraisal Services
 Advanced Appraisal Services
 PO Box 11373
 Knoxville, TN 37939-1373

Telephone Number: (865) 588-4008

Fax Number:

TO:

The Holli McCray Group

Knoxville, TN

E-Mail: verdeaux@kw.com

Telephone Number: (865) 851-0181

Fax Number:

Alternate Number:

INVOICE NUMBER

0052254

DATES

Invoice Date: 05/13/2021

Due Date: 02/04/2021

REFERENCE

Internal Order #: 0052254

Lender Case #:

Client File #:

FHA/VA Case #:

Main File # on form: 0052254

Other File # on form: 0052254

Federal Tax ID: 62-1867763

Employer ID:

DESCRIPTION

Lender: The Holli McCray Group

Client: The Holli McCray Group

Purchaser/Borrower: The Holli McCray Group

Property Address: 10256 Boston

City: Knoxville

County:

State: TN

Zip: 37932

Legal Description:

FEES

AMOUNT

Measurement
 interior

75.00
 0.00

SUBTOTAL

75.00

PAYMENTS

AMOUNT

Check #: Date: Description:
 Check #: Date: Description:
 Check #: Date: Description:

SUBTOTAL

0

TOTAL DUE

\$

75.00

Supplemental Addendum

File No. 0052254

Borrower	The Holli McCray Group		
Property Address	10256 Boston		
City	Knoxville	County	State TN Zip Code 37932
Lender/Client	The Holli McCray Group		

10256 Boston- 1316 sq ft

- Living 18 x 13
- Kitchen 14 x 13
- Dining 13 x 11
- Bath 2 8 x 5
- Laundry 6 x 6
- Bed 2 12 x 9
- Bed 3 10 x 10
- Master Bed 13 x 11
- Master Bath 9 x 5

Signature _____
Name Jeremy Skalet
Date Signed _____
State Certification # 3215 State TN
Or State License # _____ State _____

Signature _____
Name _____
Date Signed _____
State Certification # _____ State _____
Or State License # _____ State _____

Subject Photo Page

Borrower	The Holli McCray Group				
Property Address	10256 Boston				
City	Knoxville	County	State	TN	Zip Code 37932
Lender/Client	The Holli McCray Group				



Subject Front

10256 Boston

1,316



Subject Rear

Subject Street

Building Sketch

Borrower	The Holli McCray Group			
Property Address	10256 Boston			
City	Knoxville	County	State	TN
Lender/Client	The Holli McCray Group			
			Zip Code	37932

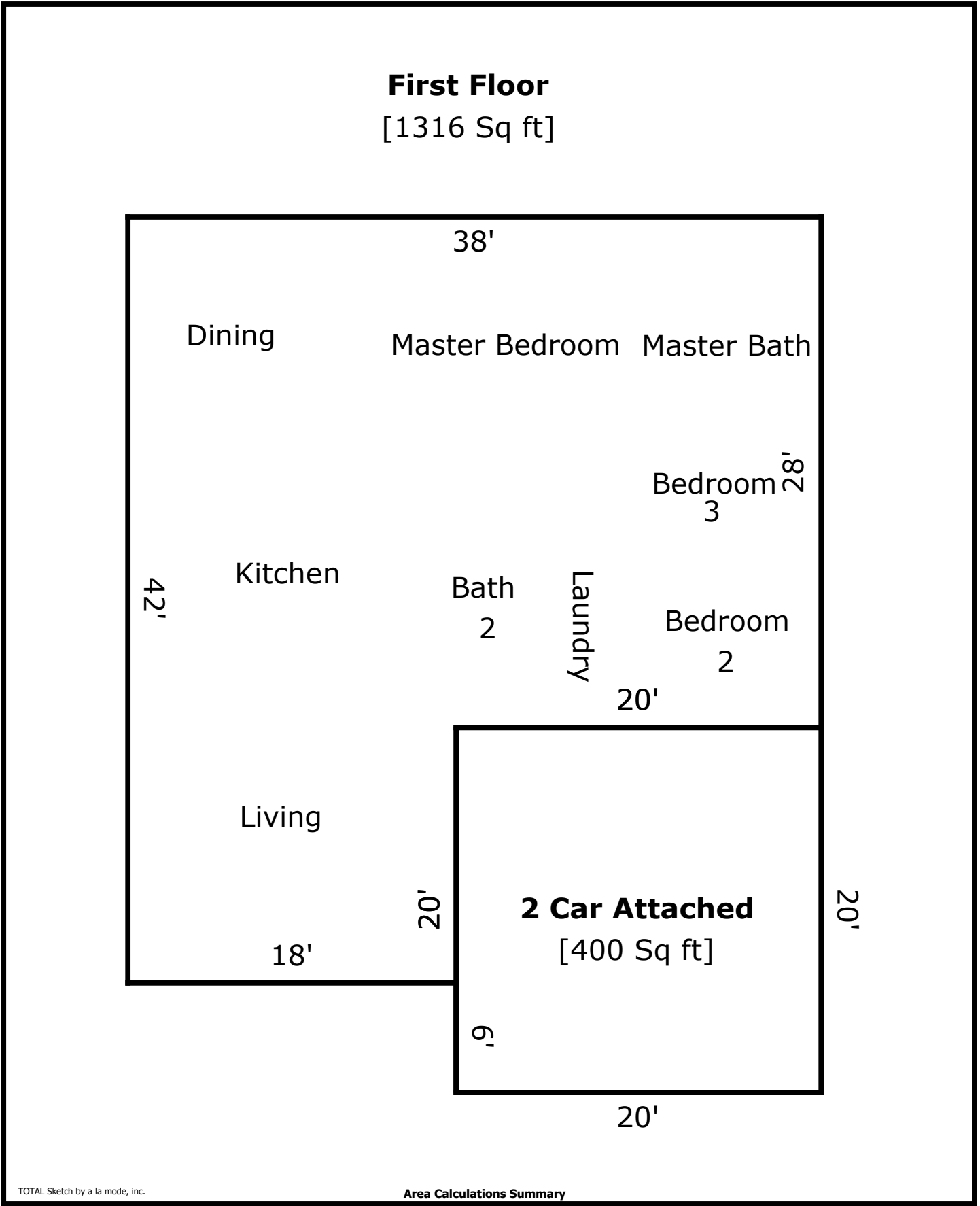

TOTAL Sketch by a la mode, inc.

Area Calculations Summary

Living Area	Calculation Details	
First Floor	1316 Sq ft	18 × 14 = 252 28 × 38 = 1064
Total Living Area (Rounded):	1316 Sq ft	
Non-living Area		
2 Car Attached	400 Sq ft	20 × 20 = 400