

### Subject Photo Page

Borrower	N/A						
Property Address	1900 Shady Hollow Ln						
City	Knoxville	County	Knox	State	TN	Zip Code	37922
Lender/Client	Zach Sale						



**Subject Front**



**Subject Street**

**Supplemental Addendum**

File No. 0051877

Borrower	N/A		
Property Address	1900 Shady Hollow Ln		
City	Knoxville	County	Knox
		State	TN
		Zip Code	37922
Lender/Client	Zach Sale		

**Measurements of 1900 Shady Hollow Ln**

1st Floor 1290 square feet  
 2nd Floor 1574 square feet  
 Total 2864 square feet  
 Finished Basement 1301 square feet  
 Garage 460 square feet



Signature \_\_\_\_\_  
 Name Charles Skalet  
 Date Signed 04/08/2021  
 State Certification # CR-2399 State TN  
 Or State License # \_\_\_\_\_ State \_\_\_\_\_

Signature \_\_\_\_\_  
 Name \_\_\_\_\_  
 Date Signed \_\_\_\_\_  
 State Certification # \_\_\_\_\_ State \_\_\_\_\_  
 Or State License # \_\_\_\_\_ State \_\_\_\_\_

### Building Sketch

Borrower	N/A			
Property Address	1900 Shady Hollow Ln			
City	Knoxville	County	Knox	State TN Zip Code 37922
Lender/Client	Zach Sale			

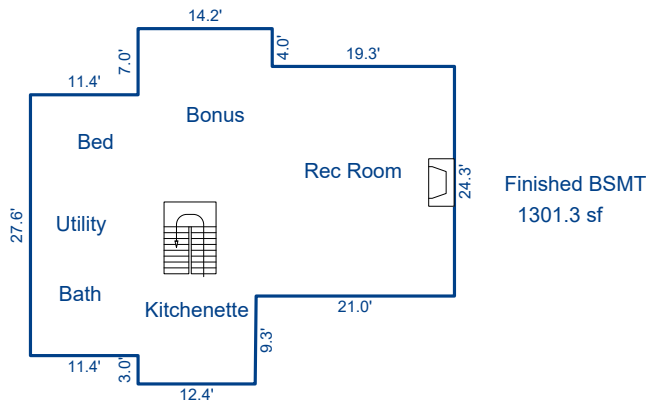
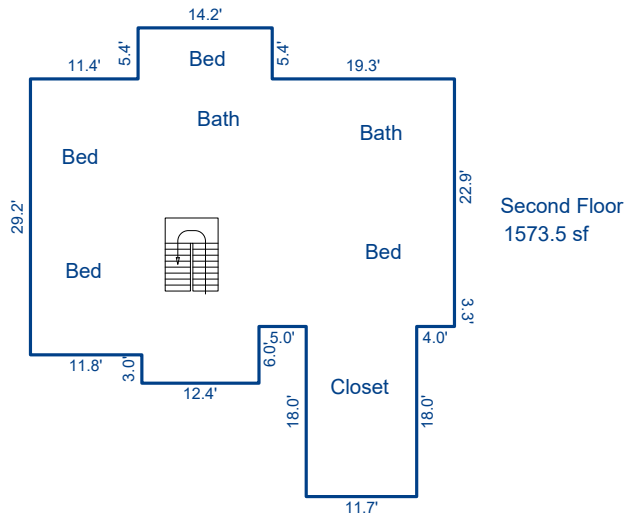
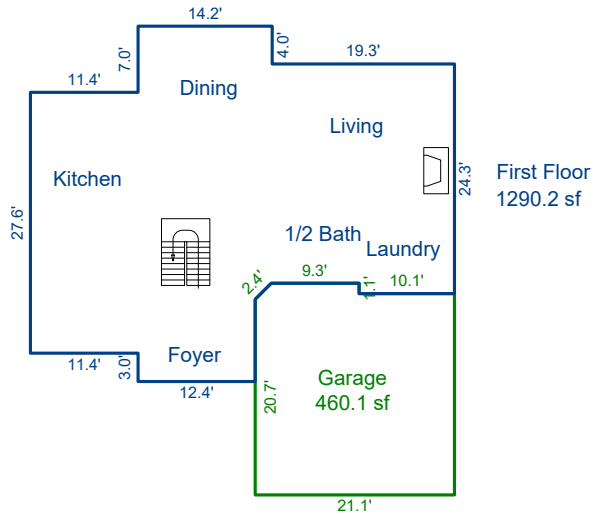

Sketch by Apex Sketch

AREA CALCULATIONS SUMMARY						AREA CALCULATIONS BREAKDOWN					
Code	Description	Factor	Net Size	Perimeter	Net Totals	Name	Base x	Height	x□	Width =	Area
GLA1	First Floor	1.0	1290.2	166.2	1290.2	First Floor		27.6 x		11.4 =	314.6
GLA2	Second Floor	1.0	1573.5	201.0	1573.5			24.9 x		12.4 =	308.8
BSMT	Finished BSMT	1.0	1301.3	164.9	1301.3		0.5 x	2.4 x		1.2 =	1.4
GAR	Garage	1.0	460.1	86.0	460.1			23.2 x		21.1 =	489.5
								10.1 x		1.1 =	11.1
								12.4 x		8.7 =	107.9
						Second Floor		14.2 x		4.0 =	56.8
								14.2 x		5.4 =	76.7
								18.0 x		11.7 =	210.6
								32.2 x		12.4 =	399.3
								29.2 x		11.8 =	344.6
								26.2 x		20.7 =	542.3
	Net LIVABLE	cnt	2 (rounded)		2,864	12 total items				(rounded)	2,864