

Supplemental Addendum

File No. 0051871

Borrower	The Holli McCray Group			
Property Address	607 Country			
City	Lenoir City	County	State	TN Zip Code 37932
Lender/Client	The Holli McCray Group			

607 Country Ln- 4524 sq ft

1st Level- 2262 sq ft

- Dining 14 x 11**
- Living 20 x 19**
- Kitchen 15 x 15**
- Laundry 12 x 9**
- Mud Room 10 x 8**
- Main Bed 14 x 14**
- Main Bath 12 x 9**
- Main Closet 9 x 9**
- Bed 2 12 x 12**
- Bath 2 15 x 6**

Basement- 2262 sq ft

- Rec 52 x 12**
- Family 22 x 19**
- Media 19 x 14**
- Bed 3 16 x 11**
- Bath 3 15 x 6**
- Utility 21 x 9**

Signature _____
Name Jeremy Skalet
Date Signed _____
State Certification # 3215 State TN
Or State License # _____ State _____

Signature _____
Name _____
Date Signed _____
State Certification # _____ State _____
Or State License # _____ State _____

Subject Photo Page

Borrower	The Holli McCray Group					
Property Address	607 Country					
City	Lenoir City	County	State	TN	Zip Code	37932
Lender/Client	The Holli McCray Group					



Subject Front

607 Country



Subject Rear

Subject Street

Building Sketch

Borrower	The Holli McCray Group			
Property Address	607 Country			
City	Lenoir City	County	State	TN
Zip Code	37932			
Lender/Client	The Holli McCray Group			

First Floor
[2261.95 Sq ft]

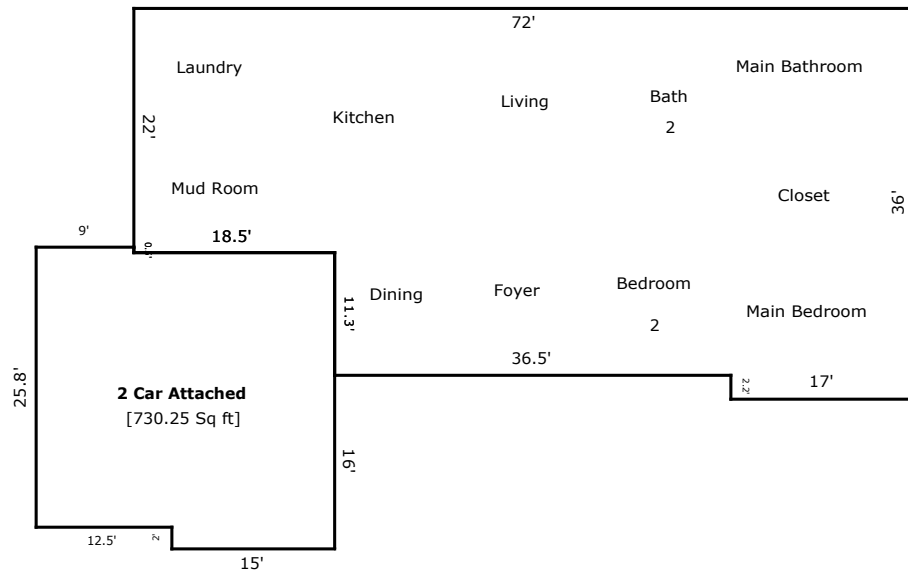

Basement
[2261.95 Sq ft]

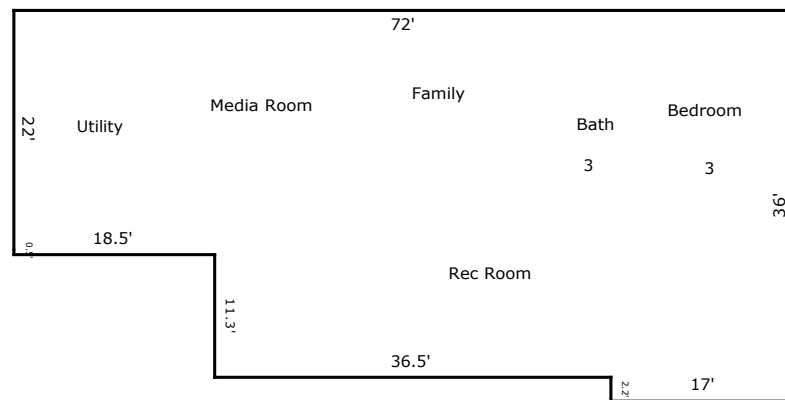

TOTAL Sketch by a la mode, inc.

Area Calculations Summary

Living Area	Area	Calculation Details
First Floor	2261.95 Sq ft	$22.5 \times 18.5 = 416.25$ $33.8 \times 36.5 = 1233.7$ $17 \times 36 = 612$
Basement	2261.95 Sq ft	$22.5 \times 18.5 = 416.25$ $33.8 \times 36.5 = 1233.7$ $17 \times 36 = 612$
Total Living Area (Rounded):	4524 Sq ft	
Non-living Area		
2 Car Attached	730.25 Sq ft	$27.3 \times 15 = 409.5$ $12.5 \times 25.3 = 316.25$ $9 \times 0.5 = 4.5$