



**Supplemental Addendum**

File No. 0051889

Borrower	Kelly Arsenault				
Property Address	3612 Timberlake				
City	Knoxville	County	Knox	State	TN
Lender/Client	Kelly Arsenault				
				Zip Code	37920

**3612 Timberlake Dr- 3037 sq ft**

**1st Level- 2397 sq ft**

**Basement- 640 sq ft**

**Garage- 504 sq ft**

Signature \_\_\_\_\_  
Name Jeremy Skalet  
Date Signed \_\_\_\_\_  
State Certification # 3215 State TN  
Or State License # \_\_\_\_\_ State \_\_\_\_\_

Signature \_\_\_\_\_  
Name \_\_\_\_\_  
Date Signed \_\_\_\_\_  
State Certification # \_\_\_\_\_ State \_\_\_\_\_  
Or State License # \_\_\_\_\_ State \_\_\_\_\_

## Subject Photo Page

Borrower	Kelly Arsenault						
Property Address	3612 Timberlake						
City	Knoxville	County	Knox	State	TN	Zip Code	37920
Lender/Client	Kelly Arsenault						



### Subject Front

3612 Timberlake

3,037



### Subject Rear

### Subject Street

## Building Sketch

Borrower	Kelly Arsenault						
Property Address	3612 Timberlake						
City	Knoxville	County	Knox	State	TN	Zip Code	37920
Lender/Client	Kelly Arsenault						

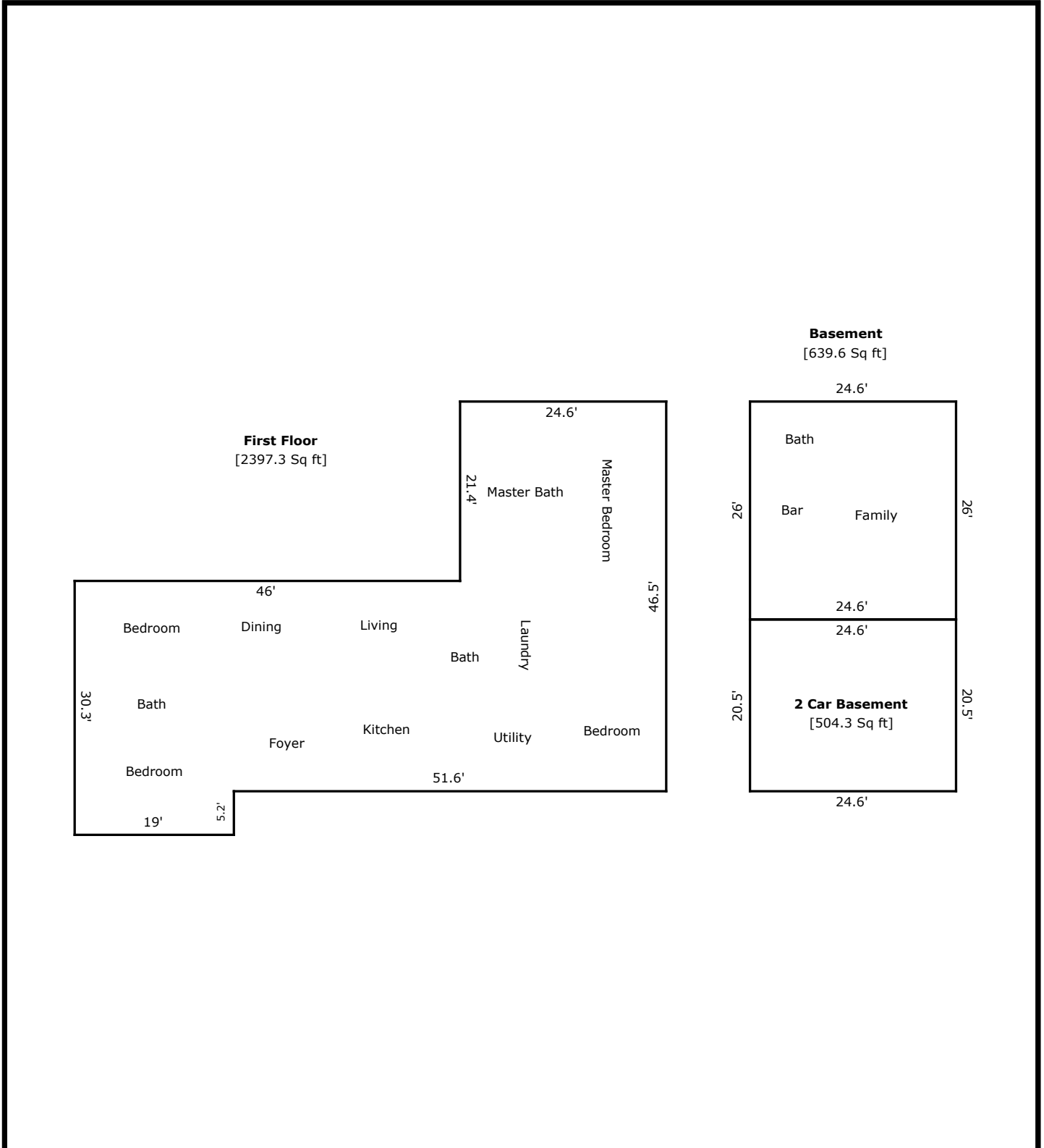

TOTAL Sketch by a la mode, inc.

### Area Calculations Summary

Living Area	Calculation Details	
First Floor	2397.3 Sq ft	24.6 × 21.4 = 526.44 30.3 × 19 = 575.7 51.6 × 25.1 = 1295.16
Basement	639.6 Sq ft	26 × 24.6 = 639.6
<b>Total Living Area (Rounded):</b>	<b>3037 Sq ft</b>	
<b>Non-living Area</b>		
2 Car Basement	504.3 Sq ft	24.6 × 20.5 = 504.3