

INVOICE

FROM:

Advanced Appraisal Services
 Advanced Appraisal Services
 PO Box 11373
 Knoxville, TN 37939-1373

Telephone Number: (865) 588-4008 Fax Number:

TO:

The Holli McCray Group

 Knoxville, TN

E-Mail: verdeaux@kw.com
 Telephone Number: (865) 851-0181 Fax Number:
 Alternate Number:

INVOICE NUMBER	
0051424	
DATES	
Invoice Date:	02/10/2021
Due Date:	02/10/2021
REFERENCE	
Internal Order #:	0051424
Lender Case #:	
Client File #:	
FHA/VA Case #:	
Main File # on form:	0051424
Other File # on form:	0051424
Federal Tax ID:	62-1867763
Employer ID:	

DESCRIPTION

Lender: The Holli McCray Group Client: The Holli McCray Group
 Purchaser/Borrower: The Holli McCray Group
 Property Address: 10224 Poppy
 City: Knoxville
 County: State: TN Zip: 37932
 Legal Description:

FEES

AMOUNT

Measurement	75.00
Interior	0.00
SUBTOTAL	
	75.00

PAYMENTS

AMOUNT

Check #:	Date:	Description:	
Check #:	Date:	Description:	
Check #:	Date:	Description:	
SUBTOTAL			0

TOTAL DUE \$ 75.00

Supplemental Addendum

File No. 0051424

Borrower	The Holli McCray Group			
Property Address	10224 Poppy			
City	Knoxville	County	State	TN Zip Code 37932
Lender/Client	The Holli McCray Group			

10224 Poppy- 2195 sq ft

1st Level- 1607 sq ft

Bed 2 14 x 11

Bath 2 8 x 5

Kitchen 12 x 12

Laundry 8 x 7

Living/Dining 23 x 19

Main Bed 17 x 12

Main Bath 15 x 8

2nd Level- 588 sq ft

Bonus 19 x 8

Bath 3 8 x 5

Bed 3 16 x 12

Signature _____
Name Jeremy Skalet
Date Signed _____
State Certification # 3215 State TN
Or State License # _____ State _____

Signature _____
Name _____
Date Signed _____
State Certification # _____ State _____
Or State License # _____ State _____

Building Sketch

Borrower	The Holli McCray Group			
Property Address	10224 Poppy			
City	Knoxville	County	State	TN
Lender/Client	The Holli McCray Group			
			Zip Code	37932

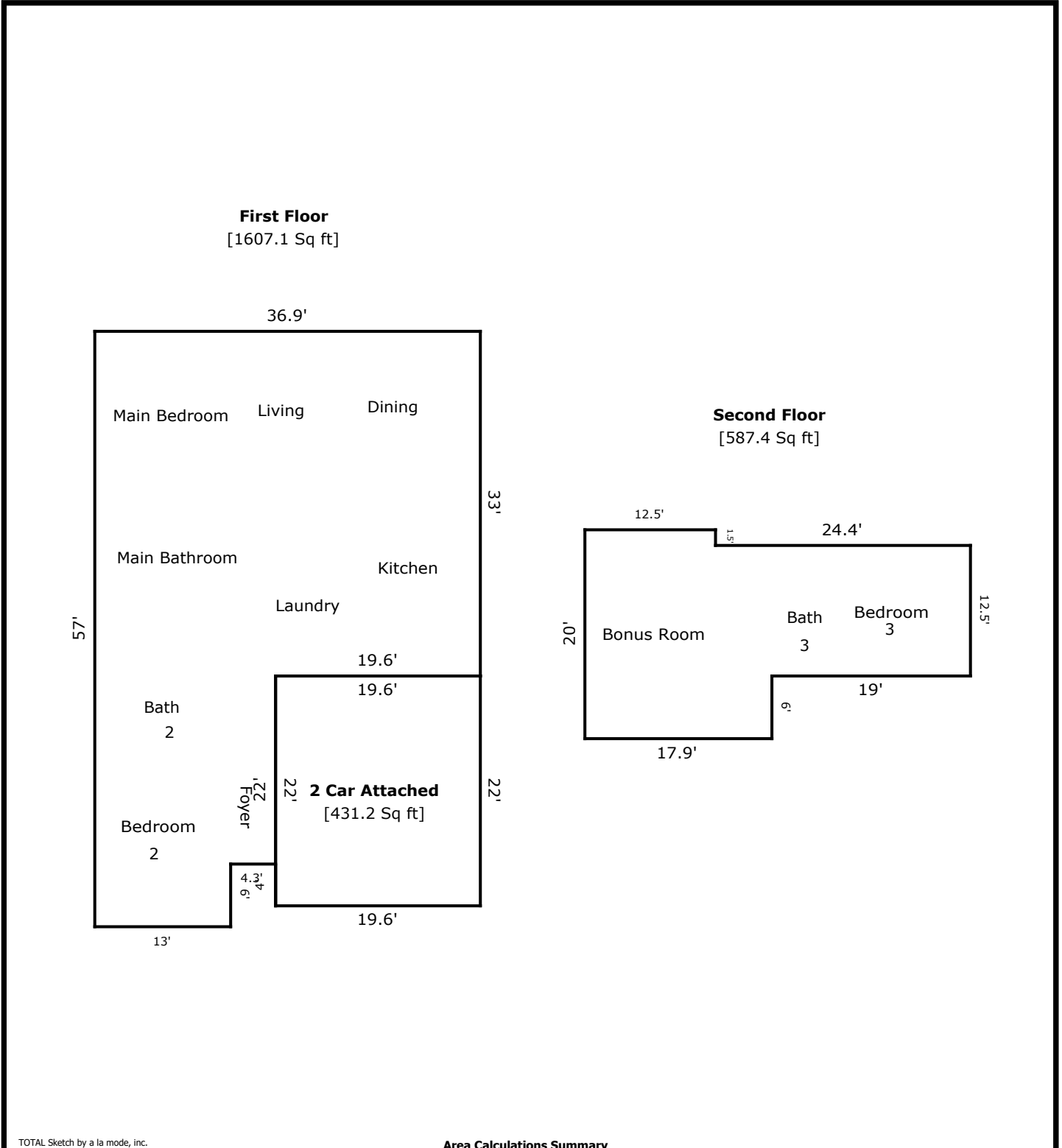

TOTAL Sketch by a la mode, inc.

Area Calculations Summary

Living Area	Calculation Details	
First Floor	1607.1 Sq ft	$36.9 \times 33 = 1217.7$ $17.3 \times 18 = 311.4$ $13 \times 6 = 78$
Second Floor	587.4 Sq ft	$12.5 \times 19 = 237.5$ $17.9 \times 18.5 = 331.15$ $1.5 \times 12.5 = 18.75$
Total Living Area (Rounded):	2195 Sq ft	
Non-living Area		
2 Car Attached	431.2 Sq ft	$19.6 \times 22 = 431.2$

Subject Photo Page

Borrower	The Holli McCray Group				
Property Address	10224 Poppy				
City	Knoxville	County	State	TN	Zip Code 37932
Lender/Client	The Holli McCray Group				



Subject Front

10224 Poppy
Sales Price
Gross Living Area 2,195
Total Rooms
Total Bedrooms
Total Bathrooms
Location
View
Site
Quality
Age



Subject Rear

Subject Street