



# Supplemental Addendum

File No. 0051356

Borrower	The Holli McCray Group		
Property Address	1653 Sugarfield		
City	Knoxville	County	State TN Zip Code 37932
Lender/Client	The Holli McCray Group		

**1653 Sugarfield- 2506 sq ft**

**1st Level- 1690 sq ft**

**Bed 2 13 x 12**  
**Bath 2 9 x 5**  
**Kitchen 20 x 8**  
**Living/Dining 24 x 13**  
**Laundry 7 x 5**  
**Main Bed 19 x 14**  
**Main Bath 12 x 12**  
**Main Closet 12 x 6**

**2nd Level- 816 sq ft**

**Bed 3 13 x 13**  
**Bonus 13 x 13**  
**Bath 3 9 x 5**  
**Bed 4 18 x 13**

Signature \_\_\_\_\_  
Name Jeremy Skalet  
Date Signed \_\_\_\_\_  
State Certification # 3215 State TN  
Or State License # \_\_\_\_\_ State \_\_\_\_\_

Signature \_\_\_\_\_  
Name \_\_\_\_\_  
Date Signed \_\_\_\_\_  
State Certification # \_\_\_\_\_ State \_\_\_\_\_  
Or State License # \_\_\_\_\_ State \_\_\_\_\_

## Subject Photo Page

Borrower	The Holli McCray Group				
Property Address	1653 Sugarfield				
City	Knoxville	County	State	TN	Zip Code 37932
Lender/Client	The Holli McCray Group				



### Subject Front

1653 Sugarfield

2,506

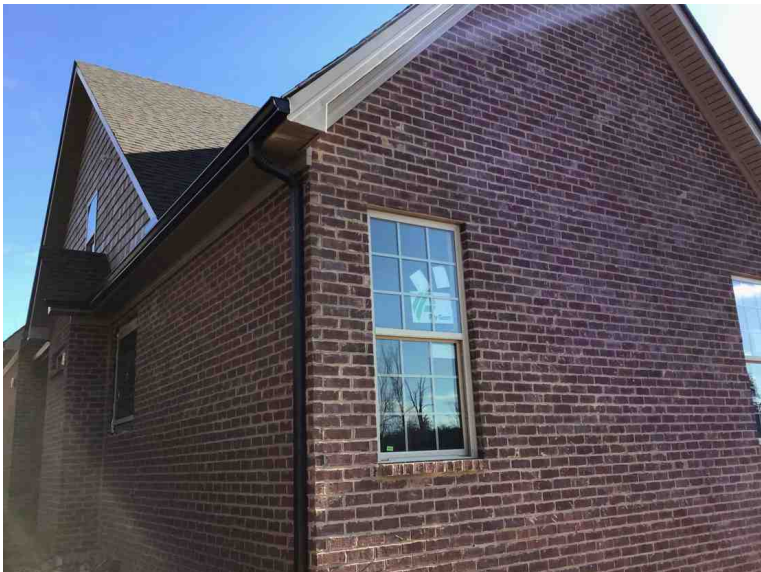

### Subject Rear

### Subject Street

## Building Sketch

Borrower	The Holli McCray Group			
Property Address	1653 Sugarfield			
City	Knoxville	County	State	TN
Zip Code	37932			
Lender/Client	The Holli McCray Group			

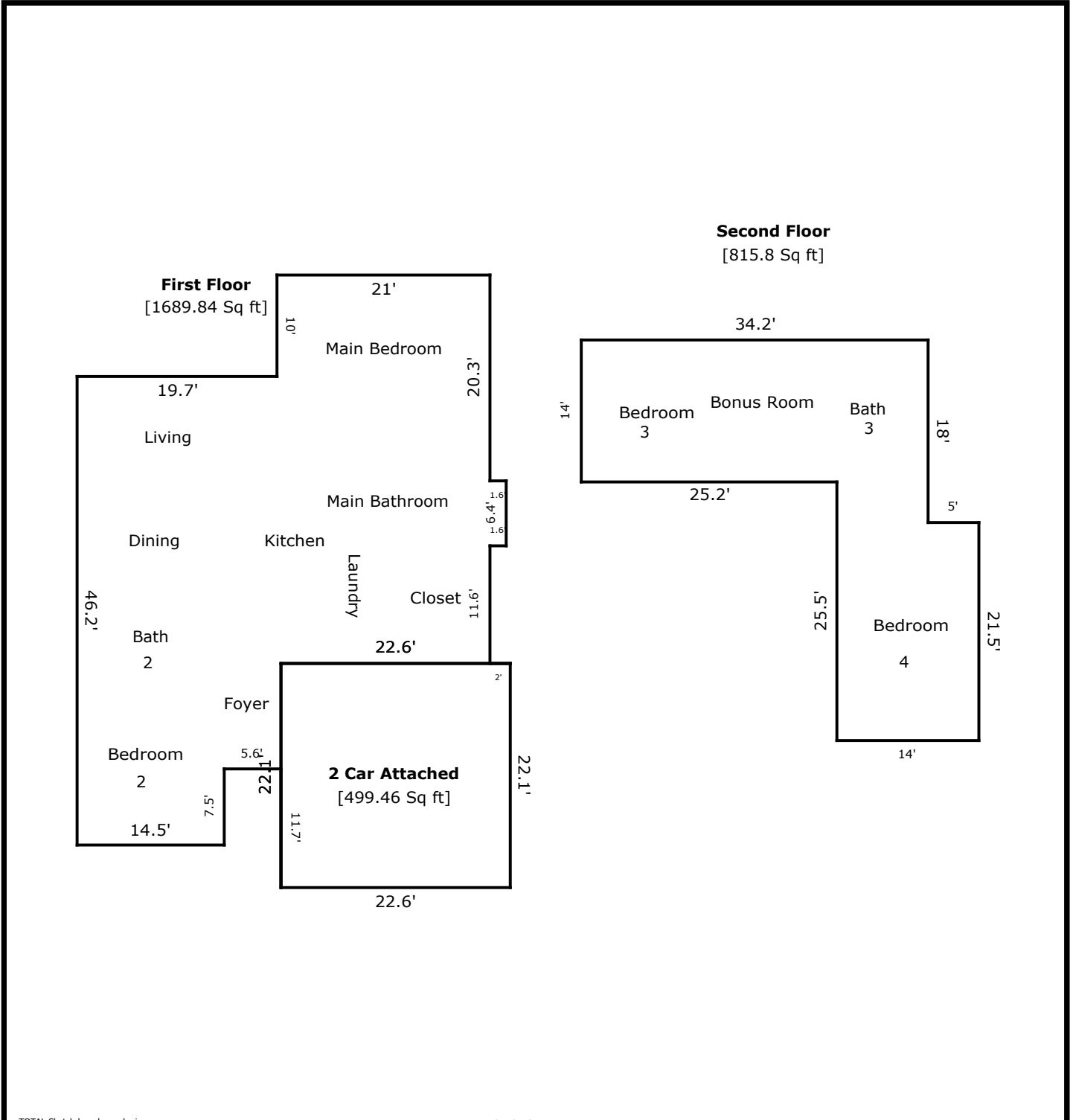

TOTAL Sketch by a la mode, inc.

### Area Calculations Summary

Living Area	Area	Calculation Details
First Floor	1689.84 Sq ft	$6.4 \times 1.6 = 10.24$ $38.3 \times 20.6 = 788.98$ $14.5 \times 7.5 = 108.75$ $20.1 \times 38.7 = 777.87$ $0.4 \times 10 = 4$
Second Floor	815.8 Sq ft	$14 \times 21.5 = 301$ $14 \times 25.2 = 352.8$ $9 \times 18 = 162$
<b>Total Living Area (Rounded):</b>	<b>2506 Sq ft</b>	
<b>Non-living Area</b>		
2 Car Attached	499.46 Sq ft	$22.6 \times 22.1 = 499.46$