

INVOICE

FROM:

Advanced Appraisal Services
 Advanced Appraisal Services
 PO Box 11373
 Knoxville, TN 37939-1373

Telephone Number: (865) 588-4008

Fax Number:

TO:

The Holli McCray Group

Knoxville, TN

E-Mail: verdeaux@kw.com

Telephone Number: (865) 851-0181

Fax Number:

Alternate Number:

INVOICE NUMBER

0051396

DATES

Invoice Date: 02/05/2021

Due Date: 02/05/2021

REFERENCE

Internal Order #: 0051396

Lender Case #:

Client File #:

FHA/VA Case #:

Main File # on form: 0051396

Other File # on form: 0051396

Federal Tax ID: 62-1867763

Employer ID:

DESCRIPTION

Lender: The Holli McCray Group **Client:** The Holli McCray Group
Purchaser/Borrower: The Holli McCray Group
Property Address: 1208 Vermont
City: Knoxville
County: Knox **State:** TN **Zip:** 37932
Legal Description:

FEES

AMOUNT

Measurement	75.00
Interior	0.00
SUBTOTAL	
	75.00

PAYMENTS

AMOUNT

Check #:	Date:	Description:	
Check #:	Date:	Description:	
Check #:	Date:	Description:	
SUBTOTAL			0

TOTAL DUE \$ 75.00

Supplemental Addendum

File No. 0051396

Borrower	The Holli McCray Group		
Property Address	1208 Vermont		
City	Knoxville	County	Knox
Lender/Client	The Holli McCray Group		
	State	TN	Zip Code 37932

1208 Vermont- 1954 sq ft

1st Level- 1482 sq ft

- Living 16 x 14
- Bath 8 x 5
- Kitchen/Dining 18 x 13
- Bath 8 x 5
- Family 20 x 12
- Bed 1 13 x 11
- Bed 2 13 x 10

2nd Level- 472 sq ft

- Bed 3 14 x 12
- Bonus 13 x 12

Signature _____
Name Jeremy Skalet
Date Signed _____
State Certification # 3215 State TN
Or State License # _____ State _____

Signature _____
Name _____
Date Signed _____
State Certification # _____ State _____
Or State License # _____ State _____

Subject Photo Page

Borrower	The Holli McCray Group						
Property Address	1208 Vermont						
City	Knoxville	County	Knox	State	TN	Zip Code	37932
Lender/Client	The Holli McCray Group						



Subject Front

1208 Vermont
Sales Price
Gross Living Area 1,954
Total Rooms
Total Bedrooms
Total Bathrooms
Location
View
Site
Quality
Age



Subject Rear

Subject Street

Building Sketch

Borrower	The Holli McCray Group				
Property Address	1208 Vermont				
City	Knoxville	County	Knox	State	TN
Lender/Client	The Holli McCray Group				
				Zip Code	37932

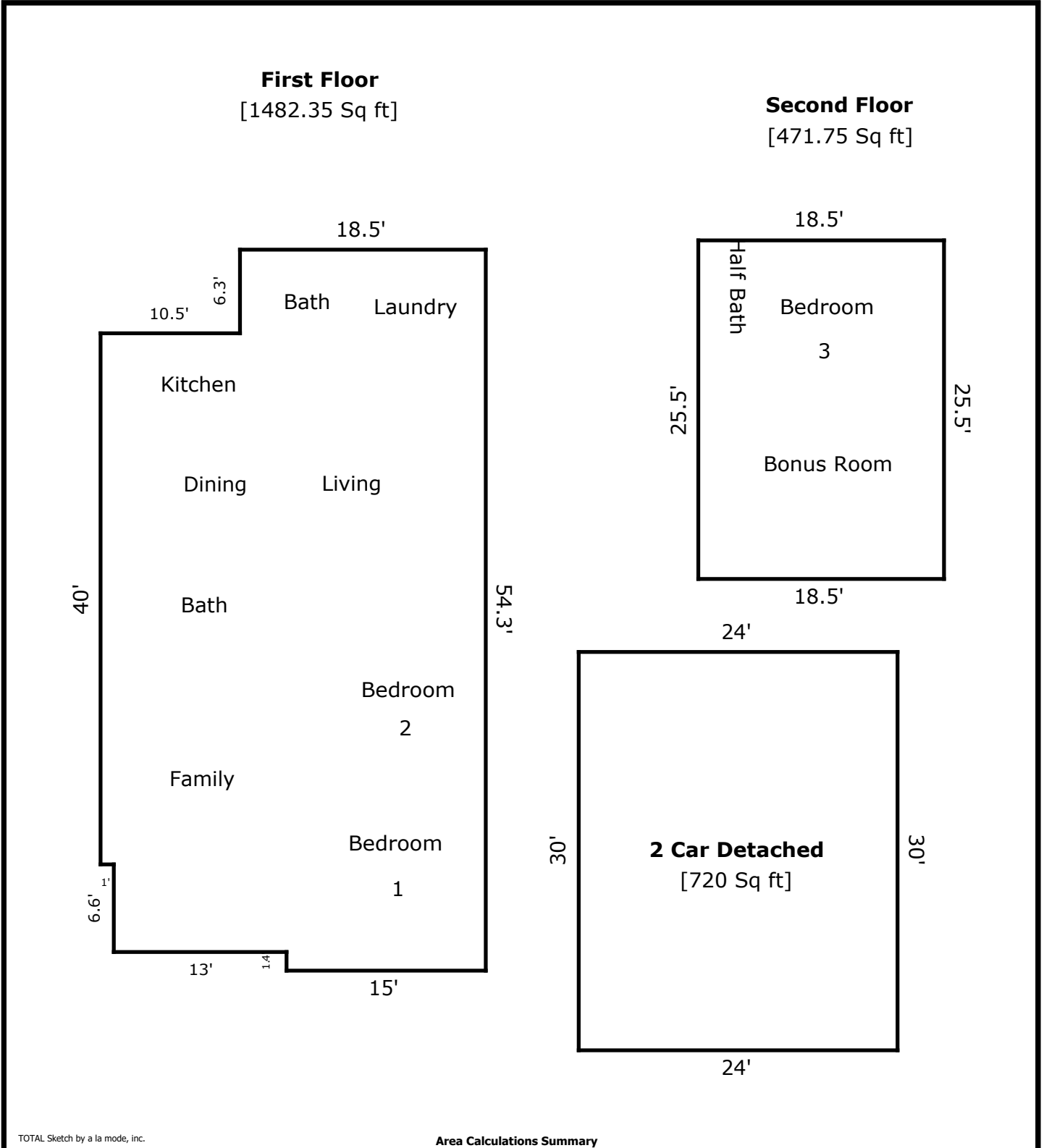

TOTAL Sketch by a la mode, inc.

Area Calculations Summary

Living Area	Area	Calculation Details
First Floor	1482.35 Sq ft	$18.5 \times 6.3 = 116.55$ $29 \times 40 = 1160$ $8 \times 15 = 120$ $6.6 \times 13 = 85.8$
Second Floor	471.75 Sq ft	$25.5 \times 18.5 = 471.75$
Total Living Area (Rounded):	1954 Sq ft	
Non-living Area		
2 Car Detached	720 Sq ft	$30 \times 24 = 720$