



**Supplemental Addendum**

File No. 0050883

Borrower	The Holli McCray Group		
Property Address	102 Spyglass		
City	Clinton	County	Knox
		State	TN
		Zip Code	37932
Lender/Client	The Holli McCray Group		

**102 Spyglass- 2174 sq ft**

- Dining 13 x 12**
- Kitchen/Breakfast 21 x 10**
- Living 19 x 16**
- Bed 2 12 x 10**
- Bed 3 13 x 12**
- Bath 2 10 x 8**
- Bed 4 12 x 12**
- Laundry 11 x 5**
- Main Bed 16 x 15**
- Main Bath 12 x 9**

Signature \_\_\_\_\_  
Name Jeremy Skalet  
Date Signed \_\_\_\_\_  
State Certification # 3215 State TN  
Or State License # \_\_\_\_\_ State \_\_\_\_\_

Signature \_\_\_\_\_  
Name \_\_\_\_\_  
Date Signed \_\_\_\_\_  
State Certification # \_\_\_\_\_ State \_\_\_\_\_  
Or State License # \_\_\_\_\_ State \_\_\_\_\_

## Building Sketch

Borrower	The Holli McCray Group			
Property Address	102 Spyglass			
City	Clinton	County	Knox	State TN      Zip Code 37932
Lender/Client	The Holli McCray Group			

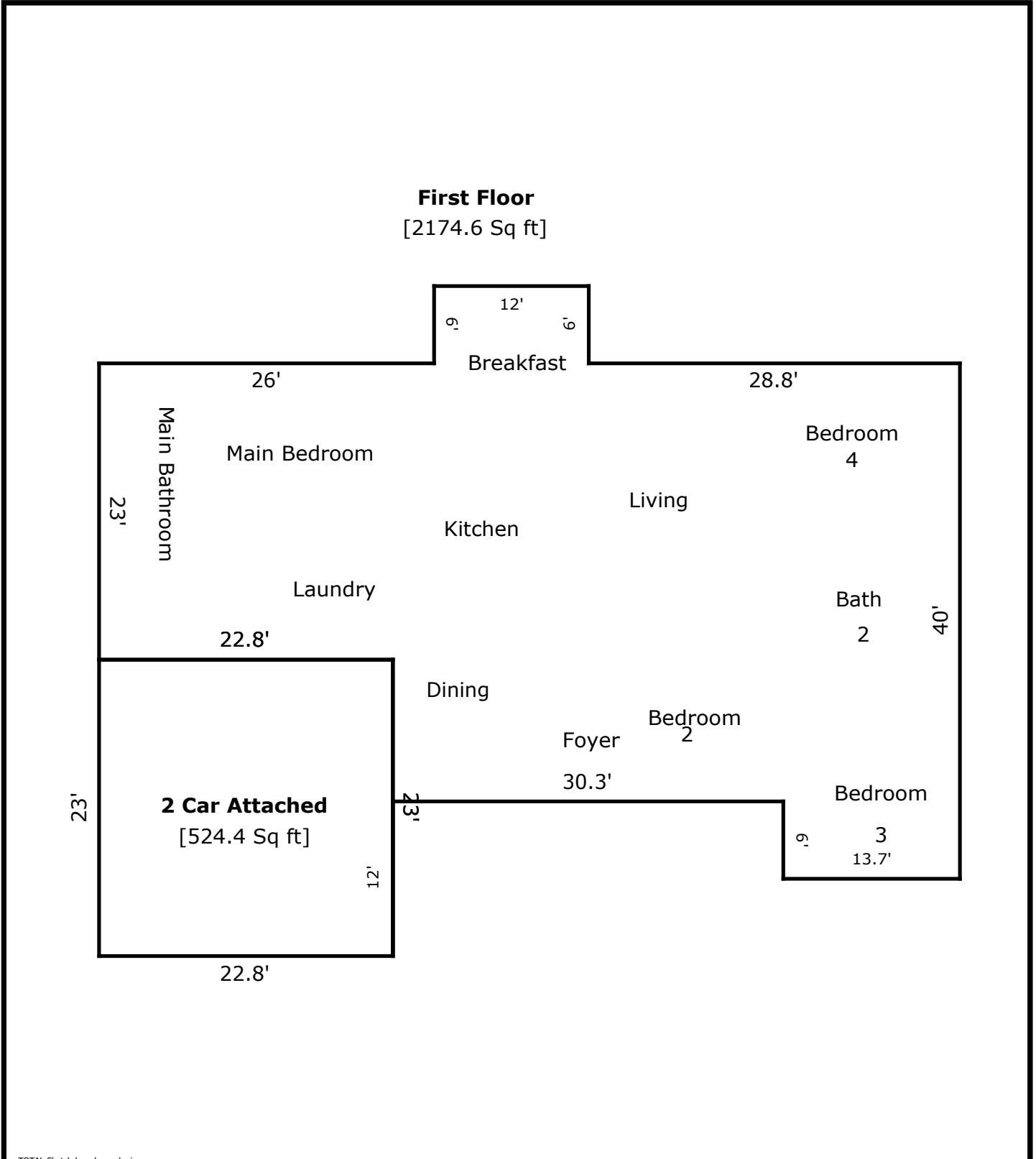

TOTAL Sketch by a la mode, inc.

### Area Calculations Summary

Living Area	Calculation Details	
First Floor	2174.6 Sq ft	12 × 6 = 72 23 × 22.8 = 524.4 34 × 30.3 = 1030.2 13.7 × 40 = 548
<b>Total Living Area (Rounded):</b>	<b>2175 Sq ft</b>	
<b>Non-living Area</b>		
2 Car Attached	524.4 Sq ft	23 × 22.8 = 524.4

## Subject Photo Page

Borrower	The Holli McCray Group						
Property Address	102 Spyglass						
City	Clinton	County	Knox	State	TN	Zip Code	37932
Lender/Client	The Holli McCray Group						



### Subject Front

102 Spyglass  
Sales Price  
Gross Living Area 2,175  
Total Rooms  
Total Bedrooms  
Total Bathrooms  
Location  
View  
Site  
Quality  
Age



### Subject Rear

### Subject Street