

# INVOICE

**FROM:**

Advanced Appraisal Services  
 Advanced Appraisal Services  
 PO Box 11373  
 Knoxville, TN 37939-1373

Telephone Number: (865) 588-4008

Fax Number:

**TO:**

The Holli McCray Group

Knoxville, TN

E-Mail: verdeaux@kw.com

Telephone Number: (865) 851-0181

Fax Number:

Alternate Number:

**INVOICE NUMBER**

0050636

**DATES**

Invoice Date: 11/02/2020

Due Date: 11/02/2020

**REFERENCE**

Internal Order #: 0050636

Lender Case #:

Client File #:

FHA/VA Case #:

Main File # on form: 0050636

Other File # on form: 0050636

Federal Tax ID: 62-1867763

Employer ID:

**DESCRIPTION**

<b>Lender:</b> The Holli McCray Group	<b>Client:</b> The Holli McCray Group
<b>Purchaser/Borrower:</b> The Holli McCray Group	
<b>Property Address:</b> 7801 Pioneer Trl	
<b>City:</b> Knoxville	
<b>County:</b> Knox	<b>State:</b> TN <b>Zip:</b> 37924
<b>Legal Description:</b> Lovell Cove Subdivision	

**FEES**

**AMOUNT**

Measurement	75.00
Interior	0.00
<b>SUBTOTAL</b>	75.00

**PAYMENTS**

**AMOUNT**

<b>Check #:</b>	<b>Date:</b>	<b>Description:</b>	
Check #:	Date:	Description:	
Check #:	Date:	Description:	
<b>SUBTOTAL</b>			0
<b>TOTAL DUE</b>			<b>\$ 75.00</b>

## Building Sketch

Borrower	The Holli McCray Group			
Property Address	7801 Pioneer Trl			
City	Knoxville	County Knox	State TN	Zip Code 37924
Lender/Client	The Holli McCray Group			

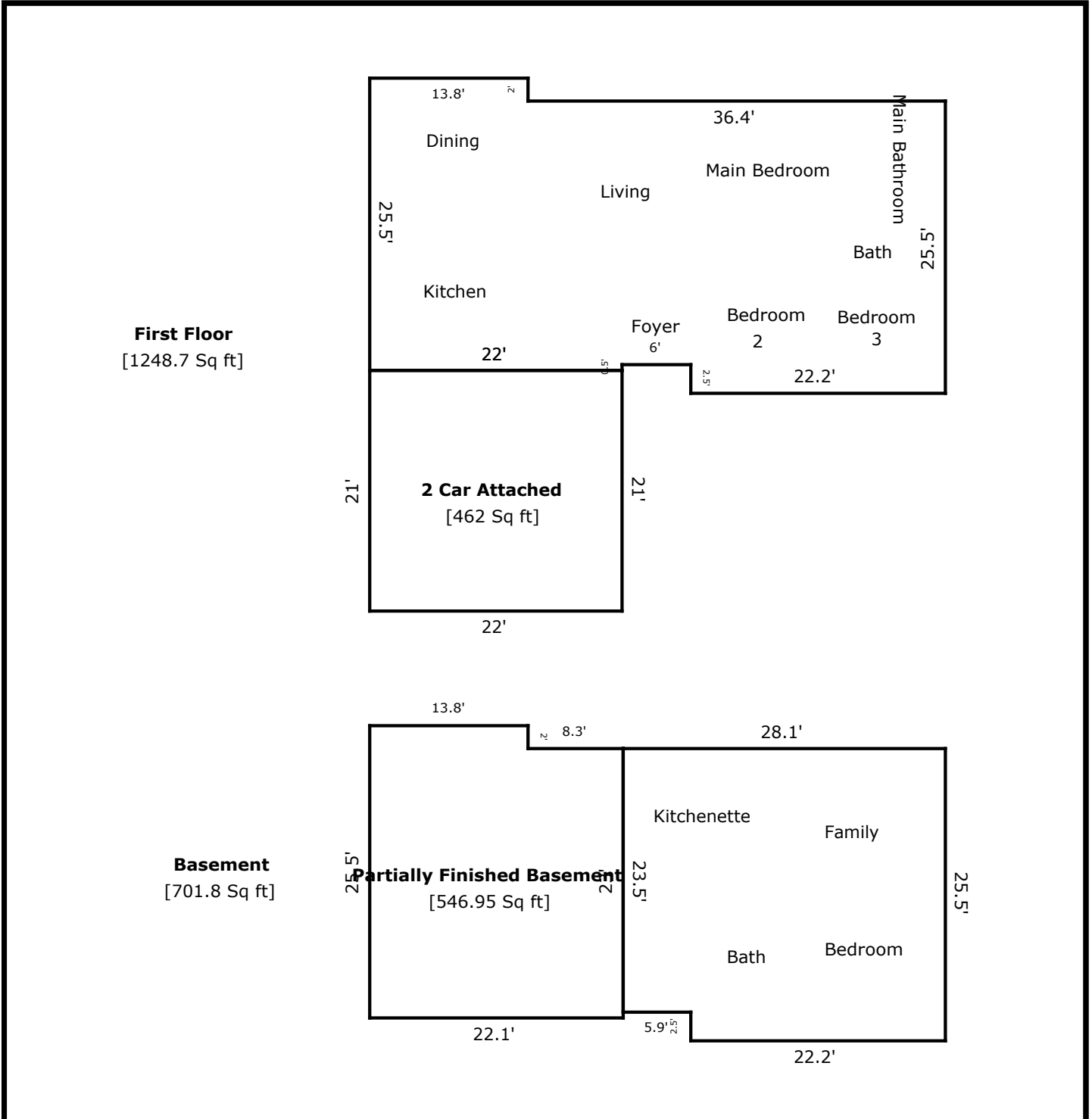

TOTAL Sketch by a la mode, inc.

### Area Calculations Summary

Living Area	Area	Calculation Details
First Floor	1248.7 Sq ft	$25.5 \times 22.2 = 566.1$ $25.5 \times 13.8 = 351.9$ $14.2 \times 23 = 326.6$ $0.5 \times 8.2 = 4.1$
Basement	701.8 Sq ft	$25.5 \times 22.2 = 566.1$ $23 \times 5.9 = 135.7$
<b>Total Living Area (Rounded):</b>	<b>1951 Sq ft</b>	
Non-living Area	Area	Calculation Details
Partially Finished Basement	546.95 Sq ft	$22.1 \times 23.5 = 519.35$ $2 \times 13.8 = 27.6$
2 Car Attached	462 Sq ft	$21 \times 22 = 462$

# Supplemental Addendum

File No. 0050636

Borrower	The Holli McCray Group						
Property Address	7801 Pioneer Trl						
City	Knoxville	County	Knox	State	TN	Zip Code	37924
Lender/Client	The Holli McCray Group						

**7801 Pioneer- 1950 sq ft**

**1st Level- 1248 sq ft**

- Living 17 x 18
- Bed 2 11 x 9
- Bed 3 10 x 10
- Bath 8 x 5
- Main Bed 12 x 11
- Main Bath 8 x 5
- Dining 13 x 11
- Kitchen 13 x 13

**Basement- 702 sq ft**

- Bath 9 x 5
- Bed 4 14 x 11
- Family 15 x 14
- Kitchenette 13 x 11

Signature \_\_\_\_\_  
Name Jeremy Skalet  
Date Signed \_\_\_\_\_  
State Certification # 3215 State TN  
Or State License # \_\_\_\_\_ State \_\_\_\_\_

Signature \_\_\_\_\_  
Name \_\_\_\_\_  
Date Signed \_\_\_\_\_  
State Certification # \_\_\_\_\_ State \_\_\_\_\_  
Or State License # \_\_\_\_\_ State \_\_\_\_\_

## Subject Photo Page

Borrower	The Holli McCray Group						
Property Address	7801 Pioneer Trl						
City	Knoxville	County	Knox	State	TN	Zip Code	37924
Lender/Client	The Holli McCray Group						



### Subject Front

7801 Pioneer Trl  
Sales Price  
Gross Living Area 1,951  
Total Rooms 37  
Total Bedrooms 16  
Total Bathrooms 5.0  
Location  
View  
Site  
Quality  
Age



### Subject Rear

### Subject Street