

INVOICE

FROM:

Advanced Appraisal Services
 Advanced Appraisal Services
 PO Box 11373
 Knoxville, TN 37939-1373

Telephone Number: (865) 588-4008

Fax Number:

TO:

The Holli McCray Group

Knoxville, TN

E-Mail: verdeaux@kw.com

Telephone Number: (865) 851-0181

Fax Number:

Alternate Number:

INVOICE NUMBER

0050570

DATES

Invoice Date: 10/26/2020

Due Date: 10/26/2020

REFERENCE

Internal Order #: 0050570

Lender Case #:

Client File #:

FHA/VA Case #:

Main File # on form: 0050570

Other File # on form: 0050570

Federal Tax ID: 62-1867763

Employer ID:

DESCRIPTION

Lender:	The Holli McCray Group	Client:	The Holli McCray Group		
Purchaser/Borrower:	The Holli McCray Group				
Property Address:	727 E Dumplin Valley				
City:	Jefferson City		State:	TN	Zip: 37932
County:					
Legal Description:					

FEES

AMOUNT

Measurement interior	100.00
	0.00
SUBTOTAL	100.00

PAYMENTS

AMOUNT

Check #:	Date:	Description:	
Check #:	Date:	Description:	
Check #:	Date:	Description:	
SUBTOTAL			0

TOTAL DUE \$ 100.00

Supplemental Addendum

File No. 0050570

Borrower	The Holli McCray Group		
Property Address	727 E Dumplin Valley		
City	Jefferson City	County	State TN Zip Code 37932
Lender/Client	The Holli McCray Group		

727 E Dumplin Valley

1st Level- 2726 sq ft

Living 29 x 20
Dining 16 x 15
Kitchen/Breakfast 23 x 16
Bath 2 10 x 8
Laundry 12 x 6
Office 11 x 8
Main Bed 16 x 16
Main Bath 16 x 12

2nd Level- 1631 sq ft

Bath 3 10 x 7
Bed 2 15 x 11
Bed 3 17 x 13
Bonus 15 x 11
Bath 4 10 x 9
Playroom 15 x 10
Office 15 x 10

Barn- 5800 sq ft

Signature _____
Name Jeremy Skalet
Date Signed _____
State Certification # 3215 State TN
Or State License # _____ State _____

Signature _____
Name _____
Date Signed _____
State Certification # _____ State _____
Or State License # _____ State _____

Subject Photo Page

Borrower	The Holli McCray Group				
Property Address	727 E Dumplin Valley				
City	Jefferson City	County	State	TN	Zip Code 37932
Lender/Client	The Holli McCray Group				



Subject Front

727 E Dumplin Valley

4,356



Subject Rear



Subject Barn

Building Sketch

Borrower	The Holli McCray Group		
Property Address	727 E Dumplin Valley		
City	Jefferson City	County	State TN Zip Code 37932
Lender/Client	The Holli McCray Group		

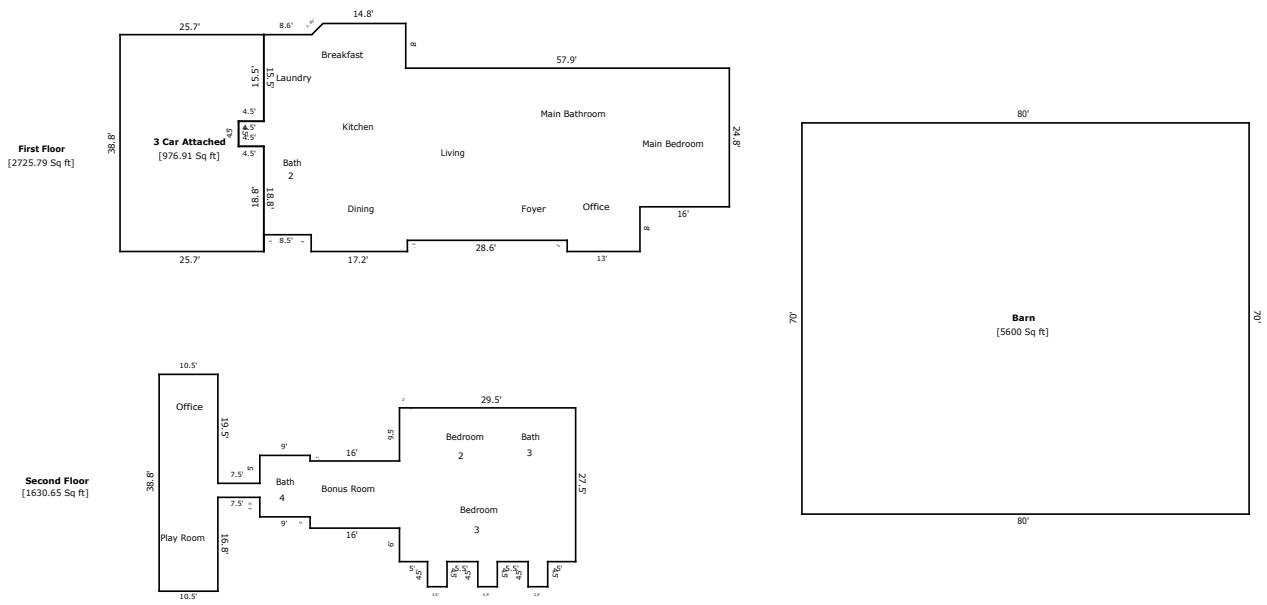

TOTAL Sketch by a la mode, inc.

Area Calculations Summary

Living Area	Area	Calculation Details
First Floor	2725.79 Sq ft	$4.5 \times 4.5 = 20.25$ $24.8 \times 16 = 396.8$ $32.8 \times 13 = 426.4$ $30.8 \times 28.6 = 880.88$ $35.8 \times 8.5 = 304.3$ $17.2 \times 32.8 = 564.16$ $8 \times 14.8 = 118.4$ $2.1 \times 6 = 12.6$ $0.5 \times 2 \times 2 = 2$
Second Floor	1630.65 Sq ft	$3.5 \times 4.5 = 15.75$ $3.5 \times 4.5 = 15.75$ $3.5 \times 4.5 = 15.75$ $38.8 \times 10.5 = 407.4$ $27.5 \times 31.5 = 866.25$ $2.5 \times 7.5 = 18.75$ $12 \times 16 = 192$ $11 \times 9 = 99$
Total Living Area (Rounded):	4356 Sq ft	
Non-living Area		
3 Car Attached	976.91 Sq ft	$38.8 \times 21.2 = 822.56$ $4.5 \times 15.5 = 69.75$ $4.5 \times 18.8 = 84.6$