

Supplemental Addendum

File No. 0048496

Borrower					
Property Address 8120 Ainsworth Dr					
City	Knoxville	County	Knox	State	TN
Zip Code		37909			
Lender/Client Rachael Wedekind					

8120 Ainsworth Dr

Main Level 2117 sq ft

Basement Finished 1359 sq ft

Basement Garage 776 sq ft

1st Level

Kitchen 17 x 10.5
Dining 14 x 11
Living Room 16 x 14
Den 17.5 x 17
Bedroom 13 x 12.5
Bedroom 14 x 12
Bath 9.5 x 5
Bath 8.5 x 6.5
Bedroom 15.5 x 14.5

Basement

Bedroom 14 x 13.5
Bedroom 15.5 x 10
Family Room 18 x 17
Bath 9 x 5
Laundry 8 x 6
Bar 18.5 x 8.5

Signature 
 Name Charles Skalet
 Date Signed 07/14/2020
 State Certification # CR-2399 State TN
 Or State License # _____ State _____

Signature _____
 Name _____
 Date Signed _____
 State Certification # _____ State _____
 Or State License # _____ State _____

Subject Photo Page

Borrower							
Property Address	8120 Ainsworth Dr						
City	Knoxville	County	Knox	State	TN	Zip Code	37909
Lender/Client	Rachael Wedekind						



Subject Front

Subject Rear

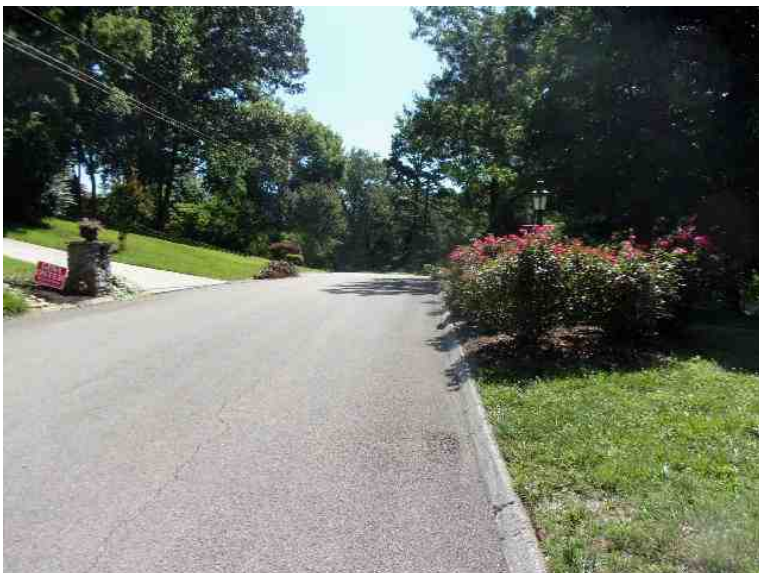

Subject Street

Building Sketch

Borrower				
Property Address	8120 Ainsworth Dr			
City	Knoxville	County	Knox	State TN Zip Code 37909
Lender/Client	Rachael Wedekind			

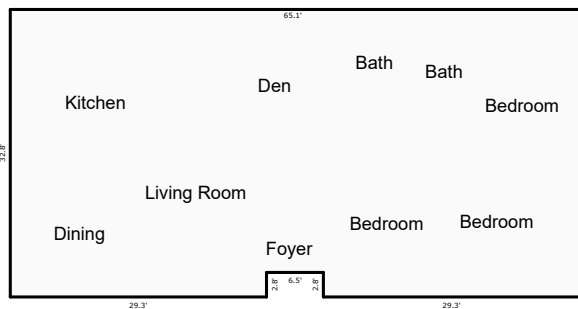

1st Floor

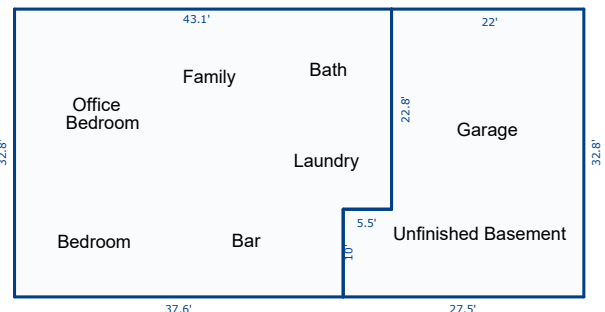

Basement

Sketch by Apex Sketch v6 Standard™

Comments:

AREA CALCULATIONS SUMMARY			
Code	Description	Net Size	Net Totals
GLA1	First Floor	2117.08	2117.08
BSMT	Unfinished	776.60	
	Finished	1358.68	2135.28
Net LIVABLE Area		(rounded)	2117

LIVING AREA BREAKDOWN			
Breakdown			Subtotals
First Floor			
29.3	x	2.8	82.04
65.1	x	30.0	1953.00
2.8	x	29.3	82.04
3 Items			(rounded) 2117