

Supplemental Addendum

File No. 0048495

Borrower					
Property Address	5133 Beaver Dam Ln				
City	Knoxville	County	Knox	State	TN
Zip Code	37931				
Lender/Client	Rachael Wedekind				

5133 Beaver Dam Ln

Main Level **994 sq ft**
2nd Level **1174 sq ft**
Total **2168 sq ft**

1st Level

Living **19.5 x 17**
Dining **15.5 x 11**
Kitchen **16 x 15.5**
1/2 Bath **7 x 3**
Laundry **6.5 x 5**

2nd Level

Bed **15.5 x 10.5**
Bed **15.5 x 11.5**
Bath **15.5 x 9.5**
Bed **13 x 12**
Bath **8.5 x 5**
Bonus **21 x 12**



Signature _____
 Name Charles C Skalet
 Date Signed 07/14/2020
 State Certification # CR-2399 State TN
 Or State License # _____ State _____

Signature _____
 Name _____
 Date Signed _____
 State Certification # _____ State _____
 Or State License # _____ State _____

Subject Photo Page

Borrower				
Property Address	5133 Beaver Dam Ln			
City	Knoxville	County	Knox	State TN Zip Code 37931
Lender/Client	Rachael Wedekind			



Subject Front

Subject Rear



Subject Street

Building Sketch

Borrower				
Property Address	5133 Beaver Dam Ln			
City	Knoxville	County	Knox	State TN Zip Code 37931
Lender/Client	Rachael Wedekind			

1st Level

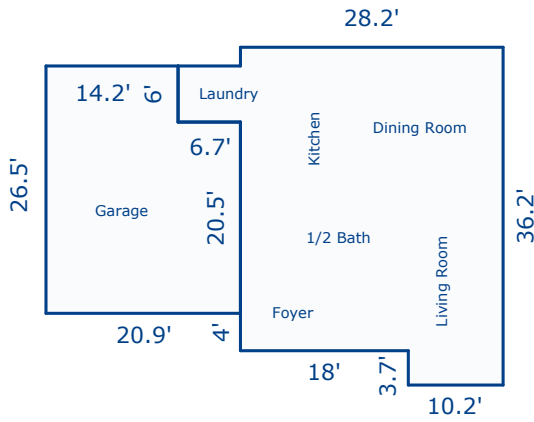

2nd Level

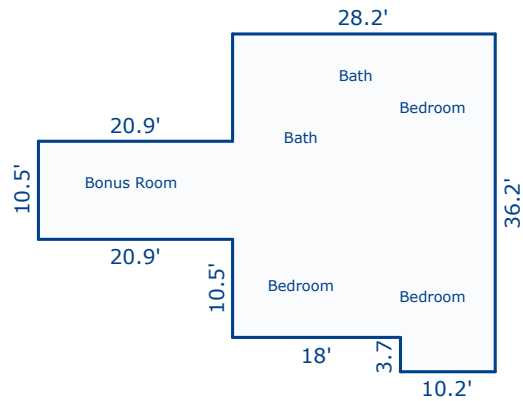

Sketch by Apex Sketch v6 Standard™

Comments:

AREA CALCULATIONS SUMMARY			
Code	Description	Net Size	Net Totals
GLA1	First Floor	994.44	994.44
GLA2	Second Floor	1173.69	1173.69
GAR	Garage	513.65	513.65
Net LIVABLE Area		(rounded)	2168

LIVING AREA BREAKDOWN			
Breakdown			Subtotals
First Floor			
34.9	x	6.0	209.40
24.5	x	28.2	690.90
2.0	x	28.2	56.40
3.7	x	10.2	37.74
Second Floor			
28.2	x	11.5	324.30
3.7	x	10.2	37.74
10.5	x	28.2	296.10
10.5	x	49.1	515.55
8 Items	(rounded)		2168