

Subject Photo Page

Borrower	N/A				
Property Address	3228 Gose Cove Ln				
City	Knoxville	County	Knox	State	TN Zip Code 37931
Lender/Client	Diana Traylor				



Subject Front



Subject Street

Supplemental Addendum

File No. 0048562

Borrower	N/A		
Property Address	3228 Gose Cove Ln		
City	Knoxville	County	Knox
		State	TN
		Zip Code	37931
Lender/Client	Diana Traylor		

Measurements for 3228 Gose Cove Ln

1st Floor	1085 square feet
<u>2nd Floor</u>	<u>1321 square feet</u>
Total	2406 square feet

The above measurements are completed according to appraisal industry standards.

Interior Rooms**1st Level**

Dining	13 x 12
1/2 Bath	8.5 x 5
Living Room	21 x 15
Eat in Kitchen	16 x 16 x irr
Laundry	6.5 x 6

2nd Level

Bonus Room	21 x 16.5
Bedroom	11 x 10
Bedroom	13 x 12
Bath	10 x 5
Bedroom	15 x 15.5
Bath	13.5 x 12.5 x irr

Building Sketch

Borrower	N/A				
Property Address	3228 Gose Cove Ln				
City	Knoxville	County	Knox	State	TN
Lender/Client	Diana Traylor				
				Zip Code	37931

1st Level

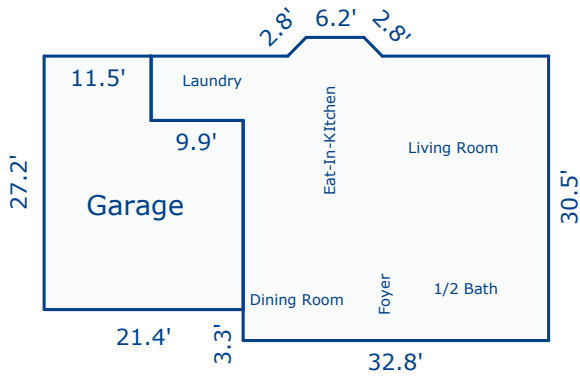

2nd Level

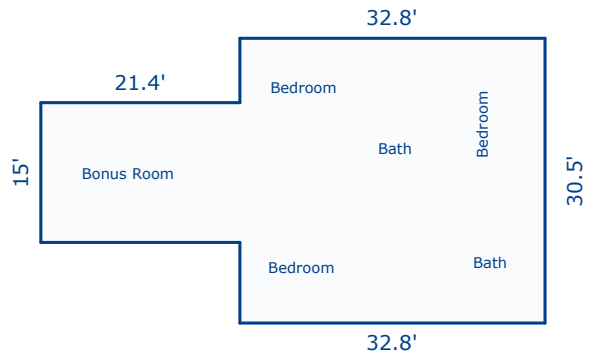

Sketch by Apex Sketch v5 Standard™

Comments:

AREA CALCULATIONS SUMMARY			
Code	Description	Net Size	Net Totals
GLA1	First Floor	1084.91	1084.91
GLA2	Second Floor	1321.40	1321.40
GAR	Garage	513.77	513.77
Net LIVABLE Area		(rounded)	2406

LIVING AREA BREAKDOWN			
	Breakdown		Subtotals
First Floor			
	42.7	x 6.9	294.63
	23.6	x 32.8	774.08
0.5 x	2.0	x 2.0	1.96
	6.2	x 2.0	12.28
0.5 x	2.0	x 2.0	1.96
Second Floor			
	32.8	x 8.6	282.08
	6.9	x 32.8	226.32
	15.0	x 54.2	813.00
8 Items	(rounded)		2406