

Subject Photo Page

Borrower/Client	Holly Patterson				
Property Address	7437 Lawford Rd				
City	Knoxville	County	Knox	State	TN
Lender	N/A				
				Zip Code	37919



Subject Front



Subject Rear



Subject Street

Supplemental Addendum

File No. 0048442

Borrower/Client	Holly Patterson				
Property Address	7437 Lawford Rd				
City	Knoxville	County	Knox	State	TN Zip Code 37919
Lender	N/A				

Measurements of 1921 Indian Springs Ln

First Floor **1753 sf**
2nd Floor **2137 sf**

Unfinished Attic **736 square feet**

The above measurements are completed according to appraisal industry standards.

Interior Room Measurements

1st Level
Living Room **16 x 14**
Family Room **21 x 16**
Sunroom **13.5 x 11.5**
Dining Room **15.5 x 15**
1/2 Bath **5 x 5**
Kitchen **16.5 x 14**
Laundry **13 x 6**

2nd Level
Bedroom **15.5 x 14**
Bath **12 x 6**
Bedroom **15.5 x 14.5**
Bedroom **16 x 15 x irr**
Bath **25 x 9**
Bedroom **21 x 16**
Bath **25 x 15 x irr**

The above measurements for interior rooms are rounded to the nearest 1/2 foot.

Signature 
Name Charles Skalet
Date Signed 07/06/2020
State Certification # CR-2399 State TN
Or State License # _____ State _____

Signature _____
Name _____
Date Signed _____
State Certification # _____ State _____
Or State License # _____ State _____

Building Sketch

Borrower/Client	Holly Patterson			
Property Address	7437 Lawford Rd			
City	Knoxville	County	Knox	State TN Zip Code 37919
Lender	N/A			

1st Level

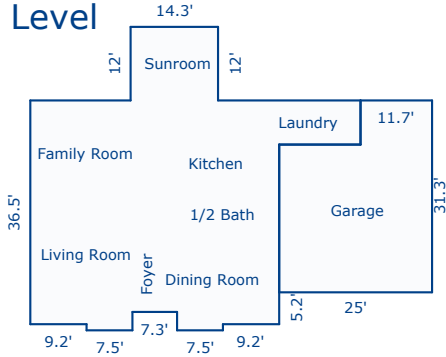

2nd Level

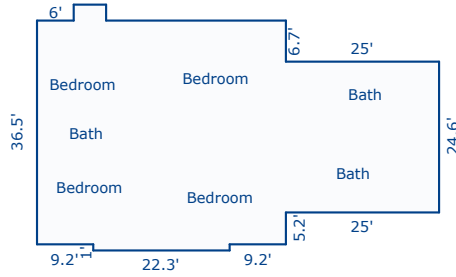

Sketch by Apex Sketch v6 Standard™

Comments:

AREA CALCULATIONS SUMMARY			
Code	Description	Net Size	Net Totals
GLA1	First Floor	1753.31	1753.31
GLA2	Second Floor	2136.63	2136.63
GAR	Garage	686.74	686.74
OTH	Unfinished Attic	736.32	736.32
Net LIVABLE Area		(rounded)	3890

LIVING AREA BREAKDOWN		
	Breakdown	Subtotals
First Floor		
	54.0 x 7.2	388.80
	27.3 x 40.7	1111.11
	12.0 x 14.3	171.60
	1.0 x 7.5	7.50
	2.0 x 16.7	33.40
	2.0 x 16.7	33.40
	1.0 x 7.5	7.50
Second Floor		
	40.7 x 6.7	272.69
	2.6 x 5.3	13.78
	1.0 x 22.3	22.30
	5.2 x 40.7	211.64
	24.6 x 65.7	1616.22
12 Items	(rounded)	3890