

INVOICE

FROM:

Advanced Appraisal Services
 Advanced Appraisal Services
 PO Box 11373
 Knoxville, TN 37939-1373

Telephone Number: (865) 588-4008 Fax Number: (865) 637-2394

TO:

The Holli McCray Group

Knoxville, TN

E-Mail: verdeaux@kw.com

Telephone Number: (865) 851-0181

Fax Number:

Alternate Number:

INVOICE NUMBER

0047890

DATES

Invoice Date: 05/13/2020

Due Date: 04/09/2020

REFERENCE

Internal Order #: 0047890

Lender Case #:

Client File #:

FHA/VA Case #:

Main File # on form: 0047890

Other File # on form: 0047890

Federal Tax ID: 62-1867763

Employer ID:

DESCRIPTION

Lender: The Holli McCray Group **Client:** The Holli McCray Group
Purchaser/Borrower: The Holli McCray Group
Property Address: 2112 Elm Grove Ln
City: Knoxville
County: Knox **State:** TN **Zip:** 37932
Legal Description:

FEES

AMOUNT

Measurement	75.00
interior	0.00

SUBTOTAL 75.00

PAYMENTS

AMOUNT

Check #:	Date:	Description:	
Check #:	Date:	Description:	
Check #:	Date:	Description:	

SUBTOTAL 0

TOTAL DUE \$ 75.00

Supplemental Addendum

File No. 0047890

Borrower	The Holli McCray Group						
Property Address	2112 Elm Grove Ln						
City	Knoxville	County	Knox	State	TN	Zip Code	37932
Lender/Client	The Holli McCray Group						

2112 Elm Grove Ln- 2418 sq ft

1st Level- 1090 sq ft

Dining 13 x 11
Office 12 x 12
Living 13 x 12
Kitchen 17 x 15
Half Bath 7 x 3

2nd Level- 1328 sq ft

Bed/Bonus 15 x 13
Laundry 7 x 6
Bath 9 x 6
Bed 2 13 x 11
Bed 3 11 x 11
Master Bed 17 x 13
Master Bath 10 x 8

Signature _____
Name Jeremy Skalet
Date Signed _____
State Certification # 3215 State TN
Or State License # _____ State _____

Signature _____
Name _____
Date Signed _____
State Certification # _____ State _____
Or State License # _____ State _____

Subject Photo Page

Borrower	The Holli McCray Group						
Property Address	2112 Elm Grove Ln						
City	Knoxville	County	Knox	State	TN	Zip Code	37932
Lender/Client	The Holli McCray Group						



Subject Front

2112 Elm Grove Ln



Subject Rear

Subject Street

Building Sketch

Borrower	The Holli McCray Group			
Property Address	2112 Elm Grove Ln			
City	Knoxville	County	Knox	State TN Zip Code 37932
Lender/Client	The Holli McCray Group			

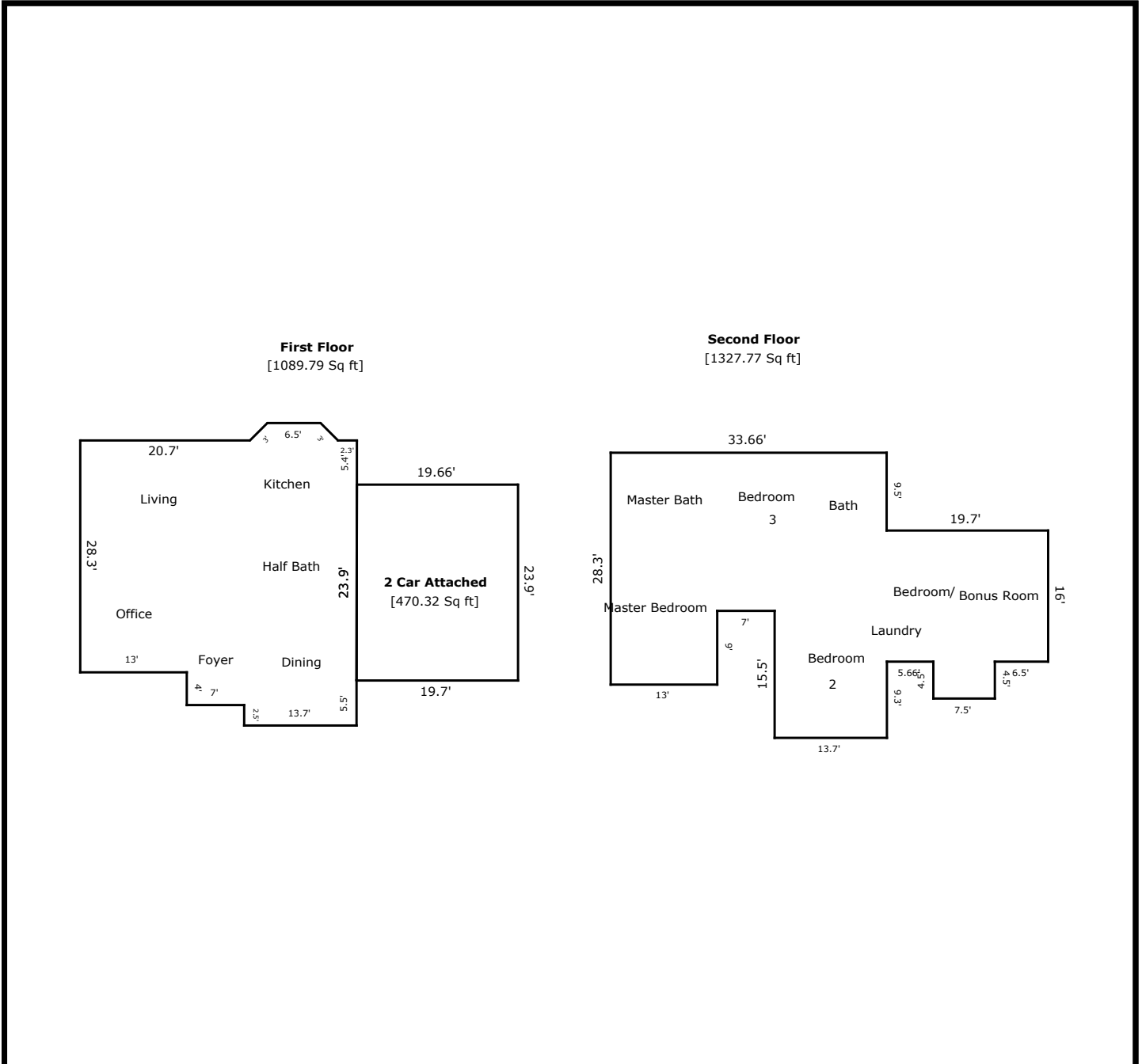

TOTAL Sketch by a la mode, inc.

Area Calculations Summary

Living Area	Area	Calculation Details
First Floor	1089.79 Sq ft	$0.5 \times 2.12 \times 2.12 = 2.25$ $0.5 \times 2.12 \times 2.12 = 2.25$ $6.5 \times 2.12 = 13.79$ $28.3 \times 13 = 367.9$ $20.74 \times 5.4 = 112.01$ $26.9 \times 7 = 188.3$ $29.4 \times 13.7 = 402.78$ $0.5 \times 23.9 \times 0.04 = 0.51$
Second Floor	1327.77 Sq ft	$7.5 \times 4.5 = 33.75$ $16 \times 19.66 = 314.61$ $13.7 \times 15.5 = 212.35$ $13 \times 9 = 117$ $19.3 \times 33.66 = 649.7$ $9.8 \times 0.04 = 0.36$
Total Living Area (Rounded):	2418 Sq ft	
Non-living Area		
2 Car Attached	470.32 Sq ft	$19.66 \times 23.9 = 469.81$ $0.5 \times 0.04 \times 23.9 = 0.51$