

## Subject Photo Page

Borrower	N/A				
Property Address	665 Country Club Rd				
City	Townsend	County	Sevier	State	TN Zip Code 37882
Lender/Client	Sarah Kerr				



**Subject**



**Subject**

## Supplemental Addendum

File No. 0047617

Borrower	N/A				
Property Address	665 Country Club Rd				
City	Townsend	County	Sevier	State	TN      Zip Code 37882
Lender/Client	Sarah Kerr				

### **Measurements for 665 Country Club**

**These measurements ascend from the basement to the top floor**

<b>Basement/Garage (Unfinished)</b>	<b>1044 square feet</b>
<b>Level 1 over Basement/Garage</b>	<b>1215 square feet</b>
<b>Level 2</b>	<b>2249 square feet</b>
<b>Level 3</b>	<b>1101 square feet</b>
<b>Total Livable</b>	<b>4565 square feet</b>

The above measurements are completed according to appraisal industry standards utilizing ANSI measurement standards.

## Building Sketch

Borrower	N/A			
Property Address	665 Country Club Rd			
City	Townsend	County	Sevier	State TN      Zip Code 37882
Lender/Client	Sarah Kerr			

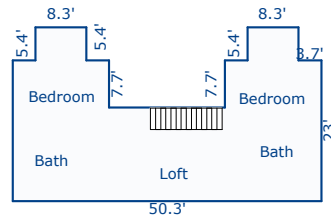
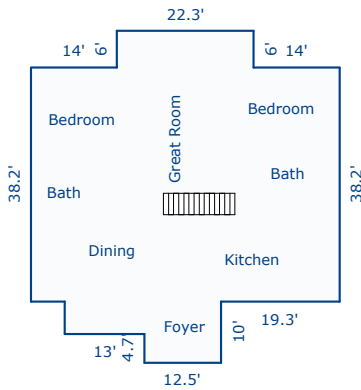
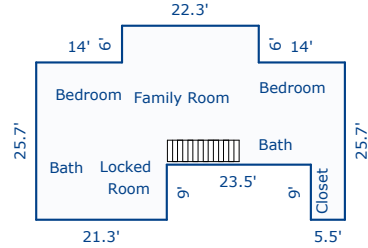
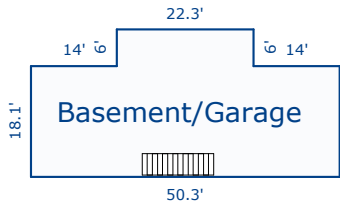

Sketch by Apex Sketch v5 Standard™

Comments:

AREA CALCULATIONS SUMMARY			
Code	Description	Net Size	Net Totals
GLA1	Floor 1	1215.01	1215.01
GLA2	Floor 2	2249.16	2249.16
GLA3	3rd Floor	1101.01	1101.01
BSMT	Basement/Garage	1044.23	1044.23
<b>Net LIVABLE Area</b>		(rounded)	4565

LIVING AREA BREAKDOWN		
	Breakdown	Subtotals
<b>Floor 1</b>	9.0 x 21.3	191.70
	6.0 x 22.3	133.80
	9.0 x 5.5	49.50
	16.7 x 50.3	840.01
<b>Floor 2</b>	25.5 x 5.3	135.15
	6.0 x 22.3	133.80
	38.2 x 50.3	1921.46
	4.7 x 12.5	58.75
<b>3rd Floor</b>	50.3 x 15.3	769.59
	5.4 x 8.3	44.82
	7.7 x 15.7	120.89
	7.7 x 15.7	120.89
	5.4 x 8.3	44.82
<b>13 Items</b>	(rounded)	4565