

Subject Photo Page

Borrower	The Holli McCray Group						
Property Address	125 Mountain Meadow						
City	Clinton	County	Knox	State	TN	Zip Code	37932
Lender/Client	The Holli McCray Group						



Subject Front

125 Mountain Meadow
Sales Price
Gross Living Area
Total Rooms
Total Bedrooms
Total Bathrooms
Location
View
Site
Quality
Age



Subject Rear

Subject Street

Supplemental Addendum

File No. 0047735

Borrower	The Holli McCray Group						
Property Address	125 Mountain Meadow						
City	Clinton	County	Knox	State	TN	Zip Code	37932
Lender/Client	The Holli McCray Group						

125 Mountain Meadow- 2309 sq ft

1st Level- 1227 sq ft

- Laundry 8 x 8**
- Kitchen 13 x 12**
- Living/Breakfast 22 x 13**
- Bed 2 11 x 11**
- Bath 2 9 x 5**
- Dining 14 x 12**

2nd Level- 1082 sq ft

- Bed 3 13 x 12**
- Master Bed 17 x 14**
- Master Bath 13 x 13**
- Bath 3 9 x 7**
- Bed 4 13 x 12**

Signature _____
Name Jeremy Skalet
Date Signed _____
State Certification # 3215 State TN
Or State License # _____ State _____

Signature _____
Name _____
Date Signed _____
State Certification # _____ State _____
Or State License # _____ State _____

Building Sketch

Borrower	The Holli McCray Group			
Property Address	125 Mountain Meadow			
City	Clinton	County	Knox	State TN Zip Code 37932
Lender/Client	The Holli McCray Group			

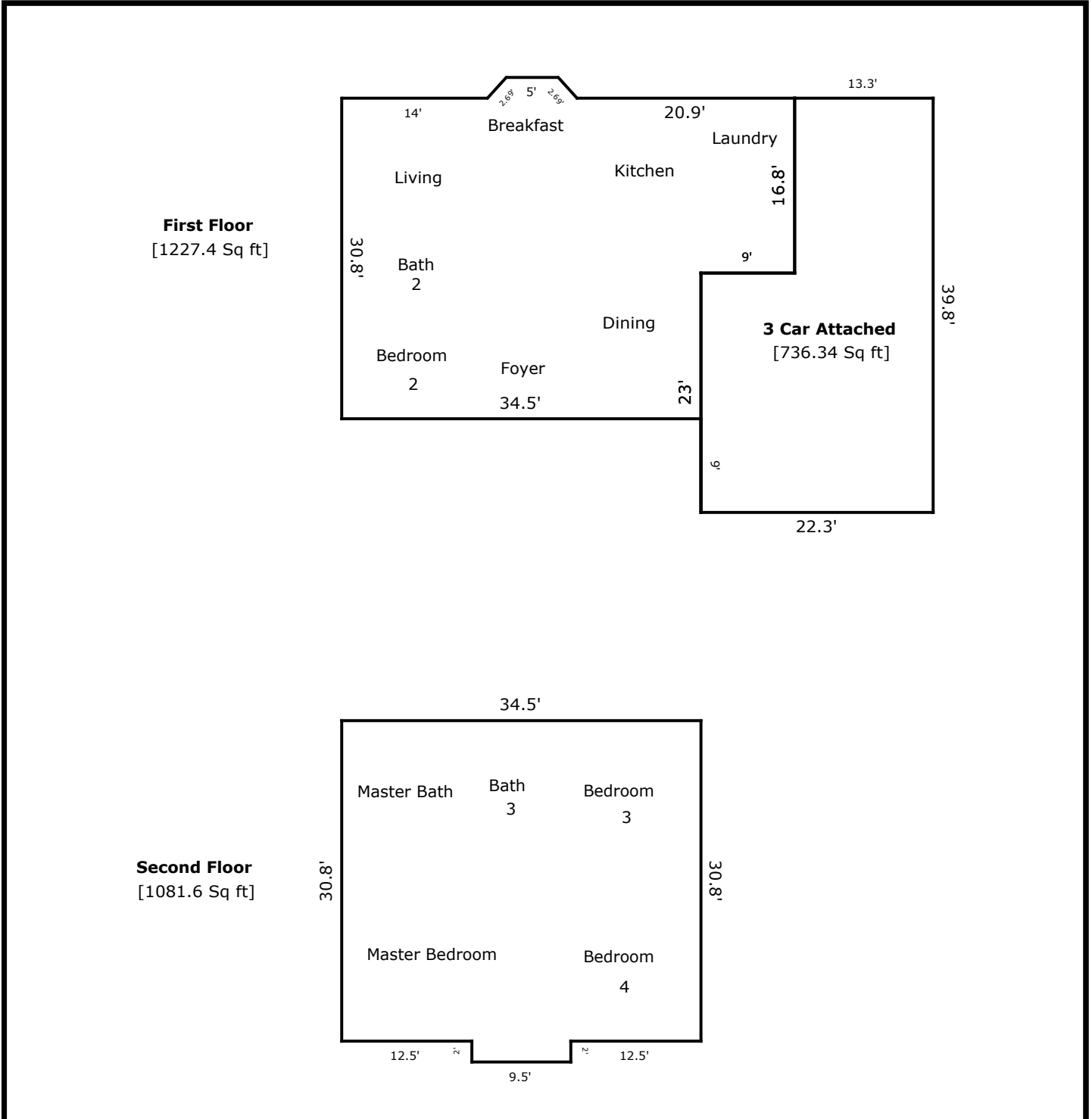

TOTAL Sketch by a la mode, inc.

Area Calculations Summary

Living Area	Area	Calculation Details
First Floor	1227.4 Sq ft	$0.5 \times 1.8 \times 2 = 1.8$ $0.5 \times 2 \times 1.8 = 1.8$ $5 \times 2 = 10$ $30.8 \times 34.5 = 1062.6$ $9 \times 16.8 = 151.2$
Second Floor	1081.6 Sq ft	$9.5 \times 2 = 19$ $34.5 \times 30.8 = 1062.6$
Total Living Area (Rounded):	2309 Sq ft	
Non-living Area		
3 Car Attached	736.34 Sq ft	$22.3 \times 23 = 512.9$ $13.3 \times 16.8 = 223.44$