

Subject Photo Page

Borrower/Client	N/A				
Property Address	405 westbridge				
City	Maryville	County	Blount	State	TN Zip Code 37804
Lender	Scott Groth				



Subject Front



Subject Street

Supplemental Addendum

File No. 0046944

Borrower/Client	N/A				
Property Address	405 westbridge				
City	Maryville	County	Blount	State	TN Zip Code 37804
Lender	Scott Groth				

Measurements for 405 Westbridge Dr

Sq Ft-Main	1252 square feet
Sq Ft-2nd Level	1960 square feet
Sp Ft-3rd Level	331 square feet

The above measurements are completed according to appraisal industry standards.

Interior Room Measurements**1st Floor**

Family Room	17.5 x 16
Eat-In Kitchen	25.5 x 12
Study	11 x 11
Dining	16 x 11
1/2 Bath	6 x 5

2nd Floor

Master Bedroom	20 x 14
Master Bath	18 x 7 x irregular
Bedroom	13 x 11 x irregular
Bath	11.5 x 7.5
Bedroom	14 x 12.5
Bedroom	14 x 11
Bath	10 x 6
Laundry	9.5 x 5
Bunk Room	21.5 x 14

3rd Floor

Bonus	17.5 x 15.5 x irregular
--------------	--------------------------------

The room measurements are interior wall to interior wall and rounded to the nearest 0.5 foot.

Building Sketch

Borrower/Client	N/A			
Property Address	405 westbridge			
City	Maryville	County	Blount	State TN Zip Code 37804
Lender	Scott Groth			

1st Level

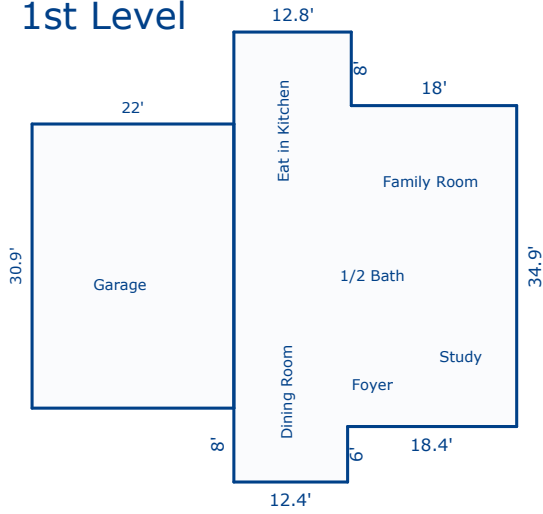

2nd Level

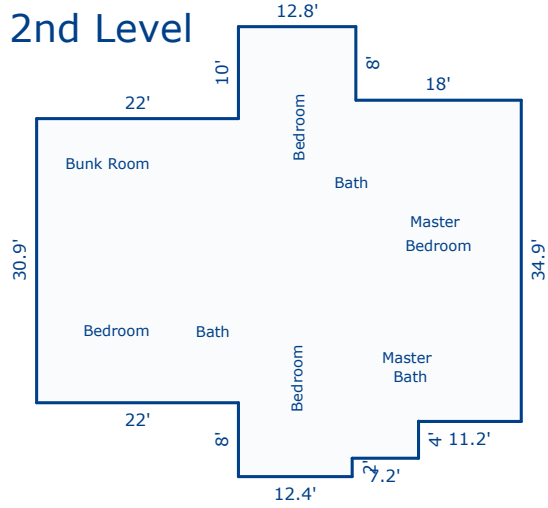

3rd Level

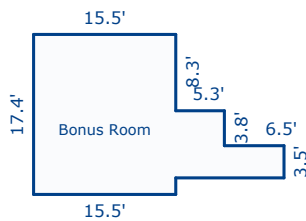

Sketch by Apex Sketch v6 Standard™

Comments:

AREA CALCULATIONS SUMMARY			
Code	Description	Net Size	Net Totals
GLA1	First Floor	1251.72	1251.72
GLA2	Second Floor	1960.32	1960.32
GLA3	Third Floor	331.14	331.14
GAR	Garage	679.80	679.80
Net LIVABLE Area		(rounded)	3543

LIVING AREA BREAKDOWN		
Breakdown		Subtotals
First Floor		
8.0 x	12.8	102.40
6.0 x	12.4	74.40
34.9 x	30.8	1074.92
Second Floor		
30.8 x	2.0	61.60
4.0 x	19.6	78.40
52.8 x	30.9	1631.52
2.0 x	12.4	24.80
2.0 x	30.8	61.60
8.0 x	12.8	102.40
Third Floor		
15.5 x	1.8	27.90
8.3 x	15.5	128.65
3.8 x	20.8	79.04
3.5 x	27.3	95.55
13 Items	(rounded)	3543