

Subject Photo Page

Borrower	Mandy Belk						
Property Address	1250 Vale View Rd						
City	Knoxville	County	Knox	State	TN	Zip Code	37922
Lender/Client	Mandy Belk						



Subject Front



Subject Street

Supplemental Addendum

File No. 0046981

Borrower	Mandy Belk				
Property Address	1250 Vale View Rd				
City	Knoxville	County	Knox	State	TN Zip Code 37922
Lender/Client	Mandy Belk				

Measurements for 1250 Vale View Rd

Sq Ft- Main **1625 square feet**
Sq Ft- 2nd **1527 square feet**

The above measurements are completed according to appraisal industry standards.

Interior Room Measurements**1st Floor**

Office **13 x 13.5**
Bathroom **7 x 5**
Bedroom **13 x 13.5**
Dining **13 x 12**
Living **22 x 19.5**
Eat in Kitchen **20 x 12**
Laundry **9 x 5.5**

2nd Floor

Master Bedroom **17.5 x 13**
Master Bathroom **15 x 9.5**
Bathroom **12.5 x 5**
Bedroom **13 x 12**
Bedroom **10 x 12**
Bonus **14 x 16**
Secret Playroom **20 x 5.5**

The room measurements are interior wall to interior wall and rounded to the nearest 0.5 foot.

Building Sketch

Borrower	Mandy Belk			
Property Address	1250 Vale View Rd			
City	Knoxville	County	Knox	State TN Zip Code 37922
Lender/Client	Mandy Belk			

1st Level



2nd Level

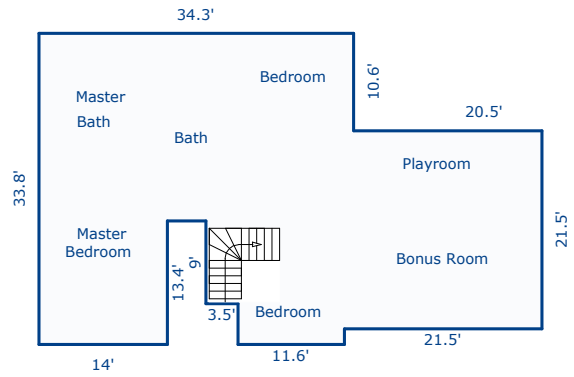

Sketch by Apex Sketch v6 Standard™

Comments:

AREA CALCULATIONS SUMMARY			
Code	Description	Net Size	Net Totals
GLA1	First Floor	1624.57	1624.57
GLA2	Second Floor	1526.71	1526.71
GAR	Garage	490.00	490.00
Net LIVABLE Area		(rounded)	3151

LIVING AREA BREAKDOWN		
Breakdown		Subtotals
First Floor		
33.3	x 14.7	489.51
6.1	x 20.8	126.88
15.6	x 54.8	854.88
3.5	x 43.8	153.30
Second Floor		
10.6	x 34.3	363.58
13.4	x 14.0	187.60
9.0	x 36.6	329.40
9.8	x 54.8	537.04
2.7	x 33.1	89.37
1.7	x 11.6	19.72
10 Items	(rounded)	3151