

INVOICE

FROM:

Advanced Appraisal Services
 Advanced Appraisal Services
 PO Box 11373
 Knoxville, TN 37939-1373

Telephone Number: (865) 588-4008 Fax Number: (865) 637-2394

TO:

The Holli McCray Group

Knoxville, TN

E-Mail: verdeaux@kw.com

Telephone Number: (865) 851-0181 Fax Number:

Alternate Number:

INVOICE NUMBER

0045986

DATES

Invoice Date: 10/16/2019

Due Date: 10/16/2019

REFERENCE

Internal Order #: 0045986

Lender Case #:

Client File #:

FHA/VA Case #:

Main File # on form: 0045986

Other File # on form:

Federal Tax ID: 62-1867763

Employer ID:

DESCRIPTION

Lender: The Holli McCray Group	Client: The Holli McCray Group
Purchaser/Borrower: The Holli McCray Group	
Property Address: 625 Dunnview Ln	
City: Knoxville	
County: Knox	State: TN Zip: 37934
Legal Description: Lot 28 Westbury S/D	

FEES

AMOUNT

Measure	75.00
Interior	0.00

SUBTOTAL 75.00

PAYMENTS

AMOUNT

Check #:	Date:	Description:	
Check #:	Date:	Description:	
Check #:	Date:	Description:	

SUBTOTAL 0

TOTAL DUE \$ 75.00

Subject Photo Page

Borrower	The Holli McCray Group						
Property Address	625 Dunnview Ln						
City	Knoxville	County	Knox	State	TN	Zip Code	37934
Lender/Client	The Holli McCray Group						



Subject Front

625 Dunnview Ln
Sales Price
Gross Living Area
Total Rooms
Total Bedrooms
Total Bathrooms
Location
View
Site
Quality
Age



Subject Rear

Subject Street

Supplemental Addendum

File No. 0045986

Borrower	The Holli McCray Group				
Property Address	625 Dunnview Ln				
City	Knoxville	County	Knox	State	TN
Lender/Client	The Holli McCray Group				
				Zip Code	37934

625 Dunnview- 1562 sq ft

- Living 23 x 19**
- Kitchen 11 x 11**
- Laundry 7 x 6**
- Bed 2 12 x 12**
- Bed 3 11 x 10**
- Bath 9 x 5**
- Master Bed 14 x 13**
- Master Bath 12 x 11**

Signature _____
Name Jeremy Skalet
Date Signed _____
State Certification # 3215 State TN
Or State License # _____ State _____

Signature _____
Name _____
Date Signed _____
State Certification # _____ State _____
Or State License # _____ State _____

Building Sketch

Borrower	The Holli McCray Group			
Property Address	625 Dunnview Ln			
City	Knoxville	County	Knox	State TN Zip Code 37934
Lender/Client	The Holli McCray Group			

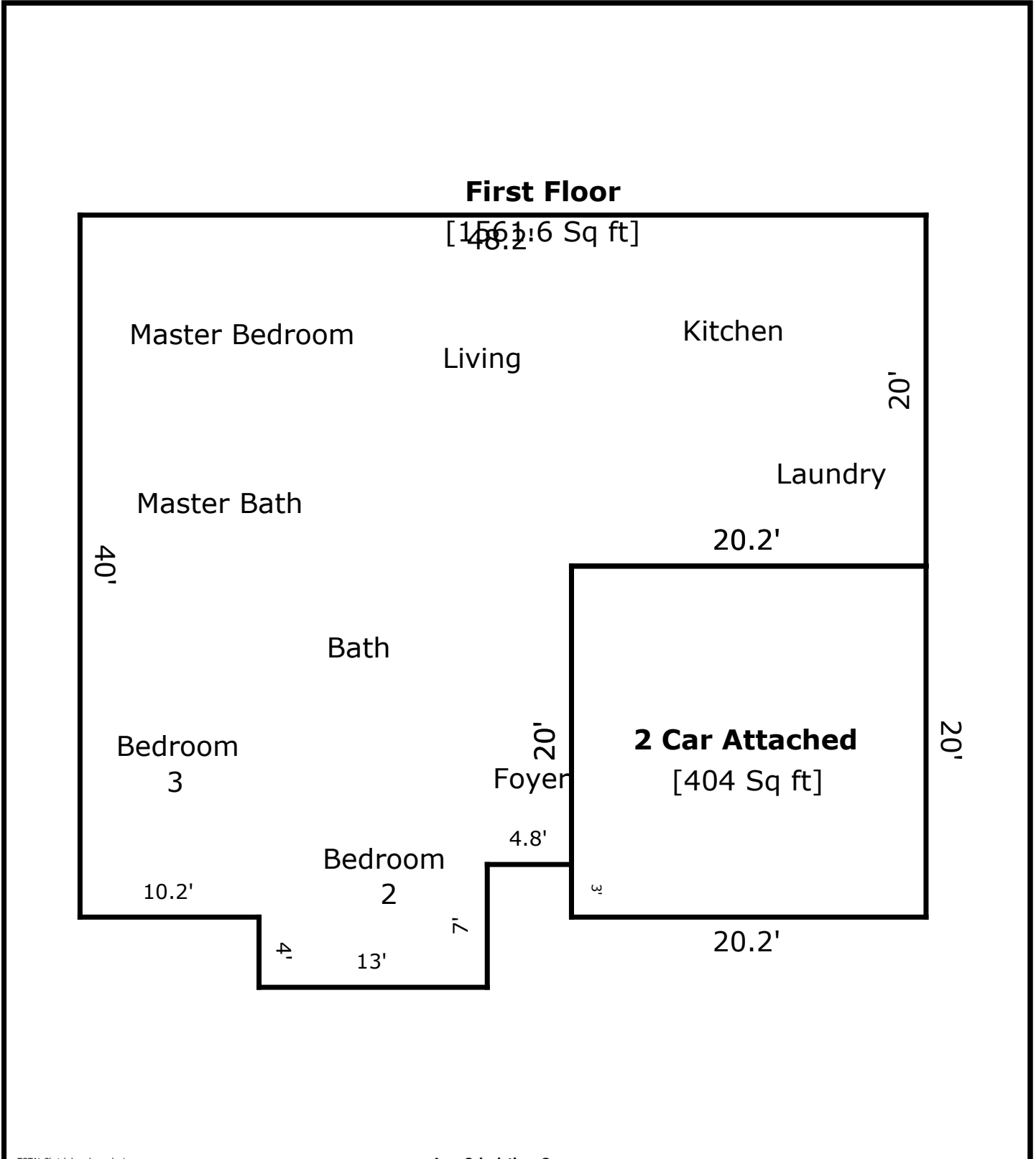

TOTAL Sketch by a la mode, inc.

Area Calculations Summary

Living Area	Calculation Details	
First Floor	1561.6 Sq ft	$20 \times 20.2 = 404$ $28 \times 37 = 1036$ $7 \times 13 = 91$ $10.2 \times 3 = 30.6$
Total Living Area (Rounded):	1562 Sq ft	
Non-living Area		
2 Car Attached	404 Sq ft	$20.2 \times 20 = 404$