

# INVOICE

**FROM:**

Advanced Appraisal Services  
 Advanced Appraisal Services  
 PO Box 11373  
 Knoxville, TN 37939-1373

Telephone Number: (865) 588-4008 Fax Number: (865) 637-2394

**TO:**

Holly Patterson

**E-Mail:**

Telephone Number: (865) 898-8001 Fax Number:  
 Alternate Number:

**INVOICE NUMBER**

0045922

**DATES**

Invoice Date: 10/11/2019  
 Due Date: 10/11/2019

**REFERENCE**

Internal Order #: 0045922  
 Lender Case #:  
 Client File #:  
 FHA/VA Case #:  
 Main File # on form: 0045922  
 Other File # on form: 0045922  
 Federal Tax ID: 62-1867763  
 Employer ID:

**DESCRIPTION**

Lender: Client: Holly Patterson  
 Purchaser/Borrower:  
 Property Address: 4817 Chase Hill Dr  
 City: Knoxville  
 County: Knox State: TN Zip: 37918  
 Legal Description: Block B Lot 28 Cedarchase Unit 1

**FEES**

**AMOUNT**

Measurement	75.00
<b>SUBTOTAL</b>	
	75.00

**PAYMENTS**

**AMOUNT**

Check #:	Date:	Description:	
Check #:	Date:	Description:	
Check #:	Date:	Description:	
<b>SUBTOTAL</b>			0
<b>TOTAL DUE</b>			<b>\$ 75.00</b>

### Building Sketch

Borrower				
Property Address 4817 Chase Hill Dr				
City	Knoxville	County	Knox	State TN Zip Code 37918
Lender/Client				

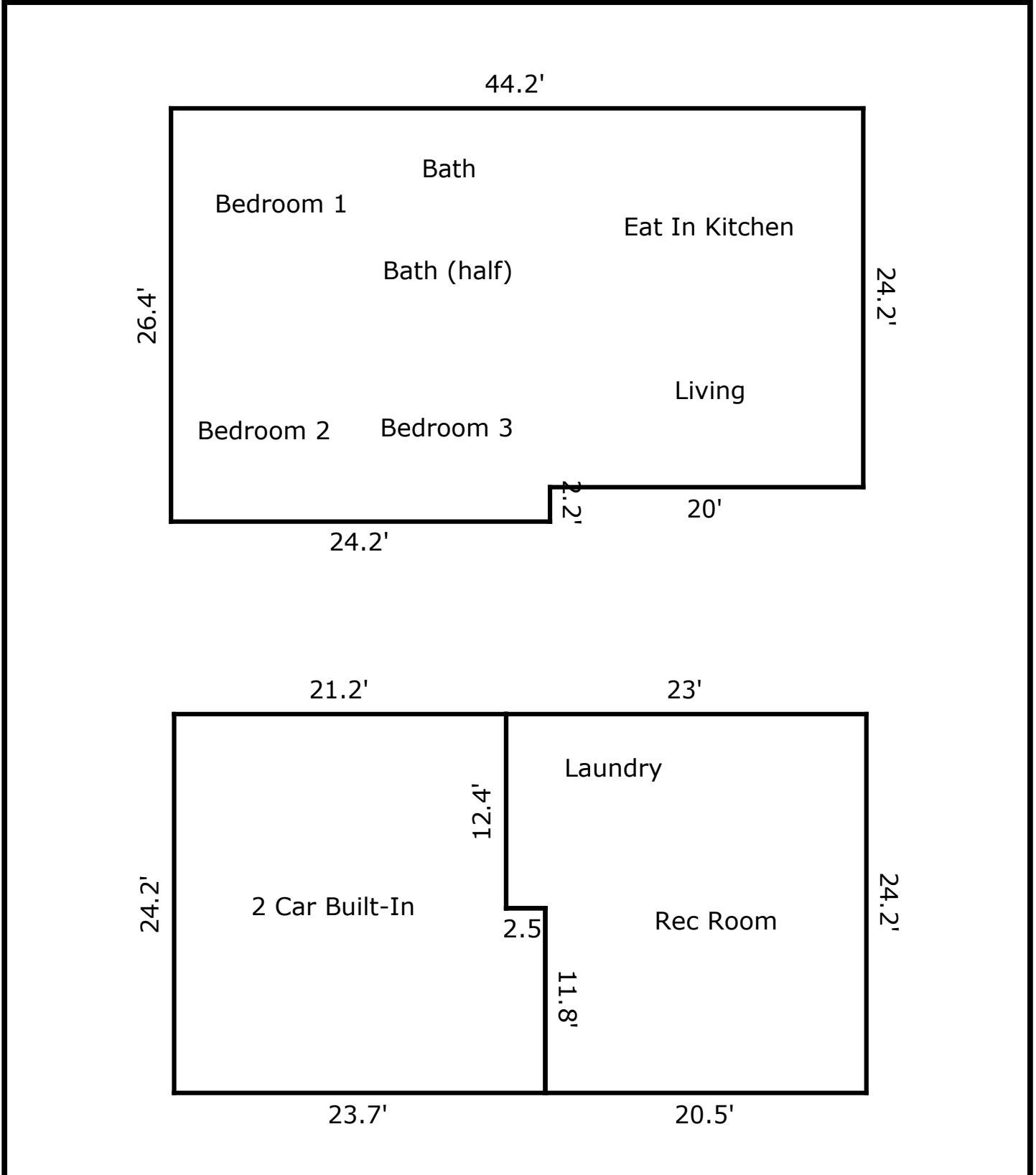

TOTAL Sketch by a la mode, inc.

#### Area Calculations Summary

Living Area		Calculation Details
First Floor	1122.88 Sq ft	26.4 × 24.2 = 638.88 20 × 24.2 = 484
<b>Total Living Area (Rounded):</b>	<b>1123 Sq ft</b>	
Non-living Area		Calculation Details
Finished Basement	527.1 Sq ft	24.2 × 20.5 = 496.1 2.5 × 12.4 = 31
2 Car Built-In	542.54 Sq ft	24.2 × 21.2 = 513.04 11.8 × 2.5 = 29.5

**Subject Photo Page**

Borrower					
Property Address 4817 Chase Hill Dr					
City	Knoxville	County	Knox	State	TN Zip Code 37918
Lender/Client					



**Subject Front**



**Subject Rear**



**Subject Street**

**Supplemental Addendum**

File No. 0045922

Borrower					
Property Address 4817 Chase Hill Dr					
City Knoxville		County Knox		State TN	Zip Code 37918
Lender/Client					

**Measurements for 4817 Chase Hill Blvd****1st Floor - 1,123 sf****Finished Basement - 527sf****Dimensions****Main Level****Living - 13.5 x 12.5****Eat In Kitchen - 19.5 x 10.5****Half Bath - 5 x 5****Bath - 8 x 5****Bedroom 1 - 15 x 10.5****Bedroom 2 - 10 x 10.5****Bedroom 3 - 11 x 10.5****Basement****Rec Room- 22.5 x 12.5****Laundry - 10.5 x 5**

The above measurements are completed according to appraisal industry standards.