

Subject Photo Page

Borrower	The Holli McCray Group						
Property Address	131 Inata Cir						
City	Loudon	County	Loudon	State	TN	Zip Code	37932
Lender/Client	The Holli McCray Group						



Subject Front

131 Inata Cir
Sales Price
Gross Living Area
Total Rooms
Total Bedrooms
Total Bathrooms
Location
View
Site
Quality
Age



Subject Rear

Subject Street

Supplemental Addendum

File No. 0045988

Borrower	The Holli McCray Group						
Property Address	131 Inata Cir						
City	Loudon	County	Loudon	State	TN	Zip Code	37932
Lender/Client	The Holli McCray Group						

131 Inata Cir- 2467 sq ft

1st Level- 2467 sq ft

- Office 15 x 14**
- Dining 15 x 10**
- Kitchen 15 x 10**
- Living 23 x 17**
- Sun Room 16 x 10**
- Laundry 9 x 6**
- Bed 2 13 x 12**
- Bed 3 13 x 12**
- Bath 10 x 5**
- Master Bed 16 x 16**
- Master Bath 15 x 6**

Partially Finished Basement- 1019 sq ft

Bath 8 x 5

Signature _____
Name Jeremy Skalet
Date Signed _____
State Certification # 3215 State TN
Or State License # _____ State _____

Signature _____
Name _____
Date Signed _____
State Certification # _____ State _____
Or State License # _____ State _____

Building Sketch

Borrower	The Holli McCray Group						
Property Address	131 Inata Cir						
City	Loudon	County	Loudon	State	TN	Zip Code	37932
Lender/Client	The Holli McCray Group						

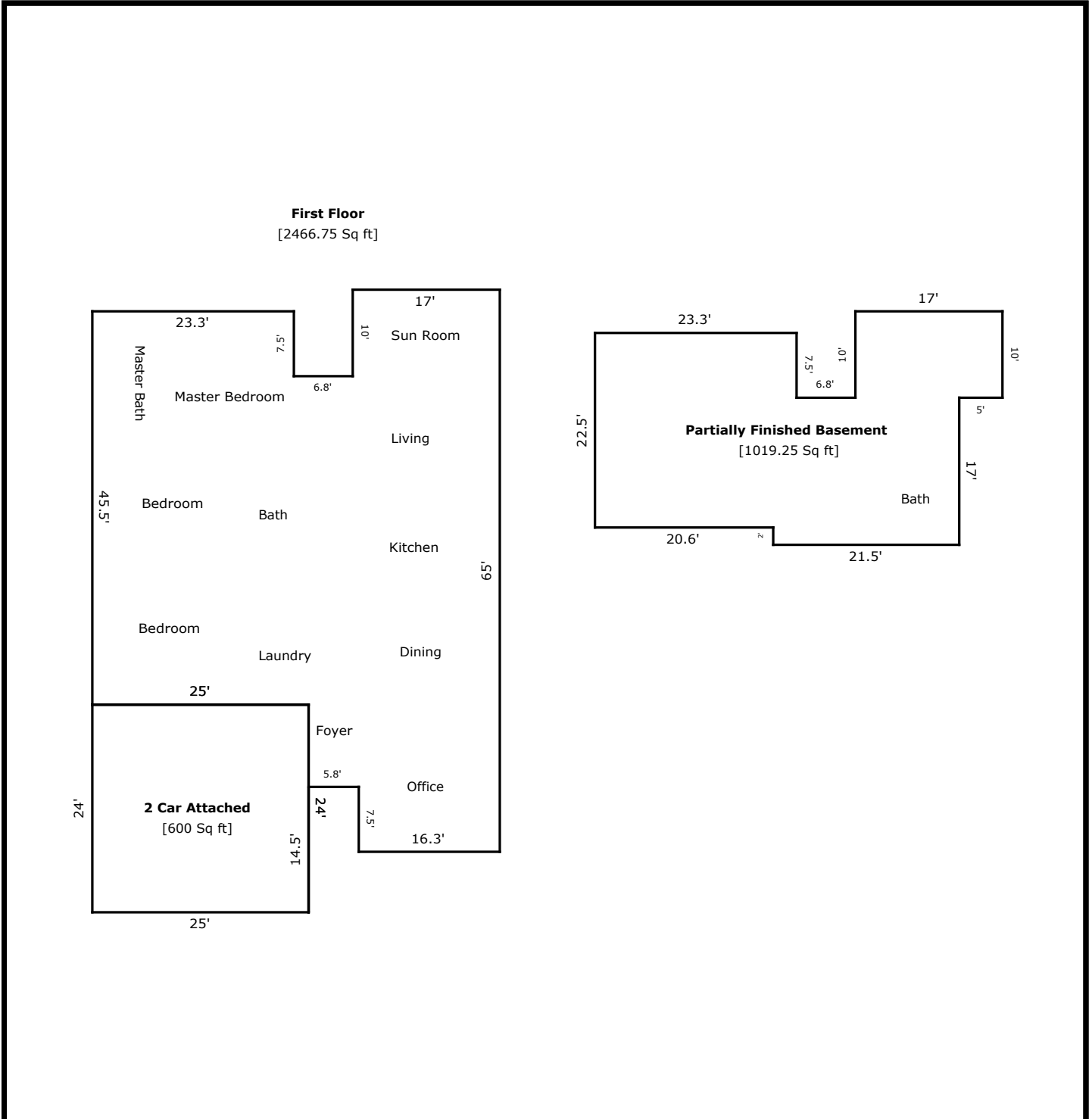

TOTAL Sketch by a la mode, inc.

Area Calculations Summary

Living Area	Calculation Details	
First Floor	2466.75 Sq ft	$17 \times 10 = 170$ $45.5 \times 23.3 = 1060.15$ $23.8 \times 38 = 904.4$ $17 \times 16.3 = 277.1$ $9.5 \times 5.8 = 55.1$
Total Living Area (Rounded):	2467 Sq ft	
Non-living Area		
Partially Finished Basement	1019.25 Sq ft	$17 \times 10 = 170$ $22.5 \times 20.6 = 463.5$ $17 \times 18.8 = 319.6$ $2.7 \times 24.5 = 66.15$
2 Car Attached	600 Sq ft	$24 \times 25 = 600$