

INVOICE

FROM:

Advanced Appraisal Services
 Advanced Appraisal Services
 PO Box 11373
 Knoxville, TN 37939-1373

Telephone Number: (865) 588-4008 Fax Number: (865) 637-2394

TO:

The Holli McCray Group

Knoxville, TN

E-Mail: verdeaux@kw.com

Telephone Number: (865) 851-0181 Fax Number:

Alternate Number:

INVOICE NUMBER

0045341

DATES

Invoice Date: 09/27/2019

Due Date: 09/27/2019

REFERENCE

Internal Order #: 0045341

Lender Case #:

Client File #:

FHA/VA Case #:

Main File # on form: 0045341

Other File # on form: 0045341

Federal Tax ID: 62-1867763

Employer ID:

DESCRIPTION

Lender: The Holli McCray Group	Client: The Holli McCray Group
Purchaser/Borrower: The Holli McCray Group	
Property Address: 167 Trades	
City: Lenoir City	
County: Loudon	State: TN Zip: 37932
Legal Description: Lot Pt19 Harrison Hills	

FEES

AMOUNT

Measurement interior	75.00 0.00
SUBTOTAL	75.00

PAYMENTS

AMOUNT

Check #:	Date:	Description:	
Check #:	Date:	Description:	
Check #:	Date:	Description:	
SUBTOTAL			0
TOTAL DUE			\$ 75.00

Supplemental Addendum

File No. 0045341

Borrower	The Holli McCray Group		
Property Address	167 Trades		
City	Lenoir City	County	Loudon
		State	TN
		Zip Code	37932
Lender/Client	The Holli McCray Group		

167 Trades- 2306 sq ft

1st Level- 1594 sq ft

- Laundry 10 x 7**
- Kitchen 13 x 12**
- Living 24 x 13**
- Dining 15 x 13**
- Bath 8 x 5**
- Bed 2 13 x 10**
- Bed 3 13 x 10**
- Master Bed 13 x 10**
- Master Bath 8 x 7**

Basement- 712 sq ft

Family 25 x 21

Signature _____
 Name Jeremy Skalet
 Date Signed _____
 State Certification # 3215 State TN
 Or State License # _____ State _____

Signature _____
 Name _____
 Date Signed _____
 State Certification # _____ State _____
 Or State License # _____ State _____

Subject Photo Page

Borrower	The Holli McCray Group				
Property Address	167 Trades				
City	Lenoir City	County	Loudon	State	TN Zip Code 37932
Lender/Client	The Holli McCray Group				



Subject Front

167 Trades

Subject Rear

Subject Street

Building Sketch

Borrower	The Holli McCray Group						
Property Address	167 Trades						
City	Lenoir City	County	Loudon	State	TN	Zip Code	37932
Lender/Client	The Holli McCray Group						

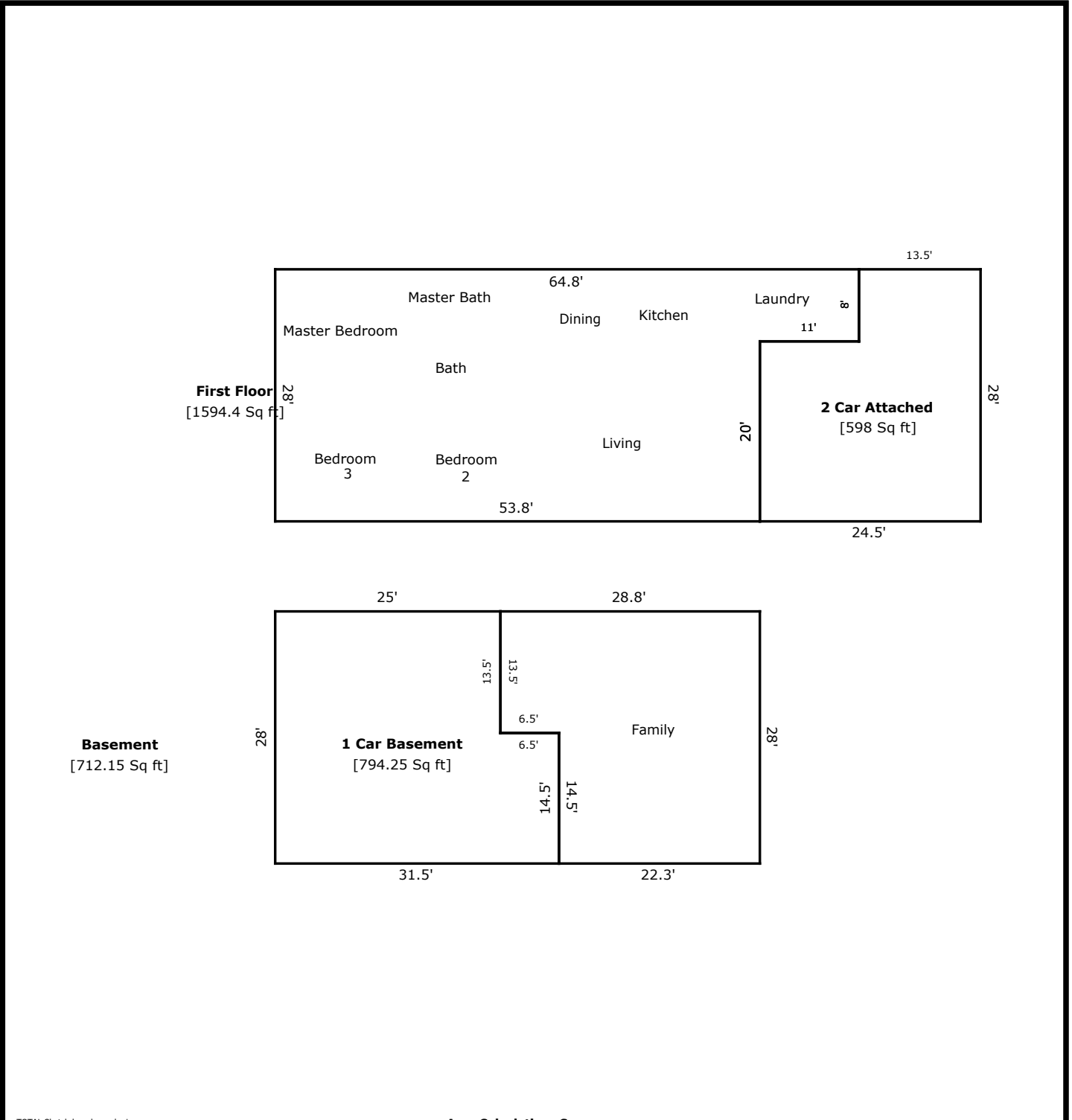

TOTAL Sketch by a la mode, inc.

Area Calculations Summary

Living Area		Calculation Details	
First Floor	1594.4 Sq ft	$8 \times 11 = 88$	$53.8 \times 28 = 1506.4$
Basement	712.15 Sq ft	$28 \times 22.3 = 624.4$	$13.5 \times 6.5 = 87.75$
Total Living Area (Rounded):	2307 Sq ft		
Non-living Area			
1 Car Basement	794.25 Sq ft	$28 \times 25 = 700$	$6.5 \times 14.5 = 94.25$
2 Car Attached	598 Sq ft	$24.5 \times 20 = 490$	$8 \times 13.5 = 108$